

THIS DRAWING IS UNPUBLISHED. RELEASED FOR PUBLICATION
 © COPYRIGHT BY TYCO ELECTRONICS CORPORATION. ALL RIGHTS RESERVED.

LOC		DIST		REVISIONS			
P	LTR	DESCRIPTION	DATE	DWN	APVD		
-	-						

NOTES:
 1. WIRE RANGE
 CONDUCTOR: 0.4mm² - 1.0mm²
 INSULATION DIA: 3.2mm MAX.

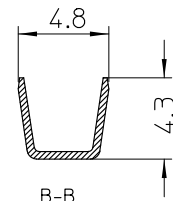
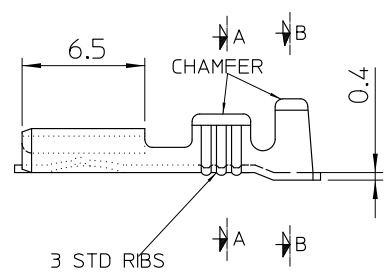
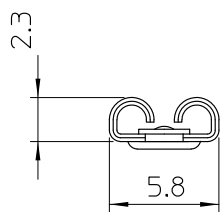
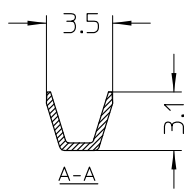
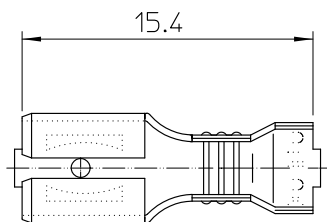

BRASS PRE-TIN	RECEPTACLE H2590ET	1-1627099-3
NICKEL SILVER	RECEPTACLE H2590B	1-1627099-2
BRASS	RECEPTACLE H2590	1-1627099-0
MATERIAL No.	DESCRIPTION	PART No.

THIS INFORMATION IS CONFIDENTIAL AND PROPRIETARY TO TYCO ELECTRONICS CORPORATION AND IS NOT TO BE RELEASED TO ANYONE OTHER THAN TYCO ELECTRONICS CORPORATION, HARRISBURG, PENNSYLVANIA, USA.

THIS DRAWING IS A CONTROLLED DOCUMENT.	
ALL DIMENSIONS IN mm	TOLERANCES UNLESS OTHERWISE SPECIFIED:
	DIMENSION (mm) TOLERANCE (+/-mm)
	LESS THAN 10 0.4
	OVER 10 TO 30 0.5
	OVER 30 TO 80 0.7
	OVER 80 TO 250 1.0
	ANGLES 42°
MATERIAL	FINISH
-	-

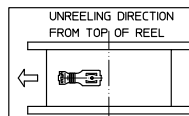

DWN: W.Riede 21.10.04	Tyco Electronics Corporation AUSTRALIA
CHK: H. Tihai 21.10.04	
APVD: W.Riede 21.10.04	NAME: RECEPTACLE, QC 4.8x0.5
PRODUCT SPEC: -	SIZE: A3
APPLICATION SPEC: -	CAGE CODE: -
WEIGHT: -	DRAWING NO: 1627099
CUSTOMER DRAWING	
SCALE: 5:1	SHEET 1 OF 1
	REV 0