

07

NUMBER
41829

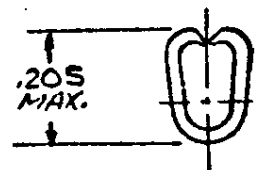

SECT. A-A

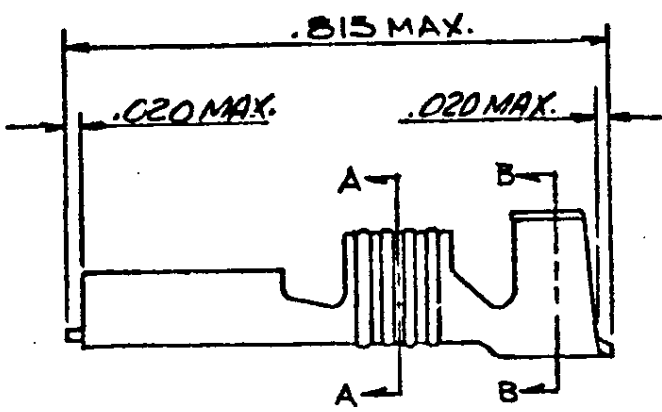
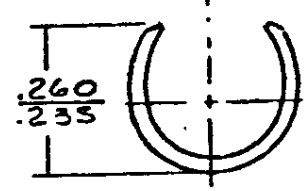

SECT. B-B

NOTE
1-SEE PART NO. 41450 FOR
ADDITIONAL INFORMATION.

WIRE SIZE A.W.G.	INSULATION RANGE	TAB THK. ±.001	MATERIAL AND FINISH	COMBINATION NUMBER	TAPE MOUNTED
14-12	.160 MAX.	.032	.018-BRASS-TIN	*41829(41450L.P.)	41829-2
14-12	.160 MAX.	"	.018-BRASS-TIN	*41829-1(41450L.P.)	---
14-12	.160 MAX.	"	.018-BRASS	41858(41449L.P.)	---

* FOREIGN PRODUCTION ONLY

This terminal to be supplied
in individual form, not as
continuous strip.
S-26 - PRODUCT ENGINEERING

DIMENSIONS IN INCHES DO NOT SCALE PRINT.

				CUSTOMER COPY REFERENCE ONLY			
				MATERIAL AND FINISH		TE TE Connectivity	
				WIRE RANGE - INSULATION		CLASS	
				TOLERANCE EXCEPT AS NOTED		TYPE	
				SCALE		LOG	
				NAME		NO	
				APP		REV	
				DATE		E1	
				DATE		41829	
				250 SERIES FASTON RECEPTACLE			

E1 REVISED PER ECO-11-005294 RK HMR 11 APR 11
 LTR REVISION RECORD DR CHK DATE
 E1 SWINGWAVE 5/17/65
 DE FRANK 5/17/65
 APP 5/17/65