

4

3

2

1

THIS DRAWING IS UNPUBLISHED. BY RELEASED FOR PUBLICATION 20
 (C) COPYRIGHT ALL RIGHTS RESERVED.

LOC	DISP	REV	DESCRIPTION	DATE	BY	CHKD
FT	0					
		1	REVISED PER ECO-11-00524	30APR11	RK	HMR

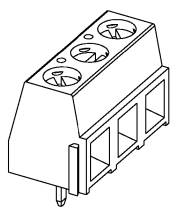
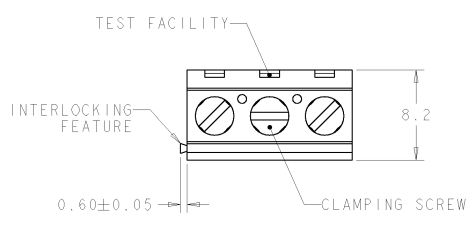

1546216-3 AS SHOWN

- △ MATERIALS AND FINISH
 HOUSING: PA 6-6, UL 94-V0, COLOR GRAY.
 CLAMP: BRASS, NICKEL PLATED.
 TERMINAL: BRASS, TIN PLATED.
 CLAMPING SCREW: M3, BRASS, NICKEL PLATED.
- SUITABLE FOR 1.6-2.4mm PCB BOARD THICKNESS.
 - END-TO-END STACKABLE W/INTERLOCK WITHOUT LOSS OF CENTERLINE SPACING.
 - WIRE SIZE RANGE: 15-17 AWG.
 - RECOGNIZED UNDER THE COMPONENT PROGRAM OF UNDERWRITERS LABORATORIES INC., FILE N° E60677.
 - IMQ CERTIFICATE WITH SURVEILLANCE IN CONFORMITY WITH IEC 998-1/998-2-1.
- △ NOT CUMULATIVE TOLERANCE.

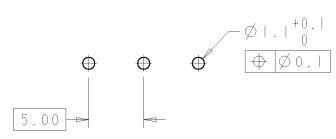
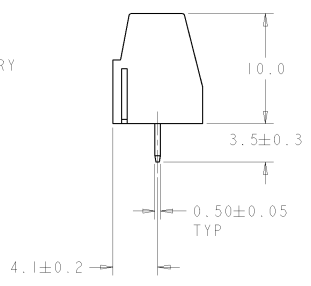
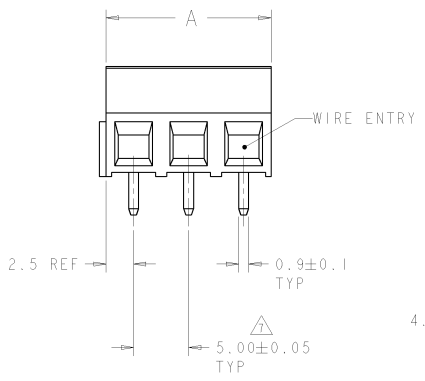

RECOMMENDED PC BOARD LAYOUT

125.0	25	2-1546216-5
120.0	24	2-1546216-4
115.0	23	2-1546216-3
110.0	22	2-1546216-2
105.0	21	2-1546216-1
100.0	20	2-1546216-0
95.0	19	1-1546216-9
90.0	18	1-1546216-8
85.0	17	1-1546216-7
80.0	16	1-1546216-6
75.0	15	1-1546216-5
70.0	14	1-1546216-4
65.0	13	1-1546216-3
60.0	12	1-1546216-2
55.0	11	1-1546216-1
50.0	10	1-1546216-0
45.0	9	1546216-9
40.0	8	1546216-8
35.0	7	1546216-7
30.0	6	1546216-6
25.0	5	1546216-5
20.0	4	1546216-4
15.0	3	1546216-3
10.0	2	1546216-2
A	NO OF POSN	PART NUMBER

DIMENSIONS: mm		DRN: S. WELDON 27FEB2004	 TE Connectivity	TERMINAL BLOCK, PCB MOUNT SIDE ENTRY WIRE, STACKING W/INTERLOCK, 5.00mm PITCH
0 PLC #1 1 PLC #3 2 PLC #25 3 PLC #1 4 PLC #2 ANGLES #2		CHN: C. RICHARD 27FEB2004 APP: C. RICHARD 27FEB2004 PRODUCT SPEC: 108-20166 APPLICATION SPEC: 114-20079 WEIGHT: - FINISH: -		
MATERIAL: △ -		CUSTOMER DRAWING		RESTRICTED TO: - SCALE: 4:1 SHEET: 1 OF 1 REV: A1