

REV	DATE	REVISIONS	BY	CHK	APP
CM	00				
		REVISED PER EC 0038-0300-00			

- PARTS COMPLY TO AMP SOLDERABILITY SPECIFICATION 109-11-3.
- CIRCUIT IDENTIFICATION CHARACTERS ARE ADJACENT TO THE INDICATED CAVITIES, BUT LOCATION AND ORIENTATION MAY DIFFER FROM PRINT.
- DIMENSIONS IN BRACKETS ARE IN INCHES.
- △ DRAIN HOLES LOCATED AS SHOWN, OPTIONAL CONSTRUCTION- ALL DRAIN HOLES LOCATED 90° AS SHOWN IN DETAIL A.

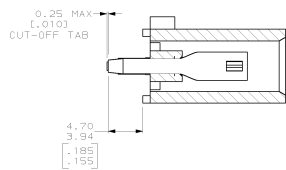

DETAIL A  
 OPTIONAL CONSTRUCTION

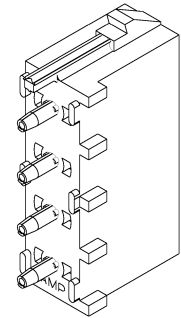
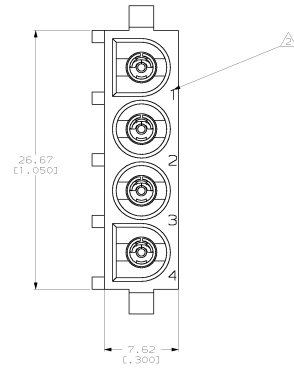
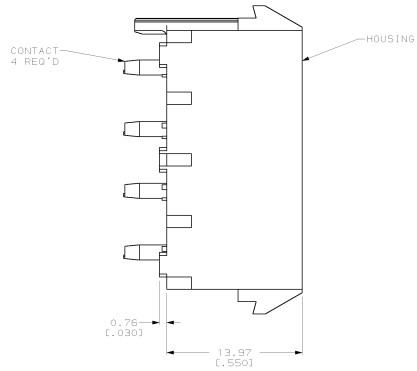
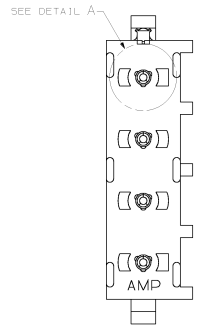
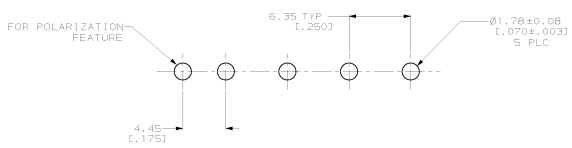

RECOMMENDED MOUNTING HOLE PATTERN  
 FOR 1.57 (1.052) THICK P.C. BOARD

PHOSPHOR BRONZE, PRE-TIN	NYLON, UL94V-2, NATURAL	643415-1
P-IN CONTACT MATERIAL AND FINISH		HOUSING MATERIAL
		PART NO

THIS DRAWING IS A CONTROLLED DOCUMENT.		REV	DATE	BY	CHK	APP
REV	DATE	BY	CHK	APP		
1	07/01/2000	CM				
2	07/20/2000	CM				
3	07/20/2000	CM				
4	07/20/2000	CM				
5	07/20/2000	CM				
6	07/20/2000	CM				
7	07/20/2000	CM				
8	07/20/2000	CM				
9	07/20/2000	CM				
10	07/20/2000	CM				
11	07/20/2000	CM				
12	07/20/2000	CM				
13	07/20/2000	CM				
14	07/20/2000	CM				
15	07/20/2000	CM				
16	07/20/2000	CM				
17	07/20/2000	CM				
18	07/20/2000	CM				
19	07/20/2000	CM				
20	07/20/2000	CM				
21	07/20/2000	CM				
22	07/20/2000	CM				
23	07/20/2000	CM				
24	07/20/2000	CM				
25	07/20/2000	CM				
26	07/20/2000	CM				
27	07/20/2000	CM				
28	07/20/2000	CM				
29	07/20/2000	CM				
30	07/20/2000	CM				
31	07/20/2000	CM				
32	07/20/2000	CM				
33	07/20/2000	CM				
34	07/20/2000	CM				
35	07/20/2000	CM				
36	07/20/2000	CM				
37	07/20/2000	CM				
38	07/20/2000	CM				
39	07/20/2000	CM				
40	07/20/2000	CM				
41	07/20/2000	CM				
42	07/20/2000	CM				
43	07/20/2000	CM				
44	07/20/2000	CM				
45	07/20/2000	CM				
46	07/20/2000	CM				
47	07/20/2000	CM				
48	07/20/2000	CM				
49	07/20/2000	CM				
50	07/20/2000	CM				
51	07/20/2000	CM				
52	07/20/2000	CM				
53	07/20/2000	CM				
54	07/20/2000	CM				
55	07/20/2000	CM				
56	07/20/2000	CM				
57	07/20/2000	CM				
58	07/20/2000	CM				
59	07/20/2000	CM				
60	07/20/2000	CM				
61	07/20/2000	CM				
62	07/20/2000	CM				
63	07/20/2000	CM				
64	07/20/2000	CM				
65	07/20/2000	CM				
66	07/20/2000	CM				
67	07/20/2000	CM				
68	07/20/2000	CM				
69	07/20/2000	CM				
70	07/20/2000	CM				
71	07/20/2000	CM				
72	07/20/2000	CM				
73	07/20/2000	CM				
74	07/20/2000	CM				
75	07/20/2000	CM				
76	07/20/2000	CM				
77	07/20/2000	CM				
78	07/20/2000	CM				
79	07/20/2000	CM				
80	07/20/2000	CM				
81	07/20/2000	CM				
82	07/20/2000	CM				
83	07/20/2000	CM				
84	07/20/2000	CM				
85	07/20/2000	CM				
86	07/20/2000	CM				
87	07/20/2000	CM				
88	07/20/2000	CM				
89	07/20/2000	CM				
90	07/20/2000	CM				
91	07/20/2000	CM				
92	07/20/2000	CM				
93	07/20/2000	CM				
94	07/20/2000	CM				
95	07/20/2000	CM				
96	07/20/2000	CM				
97	07/20/2000	CM				
98	07/20/2000	CM				
99	07/20/2000	CM				
100	07/20/2000	CM				

