

DRAWING MADE IN THIRD ANGLE PROJECTION

THIS DRAWING IS UNPUBLISHED. RELEASED FOR PUBLICATION, 19
 © COPYRIGHT 19 BY AMP INCORPORATED. ALL INTERNATIONAL RIGHTS RESERVED.

LOC	DIST	REVISIONS				DATE	APPD
CM	53	P	F	ZONE	LTR	DESCRIPTION	
						C REV & REDRAWN PER ECN CM-11	1-20-93
							KS RS

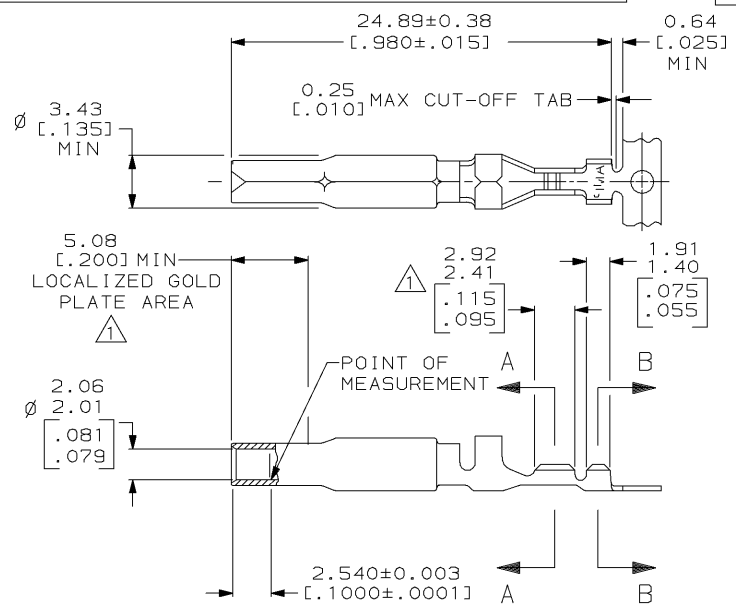

- 0.00076 [0.000030] MIN GOLD AT POINT OF MEASUREMENT IN THE LOCALIZED GOLD PLATE AREA AND ON INSIDE OF WIRE BARREL; 0.00127 [0.000050] MIN NICKEL UNDERPLATE ON ENTIRE CONTACT.
- WIRE RANGE: 0.05-0.15mm² [30-26] AWG. INSULATION RANGE: 0.81-1.45 [0.032-.057] DIA.
- DIMENSIONS IN BRACKETS ARE IN INCHES.

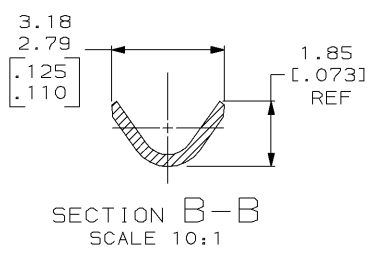
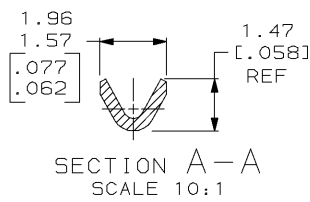

METRIC

GOLD Δ		0.30 [0.012] PH BRZ	770012-6
FINISH		MATERIAL	PART NO
DO NOT SCALE PRINT. UNLESS SPECIFIED DIMENSIONS IN MM (INCHES) TOLERANCES ON: 2 PLC DEC ± 3 PLC DEC ± ANGLES ±		DR 4-1-93 K. SALMON CHK 4-1-93 R. SWING APPD 4-1-93 M. TRULL M. TRULL PRODUCT SPEC	AMP AMP INCORPORATED Harrisburg, Pa. 17105
MATERIAL SEE TABLE		NAME	SOCKET, UNIVERSAL MATE-N-LOK™ II
FINISH SEE TABLE		SIZE	B
		FSCM NO	00779
		DRAWING NO	770012
		SCALE	4:1
		SHEET	1 OF 1

AMP 1470-15 REV 3-87
 20 JAN 1993 14:07:46 AMP23993 <CE079B>DEPT3323>AMP23993>U.WR92-239

CUSTOMER DRAWING