

REVOLUTIONS				DATE	APPROV
CM	53	#	F	REV PER EC 0730-0211-95	2-20-95

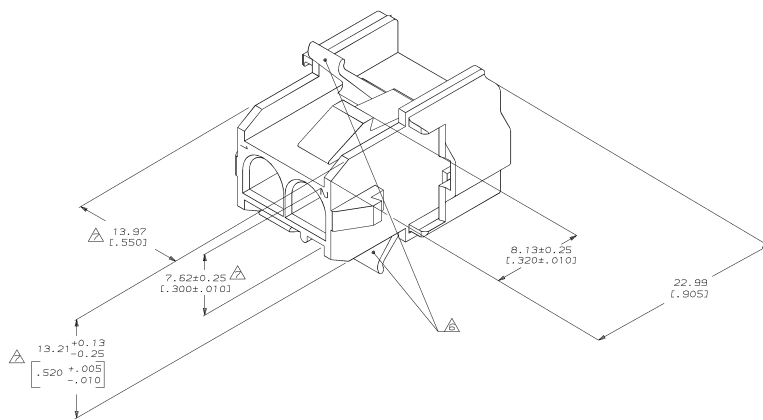

1. MUST BE ASSEMBLED WITH CAP REAR P/N 770046-1 BEFORE MATING. KIT P/N IS 770024-1.
- △ RECOMMENDED PANEL THICKNESS 0.76-2.29 (.030-.090).
 - △ PANEL MUST BE PUNCHED SO THAT THE HOUSING ENTERS THE PANEL IN THE SAME DIRECTION AS THE PUNCH.
 - △ OPTIONAL FOR KEYING HOUSING IN PANEL.
 - △ CIRCUIT NUMBER 1 LOCATION.
 - △ AMP LOGO LOCATED ONCE ON ANY INDICATED SURFACE FAR SIDE.
 - △ DIMENSION INDICATED IS AS MOLDED. ADDITIONAL GROWTH DUE TO SUBSEQUENT MOISTURE ABSORPTION MAY OCCUR.

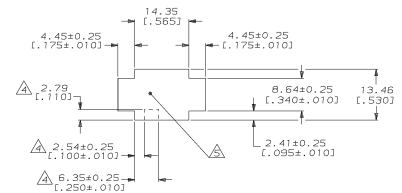

RECOMMENDED PANEL CUTOUT
(HOUSING ENTRY SIDE)
SCALE 2:1

770045-1
PART NUMBER

METRIC

PART NO			
DO NOT SCALE PRINT. UNLESS SPECIFIED DIMENSIONS IN INCHES TOLERANCES ON: 1 PLE DEC # 0.13 (.005) 2 PLE DEC # 0.13 (.005) 3 PLE DEC # 0.13 (.005) ANGLES # 0.13 (.005)		AMP INCORPORATED Merrimack, N.H. 03003	
DR 1-15-92 K. SAKON	CHK 1-15-92 K. SAKON	NAME	
APPD 1-16-92 H. TROLL	APPD 1-16-92 H. TROLL	CAP FRONT, 2 CIRCUIT, UNIVERSAL MATE-N-LOK™ II	
FINISH	APPLICATION SPEC	SIZE D	FSOR NO 00773
WEIGHT		SCALE 5:1	DRAWING NO 770045
		SHEET 1 OF 1	

CUSTOMER DRAWING