

REV	DATE	DESCRIPTION	BY	CHK	APP
00					
1		REVISED PER QCS-1100-04	08/08	PA	DR

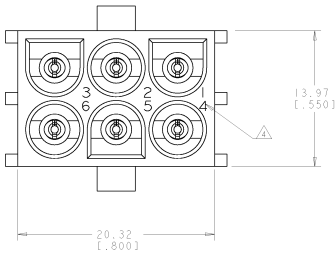

- PARTS COMPLY TO AMP SOLDERABILITY SPECIFICATION 109-11-3.
- CONTACT IS PLATED OVERALL WITH 0.00127 [0.00050] NICKEL, THEN 0.00076 [0.00030] GOLD OVER CONTACT LENGTH INDICATED AND TIN LEAD ON SOLDER TAIL END.
- PARTS MATE WITH HOUSING 350715.
- CIRCUIT IDENTIFICATION CHARACTERS ARE ADJACENT TO THE INDICATED CAVITIES, BUT LOCATION AND ORIENTATION MAY DIFFER FROM PRINT.
- CONTACT IS PLATED OVERALL WITH 0.00127 [0.00050] NICKEL, THEN 0.00076 [0.00030] GOLD OVER CONTACT LENGTH INDICATED AND MATTE TIN ON SOLDER TAIL END.
- DIMENSIONS IN BRACKETS ARE IN INCHES.

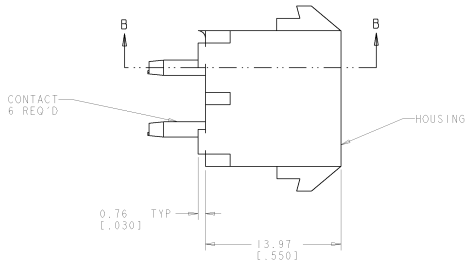
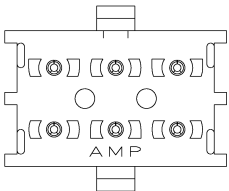
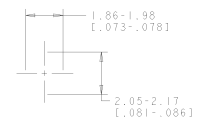
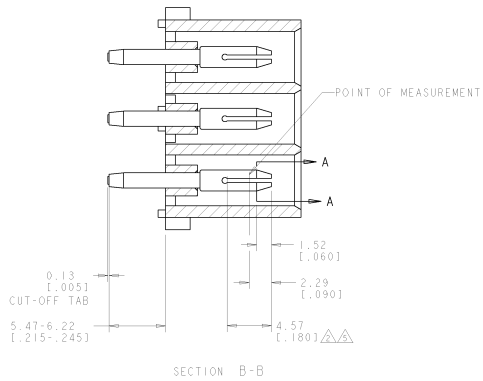

SECTION A-A
SCALE 10:1

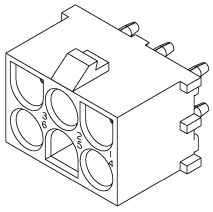

3-DIMENSIONAL MODEL
SCALE 4:1

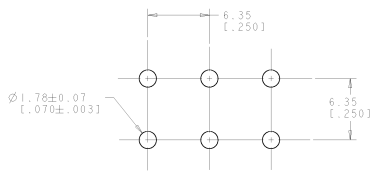

RECOMMENDED MOUNTING HOLE PATTERN
FOR 1.57 [0.062] THICK P.C. BOARD

PHOSPOR BRONZE, GOLD	NYLON, UL94V-0, NATURAL	350732-4
PHOSPOR BRONZE, GOLD	NYLON, UL94V-0, NATURAL	350732-2
PHOSPOR BRONZE, PRE-TIN	NYLON, UL94V-0, NATURAL	350732-1
PIN CONTACT MATERIAL AND FINISH	HOUSING MATERIAL AND COLOR	PART NUMBER



PART NUMBER: [REDACTED] QUANTITY: [REDACTED] DATE: [REDACTED] DRAWN BY: [REDACTED] CHECKED BY: [REDACTED] APPROVED BY: [REDACTED]	REV: ASSISTANCE [REDACTED] REV: DESIGN [REDACTED] REV: DRAWING [REDACTED] REV: [REDACTED] REV: [REDACTED] REV: [REDACTED]	Title: ELECTRONICS Manufacturing, PA 19103-1808 Alcoa PIN HEADER ASSEMBLY, 6 CIRCUIT, LONG TAIL, UNIVERSAL MATE-N-LON(TM)	PART NUMBER: [REDACTED] REV: [REDACTED] DATE: [REDACTED] DRAWN BY: [REDACTED] CHECKED BY: [REDACTED] APPROVED BY: [REDACTED]
--------------------------------------------------------------------------------------------------------------------------------------------------	------------------------------------------------------------------------------------------------------------------------------------------	-------------------------------------------------------------------------------------------------------------------------------------------------	---------------------------------------------------------------------------------------------------------------------------------------------