

THIS DRAWING IS UNPUBLISHED. ALL RIGHTS RESERVED.
 © 2008 BY TYS ELECTRONICS CORPORATION

REV	DATE	DESCRIPTION	BY	APP'D
CM 5.3				
G		REVISED FOR ECO-08-020886	19MMP08	HMR CC

1 PARTS COMPLY WITH AMP SOLDERABILITY SPEC. 109-11-3.
 MATERIAL: HOUSING - NYLON,UL94V-2,NATURAL
 PIN - COPPER ALLOY,BRIGHT TIN-LEAD
 PLATED,0.0020 [.000080] MIN.THK.

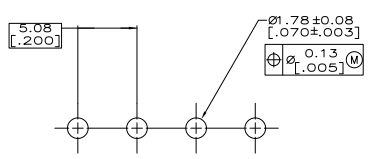
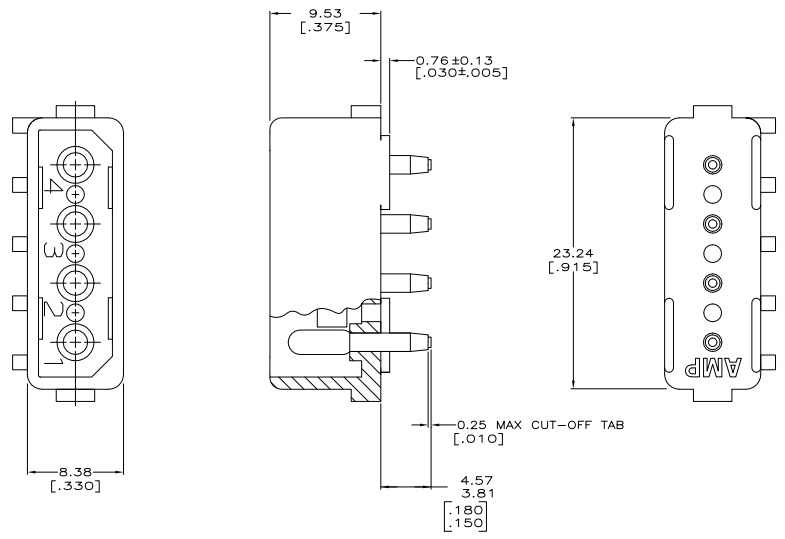

RECOMMENDED MOUNTING HOLE PATTERN
 FOR 1.57 [.062] THICK P.C. BOARD

4	770328-1
NO. OF POSITIONS	PART NUMBER
HEADER ASSEMBLY	

THIS DRAWING IS A CONTROLLED DOCUMENT.		DATE: 7-7-88	BY: BLANKEN	BY: TYS Electronics	TYS Electronics Corporation
INCHES	UNLESS OTHERWISE SPECIFIED	DATE: 7-13-87	BY: SENG	DATE: 7-13-87	Harrisburg, PA 17105-3608
1/16"	0.0005"	DATE: 7-13-87	BY: BROWN	DATE: 7-13-87	HEADER ASSY, 4 CKT,
1/32"	0.0010"	DATE: 7-13-87	BY: PFE	DATE: 7-13-87	COMMERCIAL MATE-N-LOK™
1/64"	0.0020"	DATE: 7-13-87	BY: [unclear]	DATE: 7-13-87	
1/32"	0.0040"	DATE: 7-13-87	BY: [unclear]	DATE: 7-13-87	
1/16"	0.0080"	DATE: 7-13-87	BY: [unclear]	DATE: 7-13-87	
1/8"	0.0160"	DATE: 7-13-87	BY: [unclear]	DATE: 7-13-87	
3/16"	0.03125"	DATE: 7-13-87	BY: [unclear]	DATE: 7-13-87	
1/4"	0.0625"	DATE: 7-13-87	BY: [unclear]	DATE: 7-13-87	
3/8"	0.125"	DATE: 7-13-87	BY: [unclear]	DATE: 7-13-87	
1/2"	0.25"	DATE: 7-13-87	BY: [unclear]	DATE: 7-13-87	
3/4"	0.375"	DATE: 7-13-87	BY: [unclear]	DATE: 7-13-87	
1"	0.75"	DATE: 7-13-87	BY: [unclear]	DATE: 7-13-87	
1 1/4"	1.125"	DATE: 7-13-87	BY: [unclear]	DATE: 7-13-87	
1 1/2"	1.5"	DATE: 7-13-87	BY: [unclear]	DATE: 7-13-87	
2"	2.0"	DATE: 7-13-87	BY: [unclear]	DATE: 7-13-87	
2 1/2"	2.5"	DATE: 7-13-87	BY: [unclear]	DATE: 7-13-87	
3"	3.0"	DATE: 7-13-87	BY: [unclear]	DATE: 7-13-87	
3 1/2"	3.75"	DATE: 7-13-87	BY: [unclear]	DATE: 7-13-87	
4"	4.0"	DATE: 7-13-87	BY: [unclear]	DATE: 7-13-87	
4 1/2"	4.75"	DATE: 7-13-87	BY: [unclear]	DATE: 7-13-87	
5"	5.0"	DATE: 7-13-87	BY: [unclear]	DATE: 7-13-87	
5 1/2"	5.75"	DATE: 7-13-87	BY: [unclear]	DATE: 7-13-87	
6"	6.0"	DATE: 7-13-87	BY: [unclear]	DATE: 7-13-87	
6 1/2"	6.75"	DATE: 7-13-87	BY: [unclear]	DATE: 7-13-87	
7"	7.0"	DATE: 7-13-87	BY: [unclear]	DATE: 7-13-87	
7 1/2"	7.75"	DATE: 7-13-87	BY: [unclear]	DATE: 7-13-87	
8"	8.0"	DATE: 7-13-87	BY: [unclear]	DATE: 7-13-87	
8 1/2"	8.75"	DATE: 7-13-87	BY: [unclear]	DATE: 7-13-87	
9"	9.0"	DATE: 7-13-87	BY: [unclear]	DATE: 7-13-87	
9 1/2"	9.75"	DATE: 7-13-87	BY: [unclear]	DATE: 7-13-87	
10"	10.0"	DATE: 7-13-87	BY: [unclear]	DATE: 7-13-87	
10 1/2"	10.75"	DATE: 7-13-87	BY: [unclear]	DATE: 7-13-87	
11"	11.0"	DATE: 7-13-87	BY: [unclear]	DATE: 7-13-87	
11 1/2"	11.75"	DATE: 7-13-87	BY: [unclear]	DATE: 7-13-87	
12"	12.0"	DATE: 7-13-87	BY: [unclear]	DATE: 7-13-87	
12 1/2"	12.75"	DATE: 7-13-87	BY: [unclear]	DATE: 7-13-87	
13"	13.0"	DATE: 7-13-87	BY: [unclear]	DATE: 7-13-87	
13 1/2"	13.75"	DATE: 7-13-87	BY: [unclear]	DATE: 7-13-87	
14"	14.0"	DATE: 7-13-87	BY: [unclear]	DATE: 7-13-87	
14 1/2"	14.75"	DATE: 7-13-87	BY: [unclear]	DATE: 7-13-87	
15"	15.0"	DATE: 7-13-87	BY: [unclear]	DATE: 7-13-87	
15 1/2"	15.75"	DATE: 7-13-87	BY: [unclear]	DATE: 7-13-87	
16"	16.0"	DATE: 7-13-87	BY: [unclear]	DATE: 7-13-87	
16 1/2"	16.75"	DATE: 7-13-87	BY: [unclear]	DATE: 7-13-87	
17"	17.0"	DATE: 7-13-87	BY: [unclear]	DATE: 7-13-87	
17 1/2"	17.75"	DATE: 7-13-87	BY: [unclear]	DATE: 7-13-87	
18"	18.0"	DATE: 7-13-87	BY: [unclear]	DATE: 7-13-87	
18 1/2"	18.75"	DATE: 7-13-87	BY: [unclear]	DATE: 7-13-87	
19"	19.0"	DATE: 7-13-87	BY: [unclear]	DATE: 7-13-87	
19 1/2"	19.75"	DATE: 7-13-87	BY: [unclear]	DATE: 7-13-87	
20"	20.0"	DATE: 7-13-87	BY: [unclear]	DATE: 7-13-87	
20 1/2"	20.75"	DATE: 7-13-87	BY: [unclear]	DATE: 7-13-87	
21"	21.0"	DATE: 7-13-87	BY: [unclear]	DATE: 7-13-87	
21 1/2"	21.75"	DATE: 7-13-87	BY: [unclear]	DATE: 7-13-87	
22"	22.0"	DATE: 7-13-87	BY: [unclear]	DATE: 7-13-87	
22 1/2"	22.75"	DATE: 7-13-87	BY: [unclear]	DATE: 7-13-87	
23"	23.0"	DATE: 7-13-87	BY: [unclear]	DATE: 7-13-87	
23 1/2"	23.75"	DATE: 7-13-87	BY: [unclear]	DATE: 7-13-87	
24"	24.0"	DATE: 7-13-87	BY: [unclear]	DATE: 7-13-87	
24 1/2"	24.75"	DATE: 7-13-87	BY: [unclear]	DATE: 7-13-87	
25"	25.0"	DATE: 7-13-87	BY: [unclear]	DATE: 7-13-87	
25 1/2"	25.75"	DATE: 7-13-87	BY: [unclear]	DATE: 7-13-87	
26"	26.0"	DATE: 7-13-87	BY: [unclear]	DATE: 7-13-87	
26 1/2"	26.75"	DATE: 7-13-87	BY: [unclear]	DATE: 7-13-87	
27"	27.0"	DATE: 7-13-87	BY: [unclear]	DATE: 7-13-87	
27 1/2"	27.75"	DATE: 7-13-87	BY: [unclear]	DATE: 7-13-87	
28"	28.0"	DATE: 7-13-87	BY: [unclear]	DATE: 7-13-87	
28 1/2"	28.75"	DATE: 7-13-87	BY: [unclear]	DATE: 7-13-87	
29"	29.0"	DATE: 7-13-87	BY: [unclear]	DATE: 7-13-87	
29 1/2"	29.75"	DATE: 7-13-87	BY: [unclear]	DATE: 7-13-87	
30"	30.0"	DATE: 7-13-87	BY: [unclear]	DATE: 7-13-87	
30 1/2"	30.75"	DATE: 7-13-87	BY: [unclear]	DATE: 7-13-87	
31"	31.0"	DATE: 7-13-87	BY: [unclear]	DATE: 7-13-87	
31 1/2"	31.75"	DATE: 7-13-87	BY: [unclear]	DATE: 7-13-87	
32"	32.0"	DATE: 7-13-87	BY: [unclear]	DATE: 7-13-87	
32 1/2"	32.75"	DATE: 7-13-87	BY: [unclear]	DATE: 7-13-87	
33"	33.0"	DATE: 7-13-87	BY: [unclear]	DATE: 7-13-87	
33 1/2"	33.75"	DATE: 7-13-87	BY: [unclear]	DATE: 7-13-87	
34"	34.0"	DATE: 7-13-87	BY: [unclear]	DATE: 7-13-87	
34 1/2"	34.75"	DATE: 7-13-87	BY: [unclear]	DATE: 7-13-87	
35"	35.0"	DATE: 7-13-87	BY: [unclear]	DATE: 7-13-87	
35 1/2"	35.75"	DATE: 7-13-87	BY: [unclear]	DATE: 7-13-87	
36"	36.0"	DATE: 7-13-87	BY: [unclear]	DATE: 7-13-87	
36 1/2"	36.75"	DATE: 7-13-87	BY: [unclear]	DATE: 7-13-87	
37"	37.0"	DATE: 7-13-87	BY: [unclear]	DATE: 7-13-87	
37 1/2"	37.75"	DATE: 7-13-87	BY: [unclear]	DATE: 7-13-87	
38"	38.0"	DATE: 7-13-87	BY: [unclear]	DATE: 7-13-87	
38 1/2"	38.75"	DATE: 7-13-87	BY: [unclear]	DATE: 7-13-87	
39"	39.0"	DATE: 7-13-87	BY: [unclear]	DATE: 7-13-87	
39 1/2"	39.75"	DATE: 7-13-87	BY: [unclear]	DATE: 7-13-87	
40"	40.0"	DATE: 7-13-87	BY: [unclear]	DATE: 7-13-87	
40 1/2"	40.75"	DATE: 7-13-87	BY: [unclear]	DATE: 7-13-87	
41"	41.0"	DATE: 7-13-87	BY: [unclear]	DATE: 7-13-87	
41 1/2"	41.75"	DATE: 7-13-87	BY: [unclear]	DATE: 7-13-87	
42"	42.0"	DATE: 7-13-87	BY: [unclear]	DATE: 7-13-87	
42 1/2"	42.75"	DATE: 7-13-87	BY: [unclear]	DATE: 7-13-87	
43"	43.0"	DATE: 7-13-87	BY: [unclear]	DATE: 7-13-87	
43 1/2"	43.75"	DATE: 7-13-87	BY: [unclear]	DATE: 7-13-87	
44"	44.0"	DATE: 7-13-87	BY: [unclear]	DATE: 7-13-87	
44 1/2"	44.75"	DATE: 7-13-87	BY: [unclear]	DATE: 7-13-87	
45"	45.0"	DATE: 7-13-87	BY: [unclear]	DATE: 7-13-87	
45 1/2"	45.75"	DATE: 7-13-87	BY: [unclear]	DATE: 7-13-87	
46"	46.0"	DATE: 7-13-87	BY: [unclear]	DATE: 7-13-87	
46 1/2"	46.75"	DATE: 7-13-87	BY: [unclear]	DATE: 7-13-87	
47"	47.0"	DATE: 7-13-87	BY: [unclear]	DATE: 7-13-87	
47 1/2"	47.75"	DATE: 7-13-87	BY: [unclear]	DATE: 7-13-87	
48"	48.0"	DATE: 7-13-87	BY: [unclear]	DATE: 7-13-87	
48 1/2"	48.75"	DATE: 7-13-87	BY: [unclear]	DATE: 7-13-87	
49"	49.0"	DATE: 7-13-87	BY: [unclear]	DATE: 7-13-87	
49 1/2"	49.75"	DATE: 7-13-87	BY: [unclear]	DATE: 7-13-87	
50"	50.0"	DATE: 7-13-87	BY: [unclear]	DATE: 7-13-87	
50 1/2"	50.75"	DATE: 7-13-87	BY: [unclear]	DATE: 7-13-87	
51"	51.0"	DATE: 7-13-87	BY: [unclear]	DATE: 7-13-87	
51 1/2"	51.75"	DATE: 7-13-87	BY: [unclear]	DATE: 7-13-87	
52"	52.0"	DATE: 7-13-87	BY: [unclear]	DATE: 7-13-87	
52 1/2"	52.75"	DATE: 7-13-87	BY: [unclear]	DATE: 7-13-87	
53"	53.0"	DATE: 7-13-87	BY: [unclear]	DATE: 7-13-87	
53 1/2"	53.75"	DATE: 7-13-87	BY: [unclear]	DATE: 7-13-87	
54"	54.0"	DATE: 7-13-87	BY: [unclear]	DATE: 7-13-87	
54 1/2"	54.75"	DATE: 7-13-87	BY: [unclear]	DATE: 7-13-87	
55"	55.0"	DATE: 7-13-87	BY: [unclear]	DATE: 7-13-87	
55 1/2"	55.75"	DATE: 7-13-87	BY: [unclear]	DATE: 7-13-87	
56"	56.0"	DATE: 7-13-87	BY: [unclear]	DATE: 7-13-87	
56 1/2"	56.75"	DATE: 7-13-87	BY: [unclear]	DATE: 7-13-87	
57"	57.0"	DATE: 7-13-87	BY: [unclear]	DATE: 7-13-87	
57 1/2"	57.75"	DATE: 7-13-87	BY: [unclear]	DATE: 7-13-87	
58"	58.0"	DATE: 7-13-87	BY: [unclear]	DATE: 7-13-87	
58 1/2"	58.75"	DATE: 7-13-87	BY: [unclear]	DATE: 7-13-87	
59"	59.0"	DATE: 7-13-87	BY: [unclear]	DATE: 7-13-87	
59 1/2"	59.75"	DATE: 7-13-87	BY: [unclear]	DATE: 7-13-87	
60"	60.0"	DATE: 7-13-87	BY: [unclear]	DATE: 7-13-87	
60 1/2"	60.75"	DATE: 7-13-87	BY: [unclear]	DATE: 7-13-87	
61"	61.0"	DATE: 7-13-87	BY: [unclear]	DATE: 7-13-87	
61 1/2"	61.75"	DATE: 7-13-87	BY: [unclear]	DATE: 7-13-87	
62"	62.0"	DATE: 7-13-87	BY: [unclear]	DATE: 7-13-87	
62 1/2"	62.75"	DATE: 7-13-87	BY: [unclear]	DATE: 7-13-87	
63"	63.0"	DATE: 7-13-87	BY: [unclear]	DATE: 7-13-87	
63 1/2"	63.75"	DATE: 7-13-87	BY: [unclear]	DATE: 7-13-87	
64"	64.0"	DATE: 7-13-87	BY: [unclear]	DATE: 7-13-87	
64 1/2"	64.75"	DATE: 7-13-87	BY: [unclear]	DATE: 7-13-87	
65"	65.0"	DATE: 7-13-87	BY: [unclear]	DATE: 7-13-87	
65 1/2"	65.75"	DATE: 7-13-87	BY: [unclear]	DATE: 7-13-87	
66"	66.0"	DATE: 7-13-87	BY: [unclear]	DATE: 7-13-87	
66 1/2"	66.75"	DATE: 7-13-87	BY: [unclear]	DATE: 7-13-87	
67"	67.0"	DATE: 7-13-87	BY: [unclear]	DATE: 7-13-87	
67 1/2"	67.75"	DATE: 7-13-87	BY: [unclear]	DATE: 7-13-87	
68"	68.0"	DATE: 7-13-87	BY: [unclear]	DATE: 7-13-87	
68 1/2"	68.75"	DATE: 7-13-87	BY: [unclear]	DATE: 7-13-87	
69"	69.0"	DATE: 7-13-87	BY: [unclear]	DATE: 7-13-87	
69 1/2"	69.75"	DATE: 7-13-87	BY: [unclear]	DATE: 7-13-87	