

4

3

2

1

THIS DRAWING IS UNPUBLISHED. RELEASED FOR PUBLICATION. ALL RIGHTS RESERVED.

LOC	DIST	REVISIONS			
F	LNK	DESCRIPTION	DATE	BY	APPD
CM	53				
	S1	REVISED PER ECO-11-004820	11MAR11	RK	HMR

- 1 PARTS COMPLY WITH AMP SOLDERABILITY SPEC NO. 109-11-3.
- 2 CONTACT IS PLATED OVERALL WITH 0.00127[.000050] NICKEL THEN 0.000762[.000030] GOLD OVER CONTACT LENGTH INDICATED AND MATTE TIN ON SOLDER TAIL END.

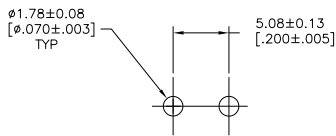
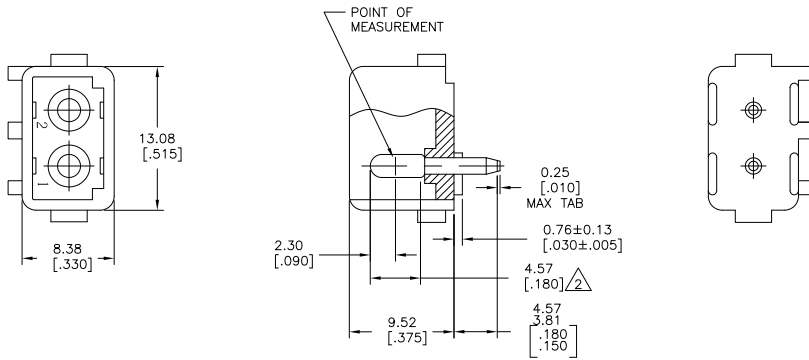

RECOMMENDED LAYOUT FOR  
1.57[.062] THICK P.C. BOARD

COPPER ALLOY-PRE TIN	NYLON, NATURAL UL94V-0	350209-3
COPPER ALLOY-GOLD	NYLON, NATURAL UL94V-2	350209-2
COPPER ALLOY-PRE TIN	NYLON, NATURAL UL94V-2	350209-1
PIN MAT'L & COLOR	HSG, MAT'L & COLOR	ASS'Y NUMBER

DIMENSIONS		TOLERANCES UNLESS OTHERWISE SPECIFIED		DRAWN		CHECKED		APPROVED	
mm	[INCHES]	PLC	±	FR	DATE	FR	DATE	FR	DATE
0 PLC	±	-	-	FR	DATE	FR	DATE	FR	DATE
1 PLC	±	-	-	FR	DATE	FR	DATE	FR	DATE
2 PLC	±	-	-	FR	DATE	FR	DATE	FR	DATE
3 PLC	±	0.38	(015)	FR	DATE	FR	DATE	FR	DATE
4 PLC	±	-	-	FR	DATE	FR	DATE	FR	DATE
ANGLES	±	-	-	FR	DATE	FR	DATE	FR	DATE

THIS DRAWING IS A CONTROLLED DOCUMENT.		DRN	18MAR09	TE Connectivity
DIMENSIONS		CHK	18MAR09	
MATERIAL		APR	18MAR09	
FINISH		NAME		
SEE TABLE		APPLICATION SPEC		
SEE TABLE		WEIGHT		
CUSTOMER DRAWING		SIZE	A2	
		ORIG CODE	C=350209	
		DRAWING NO		
		RESTRICTED TO		
		SCALE	4:1	
		SHEET	1 of 1	
		REV	S1	

1471-9 (3/11)

350209

B

A