

DATE: 08/15/2018 BY: TECH ELECTRONICS CORPORATION ALL RIGHTS RESERVED

REV. NO.		REVISIONS			
CM	00	REV. NO.	DESCRIPTION	DATE	BY
G	ECO-07-030154				

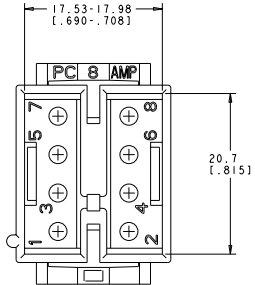

1. TO BE USED WITH COMMERCIAL MATE-N-LOK™ PINS.
2. TO BE USED WITH PLUG 480283.
3. RECOMMENDED PANEL THICKNESS "E" IS 1.02-2.54 [1.040-1.100] AND IS DEPENDENT ON "T" AND "R".
4. HOUSING MUST BE INSERTED IN A ROCKING MANNER.
5. THE PANEL MUST BE PUNCHED SO THAT THE HOUSING ENTERS THE PANEL IN THE SAME DIRECTION AS THE PUNCH.
6. MOTOR MOUNT HOUSINGS MAY BE USED IN FLAT PANELS.

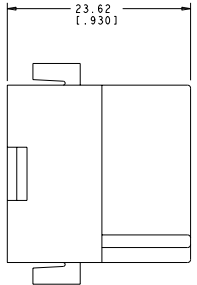
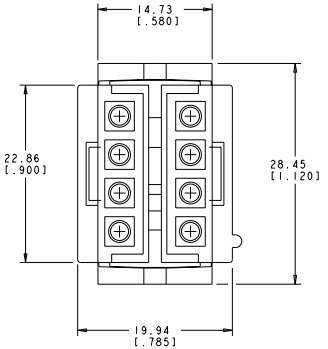
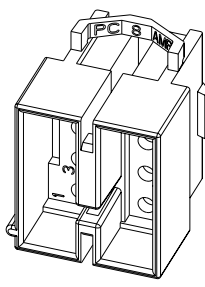
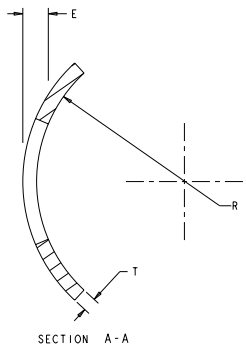
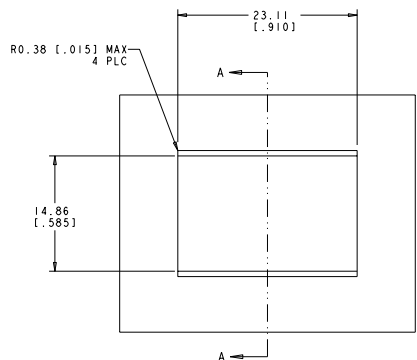
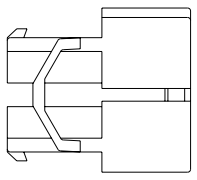

0.24 IN <sup>3</sup>	1-480284-0
VOLUME	PART NUMBER

DATE: 08/15/2018	BY: TECH ELECTRONICS CORPORATION	REV. NO.: 00	DESCRIPTION: 8 CIRCUIT, MOTOR MOUNT, COMMERCIAL MATE-N-LOK (TM)
DATE: 08/15/2018	BY: TECH ELECTRONICS CORPORATION	REV. NO.: 00	DESCRIPTION: 8 CIRCUIT, MOTOR MOUNT, COMMERCIAL MATE-N-LOK (TM)
DATE: 08/15/2018	BY: TECH ELECTRONICS CORPORATION	REV. NO.: 00	DESCRIPTION: 8 CIRCUIT, MOTOR MOUNT, COMMERCIAL MATE-N-LOK (TM)



APP: 0805 REV: 00000000  
Pre-ENGINEER DRAWING