

4

3

2

1

THIS DRAWING IS UNPUBLISHED. RELEASED FOR PUBLICATION
 © COPYRIGHT BY TYCO ELECTRONICS CORPORATION. ALL RIGHTS RESERVED.

LOC	DIST	REVISIONS					
FT	0	F	LN	DESCRIPTION	DATE	BY	APPD
		N		REVISED PER 063B-1137-04	12/15/04	SS	GS
		N1		REVISED PER ECO-09-020689	28AUG09	KK	AEG

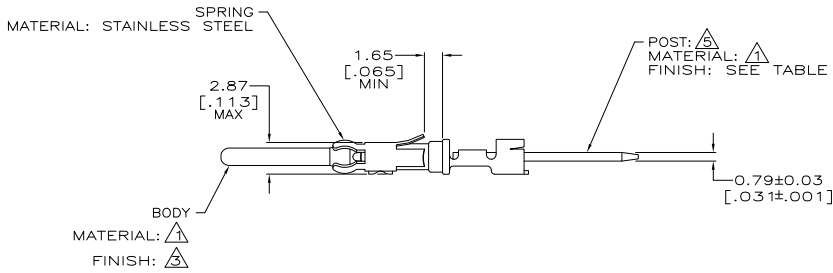
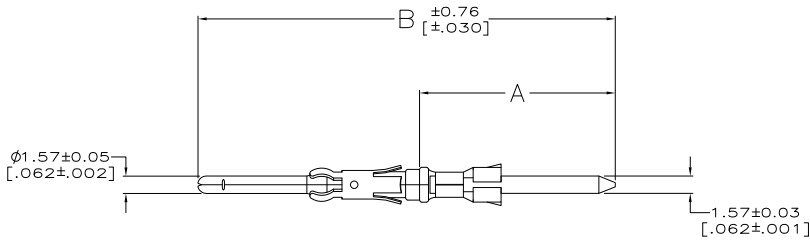

- △ BRASS PER ASTM B-36.
- △ 2.54um[.0000100] MIN TIN-LEAD OVER 1.27um[.000050] MIN NICKEL.
- △ SELECTIVELY PLATED 0.76um[.000030] MIN GOLD, FOR A DISTANCE OF 5.08[.200] FROM MATING END, GOLD FLASH ON REMAINDER, ALL OVER 1.27um[.000050] MIN NICKEL.
- 4. GOLD PLATING NOT TO APPEAR ON INSULATION SUPPORT STABILIZER.
- △ POST WILL ACCEPT (SEE TABLE) TERMINATIONS.
- △ 2.54um[.0000100] MIN TIN OVER 1.27um[.000050] MIN NICKEL.
- △ OBSOLETE PARTS: OBSOLETE CIS STREAMLINING PER D.RENAUD/D.SINISI

△	3	49.89 [1.964]	29.74 [1.171]	1-66470-1
△	1	37.97 [1.495]	17.81 [.701]	1-66470-0
△	3	49.89 [1.964]	29.74 [1.171]	66470-9
△	1	37.97 [1.495]	17.81 [.701]	66470-7
POST PLATING	NO OF TERM	B	A	PART NUMBER

THIS DRAWING IS A CONTROLLED DOCUMENT.		DRN C. REISNYDER 07 JUN 98	Tyco Electronics Corporation Harrisburg, Pa 17105-3608	
DIMENSIONS: mm [INCHES]		CHK B. STONE 12 JUL 98	APPROVED G.A. STEINHAUER 23 JUL 98	
TOLERANCES UNLESS OTHERWISE SPECIFIED:		APPLICATION SPEC: PRODUCT SPEC: SIZE CASE CODE DRAWING NO RESTRICTED TO		
0 PLC ± .010		WEIGHT: CUSTOMER DRAWING		
1 PLC ± .015		SCALE: 4:1 SHEET 1 OF 1 REV N1		
2 PLC ± .020				
3 PLC ± .025				
4 PLC ± .030				
ANGLES ± .5°				
MATERIAL: SEE CALLOUTS		FINISH: SEE CALLOUTS		

AMP 1471-9 REV 31MAR2000

66470

A