

4 3 2 1

THIS DRAWING IS UNPUBLISHED. RELEASED FOR PUBLICATION
 © COPYRIGHT BY TYCO ELECTRONICS CORPORATION. ALL RIGHTS RESERVED.

LOC	DIST	REVISIONS			
P	LTR	DESCRIPTION	DATE	MIN	APPRO
FT	0				
	F	REVISED PER 0638-0008-04	1/12/04	SS	GS

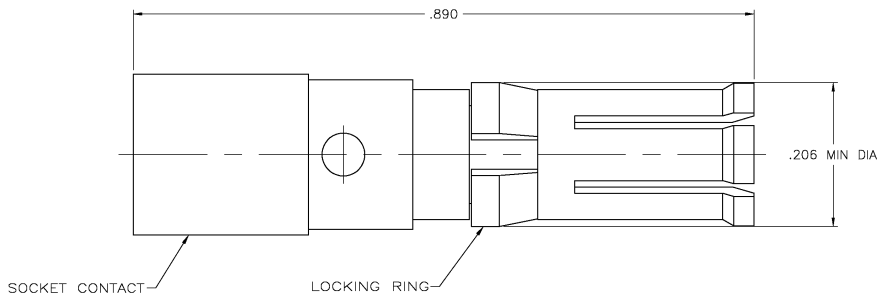

- 1 BERYLLIUM COPPER.
- 2 0.76 μm [.000030] MIN GOLD OVER 1.27 μm [.000050] MIN NICKEL.
- 3 2.54 μm [.000100] MIN NICKEL.

213750-1
 PART NUMBER

THIS DRAWING IS A CONTROLLED DOCUMENT.		DATE: 07/16/92	Tyco Electronics Corporation Harrisburg, PA 17105	
DIMENSIONS: INCHES TOLERANCES UNLESS OTHERWISE SPECIFIED: 0 PLG ± .0005 1 PLG ± .0005 2 PLG ± .0005 3 PLG ± .0005 4 PLG ± .0005 ANGLES ± .5°		L. SIEP G.K. STONE PPG PRODUCT SPEC: 108-1317 APPLICATION SPEC: 114-10014 HEIGHT: -	SOCKET CONTACT ASSEMBLY, #8 AWG, TYPE VIII, METRIMATE	
MATERIAL: SOCKETING CONTACT & LOCKING RING:		FINISH: SOCKETING CONTACT: LOCKING RING:		SHEET: A2 CASE CODE: 00779 DRAWING NO: 213750 RESTRICTED TO: -
CUSTOMER DRAWING		SCALE: 10:1	SHEET: 1 of 1	REV: F

AMP 1421-9 REV 31 MAR 2000

213750

A