

4

3

2

1

THIS DRAWING IS UNPUBLISHED. RELEASED FOR PUBLICATION. ALL RIGHTS RESERVED.

LOC	DIST	REVISIONS					
FT	0	P	LTR	DESCRIPTION	DATE	MIN	APVD
		H1		REVISED PER ECO-11-004587	11MAR11	RK	HMR

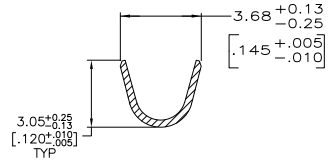
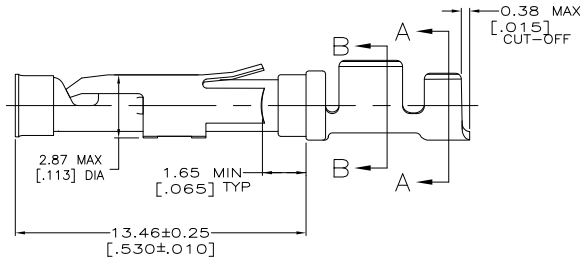
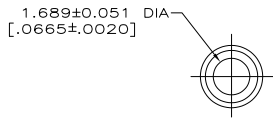
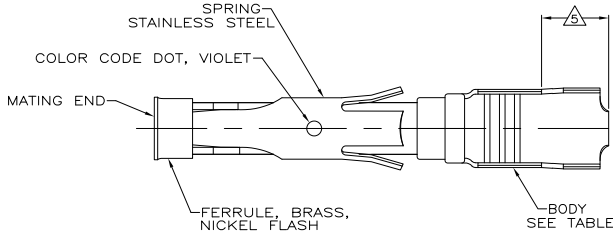

SECTION A-A

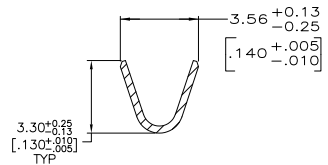

SECTION B-B

- △ 0.76µm [.000030] MIN GOLD PER MIL-G-45204 ON MATING END FOR A LENGTH OF 5.08 [.200] MIN WITH GOLD FLASH ON THE REMAINDER OVER 0.76µm [.000030] MIN NICKEL PER QQ-N-290.
- △ 1.27µm [.000050] MIN TIN-LEAD PER MIL-T-10727 OVER
- △ 0.76µm [.000030] MIN NICKEL PER QQ-N-290.
- △ 0.76µm [.000030] MIN GOLD PER MIL-G-45204 ON MATING END FOR A LENGTH OF 5.08 [.200] MIN WITH A UNIFORM GRADIENT TO 0.25µm [.000010] MIN GOLD PER MIL-G-45204 ON THE REMAINDER OVER 0.76µm [.000030] MIN NICKEL PER QQ-N-290.
- △ 0.38µm [.000015] MIN GOLD PER MIL-G-45204 ON MATING END FOR A LENGTH OF 5.08 [.200] MIN WITH GOLD FLASH ON THE REMAINDER OVER 0.76µm [.000030] MIN NICKEL PER QQ-N-290.
- △ GOLD PLATING NOT REQUIRED IN THIS AREA.
- △ WIRE RANGE 18-14 AWG.
- △ INSULATION RANGE 2.03[.080]-2.54[.100].
- △ 0.38µm [.000015] MIN GOLD PER MIL-G-45204 ON MATING END FOR A LENGTH OF 5.08 [.200] MIN, 1.27µm [.000050] MIN TIN-LEAD PER MIL-T-10727 FOR A LENGTH OF 5.69 [.224] MIN ON OPPOSITE END, BOTH OVER 1.27µm [.000050] MIN NICKEL PER QQ-N-290 ON ENTIRE CONTACT.
- △ 1.27µm [.000050] MIN TIN PER MIL-T-10727 OVER
- △ 0.76µm [.000030] MIN NICKEL PER QQ-N-290.

STANDARD	△	CU-NI ALLOY	2-66358-1	1-66360-6
STANDARD	△	CU-NI ALLOY	2-66358-0	1-66360-5
STANDARD	△	CU-NI ALLOY	1-66358-9	1-66360-4
SMALL PACK	△	BRASS	1-66358-6	1-66360-3
STANDARD	△	BRASS	1-66358-6	1-66360-2
SMALL PACK	△	BRASS	66358-4	1-66360-1
SMALL PACK	△	BRASS	66358-2	1-66360-0
OBSOLETE	△	BRASS	1-66358-5	66360-9
OBSOLETE	△	PHOSPHOR BRONZE	1-66358-3	66360-8
OBSOLETE	△	PHOSPHOR BRONZE	1-66358-2	66360-7
STANDARD	△	BRASS	66358-4	66360-4
STANDARD	△	BRASS	66358-3	66360-3
STANDARD	△	BRASS	66358-2	66360-2
STANDARD	△	BRASS	66358-1	66360-1
PACKAGING		BODY MATERIAL	STRIP P/N REF	PART NUMBER

THIS DRAWING IS A CONTROLLED DOCUMENT.

DATE: 06/03/92	REV: 0
DESIGNED BY: W. LENKER	DATE: 6-11-92
APPROVED BY: G. STEINHAUER	DATE: 7-8-92
PRODUCT SPEC: ---	APPLICATION SPEC: ---
SIZE: A2	CAGE CODE: 00779
WEIGHT: ---	DRAWING NO: C-66360
MATERIAL: SEE CALLOUTS	FINISH: SEE TABLE
CUSTOMER DRAWING	

TE Connectivity  
SOCKET ASSEMBLY, LOOSE PIECE, TYPE III+

SCALE: 8:1 SHEET: 1 of 1 REV: H1