

4

3

2

1

THIS DRAWING IS UNPUBLISHED. RELEASED FOR PUBLICATION
 © COPYRIGHT BY TYCO ELECTRONICS CORPORATION. ALL RIGHTS RESERVED.

LOC		DIST		REVISIONS			
P	LTR	DESCRIPTION	DATE	OWN	APPD		
L		REVISED PER 0639-0168-05	3/10/05	SS	GS		

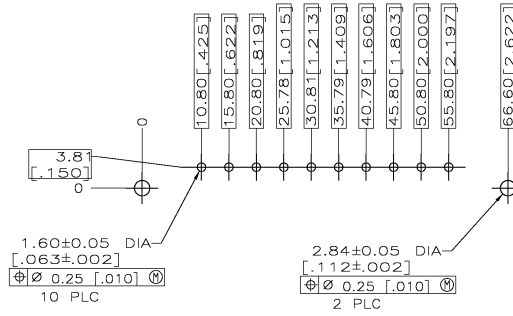
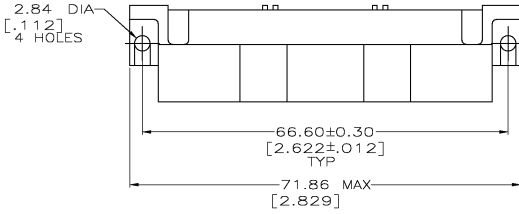

RECOMMENDED PC BOARD LAYOUT

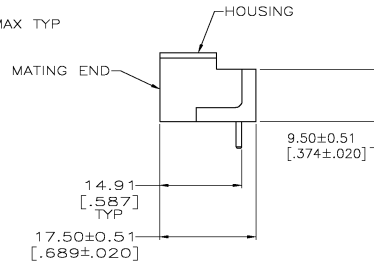
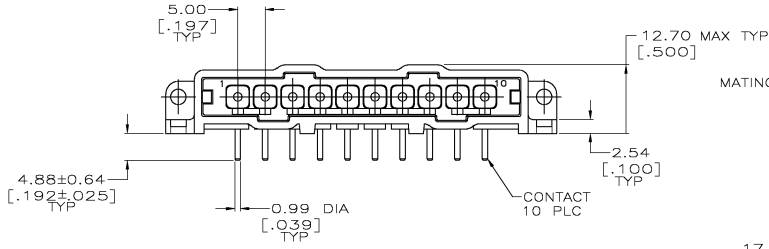

- ▲ NYLON, RED.
- ▲ BRASS PER ASTM B36.
- ▲ 3.81um [.000150] MIN TIN-LEAD OVER 2.54um [.000100] MIN COPPER OR 1.27um [.000050] MIN NICKEL.
- ▲ 0.76um [.000030] MIN GOLD FOR A LENGTH OF 5.08 [.200] MIN FROM MATING END, 3.81um [.000150] MIN TIN-LEAD FOR A LENGTH OF 5.36 [.211] MIN FROM OPPOSITE END, BOTH OVER 1.27um [.000050] MIN NICKEL.
- ▲ .000150 MIN LEAD FREE TIN OVER .000100 MIN COPPER, OR .000050 MIN NICKEL.
- ▲ 0.76um [.000030] MIN GOLD FOR A LENGTH OF 5.08 [.200] MIN FROM MATING END, 3.81um [.000150] MIN TIN FOR A LENGTH OF 5.36 [.211] MIN FROM OPPOSITE END, BOTH OVER 1.27um [.000050] MIN NICKEL.

▲	207398-7
▲	207398-6
▲	207398-3
▲	207398-1
FINISH	PART NO

THIS DRAWING IS A CONTROLLED DOCUMENT.		DATE: 01/07/02	Tyco Electronics Corporation Horriarsburg, Pa 17105-3608	PIN HEADER ASSEMBLY, 10 POSN, IN-LINE, RIGHT ANGLE, SMALL METRIC CONNECTOR, METRIMATE	RESTRICTED TO
DIMENSIONS: mm (INCHES)		L: SIPC 7-24-92 GIK: STONE 7-24-92 R: STONE 7-24-92 APPD: MJC			
TO RANGE: 0.125 (0.005) 0 PLC ± - 1 PLC ± - 2 PLC ± 0.25 (0.010) 3 PLC ± - 4 PLC ± - ANGLES ± - FINISH ± -		PRODUCT SPEC: - APPLICATION SPEC: - HEIGHT: -	SEE DATE CODE DRAWING NO: A2 00779 ©=207398		
MATERIAL: HOUSING: ▲ CONTACTS: ▲		CONTACTS: SEE TABLE	CUSTOMER DRAWING	SCALE: 2:1	SHEET 1 OF 1 REV L

AMP 1431-9 REV 31 MAR 2000

207398

A