

4

3

2

1

THIS DRAWING IS UNPUBLISHED. RELEASED FOR PUBLICATION. ALL RIGHTS RESERVED.

LOC	DIST	REVISIONS					
FT	0	F	LNK	DESCRIPTION	DATE	MIN	APD
		AY1		REVISED PER ECO-11-004587	11MAR11	RK	HMR

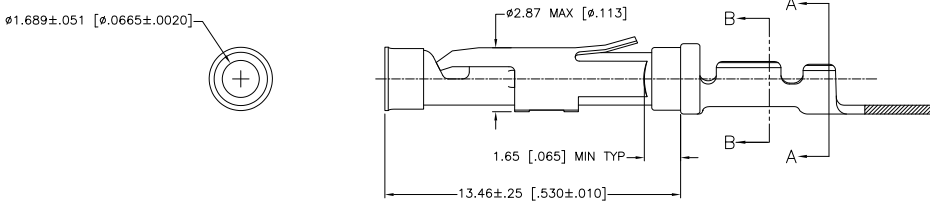
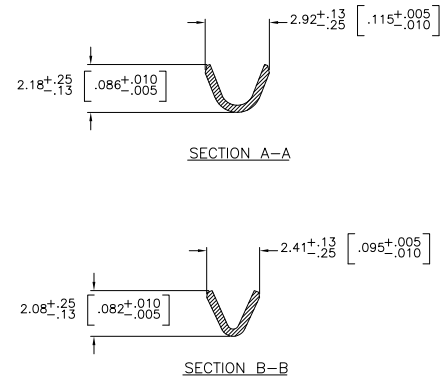
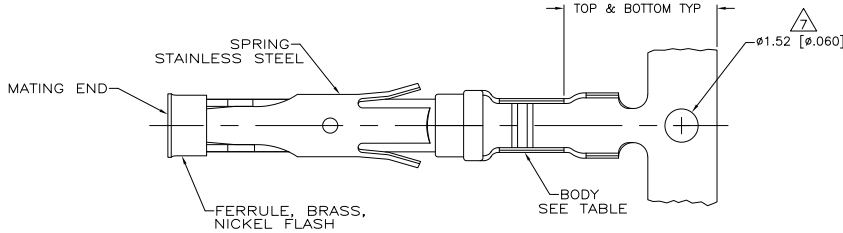

- 1 0.76µm [0.00030] MIN GOLD PER MIL-G-45204 ON MATING END FOR A LENGTH OF 5.08 [2.00] MIN WITH GOLD FLASH ON THE REMAINDER OVER 0.76µm [0.00030] MIN NICKEL PER QQ-N-290.
- 2 1.27µm [0.00050] MIN TIN-LEAD PER MIL-T-10727 OVER 0.76µm [0.00030] MIN NICKEL PER QQ-N-290.
- 3 0.76µm [0.00030] MIN GOLD PER MIL-G-45204 ON MATING END FOR A LENGTH OF 5.08 [2.00] MIN WITH A UNIFORM GRADIENT TO 0.25[0.00010] MIN GOLD PER MIL-G-45204 ON THE REMAINDER OVER 0.76µm [0.00030] NICKEL PER QQ-N-290.
- 4 0.38µm [0.00015] MIN GOLD PER MIL-G-45204 ON MATING END FOR A LENGTH OF 5.08 [2.00] MIN WITH GOLD FLASH ON THE REMAINDER OVER 0.76µm [0.00030] MIN NICKEL PER QQ-N-290.
- 5 1.27µm [0.00050] MIN GOLD PER MIL-G-45204 ON MATING END FOR A LENGTH OF 5.08 [2.00] MIN WITH GOLD FLASH ON REMAINDER OVER 1.90µm [0.00075] MIN NICKEL PER QQ-N-290.
- 6 0.15µm [0.00002] MIN GOLD PER MIL-G-45204 ON MATING END FOR A LENGTH OF 5.08 [2.00] MIN WITH GOLD FLASH ON REMAINDER OVER 1.27µm [0.00050] MIN NICKEL PER QQ-N-290.
- 7 GOLD PLATING NEED NOT APPEAR IN THIS AREA EXCEPT 1-66104-6 & 1-66104-7 HAVE GOLD PLATING ON INSULATION BARREL.
- 8 REVERSE REELED FOR MINI-APPLICATOR.
- 9 WIRE RANGE 24-20 AWG. INSULATION RANGE 1.02[.040]-2.03[.080].
- 10 0.38µm [0.00015] MIN GOLD PER MIL-G-45204 ON MATING END FOR A LENGTH OF 5.08 [2.00] MIN. 1.27µm [0.00050] MIN TIN-LEAD PER MIL-T-10727 FOR A LENGTH OF 5.69 [2.24] MIN ON OPPOSITE END, BOTH OVER 1.27µm [0.00050] MIN NICKEL PER QQ-N-290 ON ENTIRE CONTACT.
- 11 0.76µm [0.00030] MIN GOLD PER MIL-G-45204 ON MATING END FOR A LENGTH OF 5.08 [2.00] MIN WITH GOLD FLASH ON THE REMAINDER OVER 1.27µm [0.00050] MIN NICKEL PER QQ-N-290.
- 12 1.27µm [0.00050] MIN TIN PER MIL-T-10727 OVER .076µm [0.00030] MIN NICKEL PER QQ-N-290.
- 13 0.38µm [0.00015] MIN GOLD PER MIL-G-45204 ON MATING END FOR A LENGTH OF 5.08 [2.00] MIN. 1.27µm [0.00050] MIN TIN PER MIL-T-10727 FOR A LENGTH OF 5.69[.224] MIN ON OPPOSITE END, BOTH OVER 1.27µm [0.00050] MIN NICKEL PER QQ-N-290 ON ENTIRE CONTACT.
- 14 2.54µm [0.00100] MIN SILVER OVER 0.76µm [0.00030] MIN NICKEL PER QQ-N-290
- 15
- 16 OBSOLETE PARTS: OBSOLETE CIS STREAMLINING PER D.RENAUD/D.SINIS
- 17 SUPERCEDED BY 3-66104-2

STANDARD	REELING	BODY FINISH	BODY MATERIAL	LOOSE PIECE REF	PART NO.
▲	▲	▲	BRASS	-	3-66104-3
▲	▲	▲	BRASS	-	3-66104-2
▲	▲	▲	BRASS	-	3-66104-1
▲	▲	▲	BRASS	1-66105-9	3-66104-0
▲	▲	▲	BRASS	1-66105-9	2-66104-9
▲	▲	▲	BRASS	-	2-66104-7
▲	▲	▲	BRASS	1-66105-4	2-66104-6
▲	▲	▲	BRASS	-	2-66104-5
▲	▲	▲	PHOSPHOR BRONZE	1-66105-3	2-66104-3
▲	▲	▲	PHOSPHOR BRONZE	1-66105-2	2-66104-2
▲	▲	▲	BRASS	-	1-66104-9
▲	▲	▲	BRASS	-	1-66104-7
▲	▲	▲	BRASS	1-66105-0	1-66104-6
▲	▲	▲	BRASS	66105-4	66104-9
▲	▲	▲	BRASS	66105-3	66104-8
▲	▲	▲	BRASS	66105-2	66104-7
▲	▲	▲	BRASS	66105-1	66104-6
▲	▲	▲	BRASS	66105-4	66104-4
▲	▲	▲	BRASS	66105-3	66104-3
▲	▲	▲	BRASS	66105-2	66104-2
▲	▲	▲	BRASS	66105-1	66104-1

THIS DRAWING IS A CONTROLLED DOCUMENT. DIM V. FURLER 22AAL2003

TE Connectivity

SOCKET ASSEMBLY, .062 TYPE III+

DATE: 22AAL03

APPROVED: G. STEINHAUER

PRODUCT SPEC: 22AAL03

APPLICATION SPEC: -

SIZE: A2

ONE CODE: 00779

DRAWING NO: 66104

RESTRICTED TO: -

MATERIAL: SEE CALLOUTS

FINISH: SEE CALLOUTS

CUSTOMER DRAWING

SCALE: 8:1

SHEET: 1 of 1

REV: AY1