

4

3

2

1

THIS DRAWING IS UNPUBLISHED. RELEASED FOR PUBLICATION 20
 © COPYRIGHT 20 TE ALL RIGHTS RESERVED.

LOC	DIST	REVISIONS				
P	LTR	DESCRIPTION	DATE	DWN	APVD	
GP	00					
		C	REV PER ECO-11-007678	03JUN2011	RG DO	

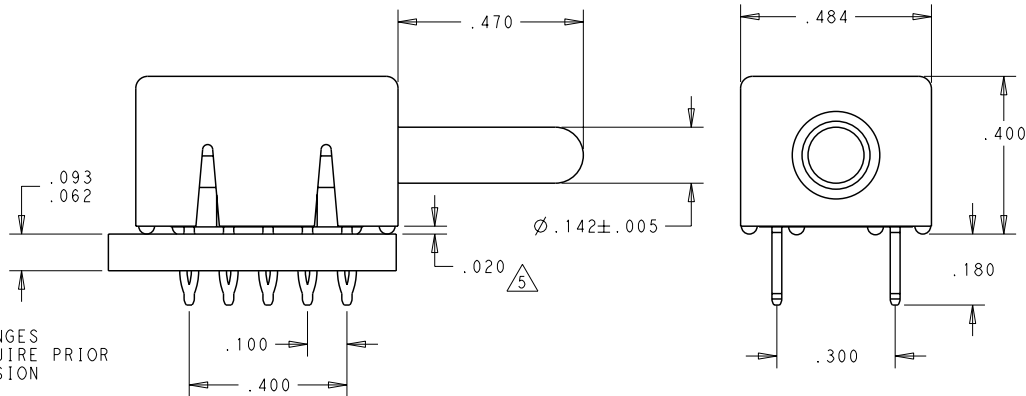
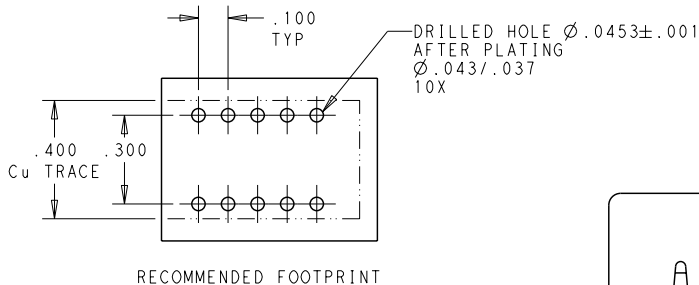

- PART NUMBER CHANGES AND/OR DESIGN CHANGES AFFECTING ITEM INTERCHANGEABILITY REQUIRE PRIOR TE APPROVAL AND AUTHORIZATION BY REVISION TO THIS DRAWING.
- ITEMS PROVIDED TO THIS SPECIFICATION TO BE IDENTIFIED ON CONTAINER WITH THE FOLLOWING INFORMATION: PART NUMBER & DATE CODE OF MANUFACTURE

3 MATERIALS:
 INSULATOR - POLYESTER, GLASS FILLED UL 94V-0 RATED, COLOR: BLACK
 MODULE - ZINC ALLOY
 COMPLIANT PINS - PHOSPHOR BRONZE
 CROWN - BeCu

4 FINISH:
 MODULE - SILVER PLATED .000200 MIN THK. OVER NICKEL .000040 MIN THK.
 COMPLIANT PINS - SILVER PLATED .000200 MIN THK. OVER NICKEL .000040 MIN THK.
 CROWN - GOLD PLATED .000030 MIN THK. OVER NICKEL .000040 MIN THK.

5 A FIVE POUND (5lb) FORCE REQUIRED TO CORRECTLY SEAT THE CONNECTOR WITH PLATED THRU HOLES LESS THAN $\varnothing.040$ INCH.

6643275-1
 PART NUMBER

THIS DRAWING IS A CONTROLLED DOCUMENT.		OWN 11 JAN 2011 LOVATO/GRZYBOWSKI	TE Connectivity	
DIMENSIONS: INCHES		CHK D ORRIS	ICCON PIN, PARALLEL COMPLIANT, NON-LOCKING STYLE	
TOLERANCES UNLESS OTHERWISE SPECIFIED:		APVD 11 JAN 2011 CHAU/ORRIS	NAME	
0 PLC ±	1 PLC ±	PRODUCT SPEC	SIZE CAGE CODE DRAWING NO RESTRICTED TO	
2 PLC ±	3 PLC ±.020	APPLICATION SPEC	A3 00779 C-6643275	
4 PLC ±	ANGLES ±.5	WEIGHT	SCALE 4:1 SHEET 1 OF 1 REV C	
MATERIAL	FINISH	CUSTOMER DRAWING		

1470-19 (3/11)

Pro/ENGINEER DRAWING