

4

3

2

1

THIS DRAWING IS UNPUBLISHED. RELEASED FOR PUBLICATION
 © COPYRIGHT - By - ALL RIGHTS RESERVED.

LOC	DIST	REVISIONS					
		P	LTR	DESCRIPTION	DATE	DWN	APVD
J	-	F1		REVISED PER ECO-11-005140	28MAR11	RK	HMR

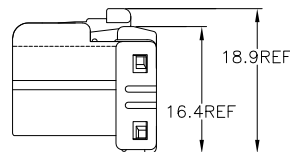
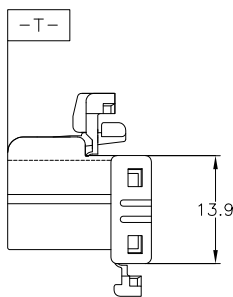
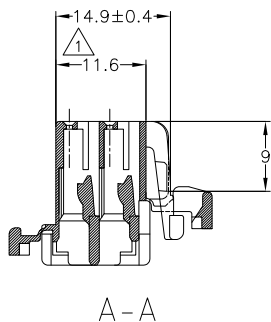
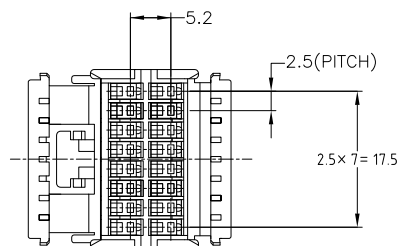
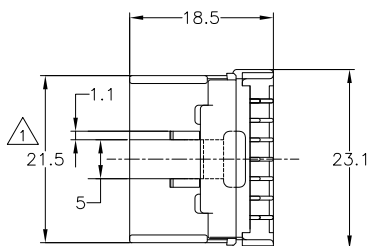
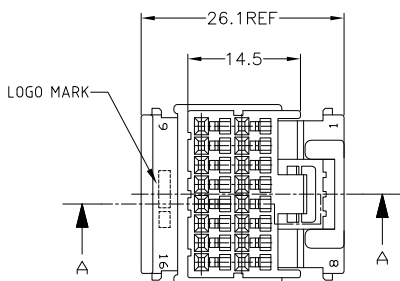

二重ロック時
DOUBLE LOCKED

OBSELETE	色 (COLOR)	製品型番 (PART NO.)
	青 (BLUE)	174046-5
	緑 (GREEN)	174046-4
	黒 (BLACK)	174046-2
	白 (WHITE)	174046-1
	色 (COLOR)	製品型番 (PART NO.)

1 -T- 面より2mmの範囲で測定。
 2 適用製品規格番号 108-5244

1 TO BE MEASURED WITHIN 2mm FRDM -T-
 2 APPLICABLE PRODUCT SPEC. NO. 108-5244

THIS DRAWING IS A CONTROLLED DOCUMENT.

DIMENSIONS:
単位: ㎜

TOLERANCES UNLESS OTHERWISE SPECIFIED:
一般公差

0 PLC	±
1 PLC	±
2 PLC	±
3 PLC	±
4 PLC	±
ANGLES	±

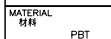

MATERIAL
材料

PBT

FINISH
仕上

一般公差
(GENERAL TOLERANCES)
0mm 10 : ± 0.25
10mm 30 : ± 0.25
30mm 100 : ± 0.3
角度 (ANGLES) : $\pm 3^\circ$

DWN M.KADOSAKI 04AUG05
 CHK T.SHINOHARA 04AUG05
 APVD K.BETSUI 04AUG05
 NAME 16 POS. PLUG HSG .040 SERIES MULTI-LOCK CONNECTOR
 名称 16極 プラグハウジング .040シリーズ マルチロック コネクタ
 PRODUCT SPEC 製品規格
 APPLICATION SPEC 取付適用規格
 WEIGHT

TE TE Connectivity
 SIZE A3 CAGE CODE 00779 DRAWING NO. 174046
 番号
 RESTRICTED TO
 CUSTOMER DRAWING SCALE 2:1 SHEET 1 of 1 REV F1