

THIS DRAWING IS UNPUBLISHED.		RELEASED FOR PUBLICATION	
BY AMP INCORPORATED, ALL RIGHTS RESERVED.		DATE: 7-93	
PART NO	CABLE REF	DATE	APPD
93-3460-001-001-1	RAYCHEM 7528F5614	0	CT

REV	DATE	DESCRIPTION	BY	APPD
0	7-93	RELEASED; 93-299 CT		CS

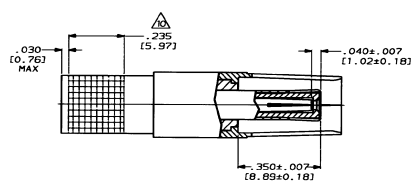

ASSEMBLED VIEW
SCALE 5:1

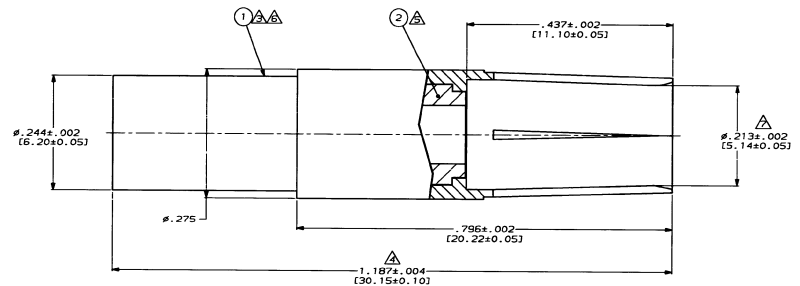
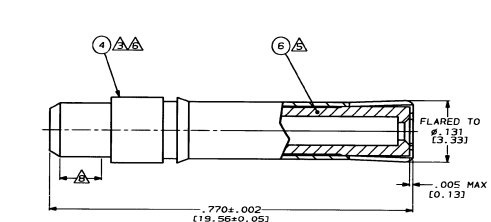
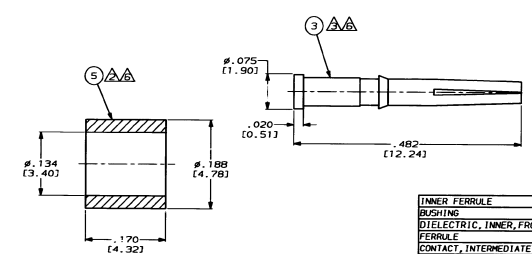
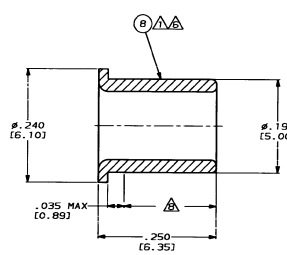

ITEM NO	DESCRIPTION
8	INNER FERRULE
7	BUSHING
6	DIELECTRIC, INNER, FRONT
5	FERRULE
4	CONTACT, INTERMEDIATE
3	CONTACT CENTER
2	DIELECTRIC, OUTER, FRONT
1	SHELL

- 1. MAT'L: BRASS PER ASTM-B-16.
- 2. MAT'L: COPPER PER ASTM-B-152.
- 3. MAT'L: BERYLLIUM COPPER PER ASTM-B-196.
- 4. 1.237 (31.17) MAX AFTER TERMINATION TO CABLE.
- 5. MAT'L: PIPE PER ASTM-D-1710.
- 6. FINISH: GOLD PLATE PER MIL-G-45204, TYPE 1, GRADE C, CLASS 1 OVER NICKEL .000050 (0.0013) THK PER QQ-N-290, CLASS 2.
- 7. MATES WITH .220±.001 (5.59±0.03) DIA PIN.
- 8. 160 DP. FULL DIAMOND KNURL OVER THIS LENGTH.
- 9. USE HAND CRIMP TOOL #220066-2. POSITION 3 FOR CENTER CONTACT. DIE C FOR INTERMEDIATE CONTACT. DIE B FOR OUTER BODY.
- 10. CRIMP IN AREA SHOWN, DO NOT CRIMP .240 DIA OF ITEM #8 (FERRULE).

THIS DRAWING IS A CONTROLLED DOCUMENT FOR AMP INCORPORATED. IT IS SUBJECT TO CHANGE AND THE CONTROLLING AMERICAN REPRESENTATION SHOULD BE CONTACTED FOR THE LATEST REVISION.

DO NOT SCALE PRINT.	OR 7-2-93	AMP Incorporated Harrisburg, PA 17105-3608
UNLESS SPECIFIED DIMENSIONS IN INCHES (mm)	C.C. THOMAS	
TOLERANCES ON:	DRAWN: C. SHELLEY	NAME: _____ TITLE: _____ DATE: _____
D P.L.S. SEC # .005 (0.13)	APPD: 7-2-93	
ANGLES:	C. SHELLEY	SOCKET ASSY, SIZE 5, TRIAX, ARINC-TRIAX
MATERIAL:	APPD: 7-2-93	PRODUCT SPEC: 108-12092
FINISH:	C.C. THOMAS	APPLICATION SPEC: _____
SEE CALLOUTS	SIZE: _____	CASE CODE: 00779
SEE CALLOUTS	WEIGHT: _____	SCALE: 10:1
		DRAWING NO: 449621
		SHEET: 1 OF 1

CUSTOMER DRAWING