

THIS DRAWING IS UNPUBLISHED
 ALL RIGHTS RESERVED

| REV | DATE | BY | CHK | REVISIONS | |
|-----|------|----|-----|---------------------------|-----------------|
| | | | | DESCRIPTION | DATE |
| 0 | | | | | |
| E2 | | | | REVISED PER ECO-11-004820 | 11MAR11 RJK HMR |

- 1 WIRE RANGE: 0.12-0.9mm² (26-18 AWG).
 - 2 INSULATION RANGE: 1.27-2.92 [.050-.115] MAX. DIA.
 - 3 DIMENSIONS IN BRACKETS ARE IN INCHES.
- △ PLATE INTERNALLY WITH 0.00076 [.000030] MIN. GOLD IN THE LOCALIZED GOLD PLATE AREA, GOLD FLASH ON THE REMAINDER, OVER 0.00127 [.000050] MIN. NICKEL UNDERPLATE.

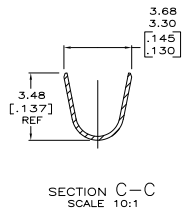
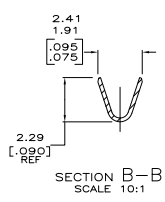
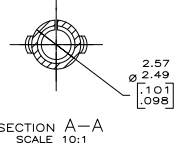
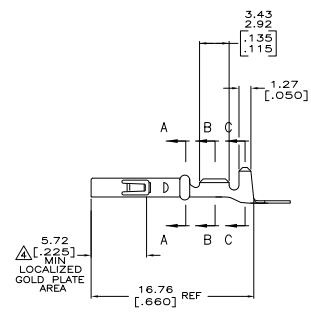
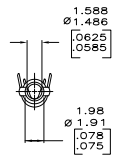
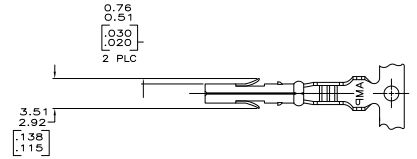

| | | |
|---------------|----------------------|----------|
| △ GOLD STRIPE | 0.20 [.008] PHOS BRZ | 641294-2 |
| PRE-TIN | 0.20 [.008] PHOS BRZ | 641294-1 |
| FINISH | MATERIAL | PART NO |

THIS DRAWING IS A CONTROLLED DOCUMENT. **TE** SALMON #38-34 **TE Connectivity**
 OR SIBING #38-34

| | | | | |
|-----------------------------|-------------------|----------------|-----------------|----------------|
| UNLESS OTHERWISE SPECIFIED: | UNIT: INCHES | DECIMALS: 2 | FRACTIONS: 1/16 | ANGLE: DEGREES |
| UNLESS OTHERWISE SPECIFIED: | UNIT: MILLIMETERS | DECIMALS: 0.05 | FRACTIONS: 1/10 | ANGLE: DEGREES |

DATE: 01/00/07
 DRAWING NO: 641294
 CUSTOMER DRAWING

