

4

3

2

1

THIS DRAWING IS UNPUBLISHED. RELEASED FOR PUBLICATION
 BY AMP INCORPORATED. ALL RIGHTS RESERVED.

LOC	DIST	REVISIONS			
FT	60	REV	DESCRIPTION	DATE	BY
		A	REV & REDRAW ON CAD PER EC 0320-70-97	11 MAR 97	-
		B	REV PER EC 061C-95-98	14 JUL 98	CO MC

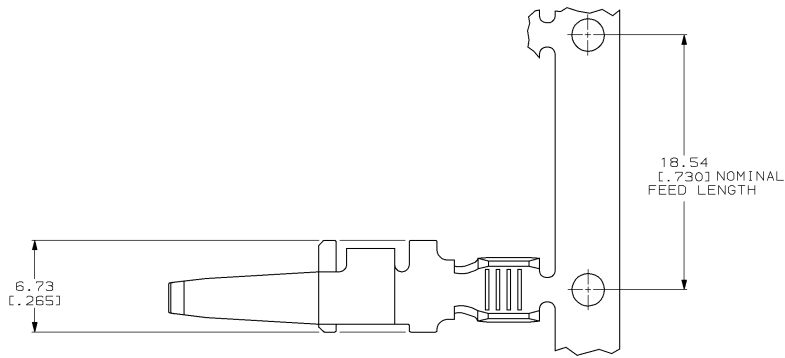

- 1 ALL DIMENSIONS ARE MAXIMUM UNLESS OTHERWISE SPECIFIED.
- 2 COPPER ALLOY.
- 3 2.54µm [0.00100] MIN TIN.
- 4. WIRE BARREL WILL ACCEPT ONE 18, 16 OR 14 AWG CU WIRE OR COMBINATIONS OF 18 AND 16 AWG CU WIRE.
- 5. THIS TERMINAL IS USED WITH HOUSING 556137 AND MOUNTING ADAPTER 557313-1.
- 6. APPLICATOR REEL: S67403-1 FOR "T" TERMINATOR, S67403-2 FOR AMP-O-ELECTRIC™ MODEL "K" MACHINE 565435-5.
- 7. HAND TOOL-LOOSE PIECE.

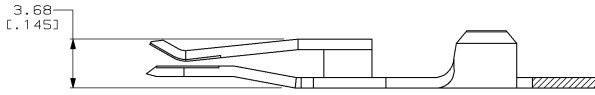

LOOSE PIECE	556135-2
ON STRIP	556135-1
DESCRIPTION	PART NUMBER

THIS DRAWING IS A CONTROLLED DOCUMENT.		DWN: N. BINNER 11 MAR 97 CHK: R. STONE 14 MAR 97 APPR: M. MALONIS 17 MAR 97	AMP AMP Incorporated Harrisburg, PA 17105-3608
DIMENSIONS: mm (INCHES)	TOLERANCES UNLESS OTHERWISE SPECIFIED	PRODUCT SPEC: 108-1373 APPLICATION SPEC: 114-6051 WEIGHT: -	NAME: M. MALONIS SIZE: A2 CASE CODE: 00779 DRAWING NO: 556135
MATERIAL:	FINISH:	CUSTOMER DRAWING	SCALE: 5:1 SHEET 1 OF 1 REV B

556135