

4

3

2

1

THIS DRAWING IS UNPUBLISHED. RELEASED FOR PUBLICATION. ALL RIGHTS RESERVED.

LOC	DIST	REVISIONS			
F	LNK	DESCRIPTION	DATE	BY	APPD
	C1	REVISED PER ECO-11-004917	11MAR11	RK	HMR

- ⚠ ALL DIMENSIONS SHOWN ARE MAXIMUM UNLESS OTHERWISE SPECIFIED.
- ⚠ MATERIAL: 2.54 μm [.000100] MINIMUM TIN PLATED COPPER ALLOY, 0.74-0.79 [.030 \pm .001] THICK.
- 3. WIRE BARREL ACCEPTS ONE 10 OR 12 AWG STRANDED COPPER WIRE.
- ⚠ CONTACTS ON REEL SHALL BE CRIMPED USING APPLICATOR TOOL 567256.
- ⚠ LOOSE PIECE CONTACTS SHALL BE CRIMPED USING TOOLS AND DIE SETS LISTED BELOW.
 HAND TOOL: AMP PART NO. 69710
 PNEUMATIC TOOL: AMP PART NO. 69365
 DIE SET 10 AWG: AMP PART NO. 58491-1
 DIE SET 12 AWG: AMP PART NO. 58490-1

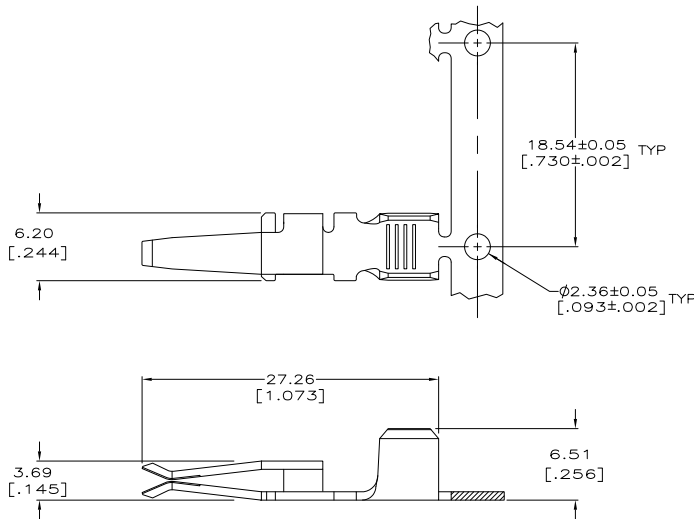

DESCRIPTION	PART NO
2000/REEL	556880-2
LOOSE PIECE 200/BOX	556880-1

THIS DRAWING IS A CONTROLLED DOCUMENT.		DRW D. STRAUSSER 5-30-91	TE Connectivity	
DIMENSIONS: mm [INCHES]		CHK D. FOX 8-23-91	TE	
TOLERANCES UNLESS OTHERWISE SPECIFIED:		APPD M. MILLER 8-26-91	TE Connectivity	
0. PLC	± .05	NAME	CONTACT, DUAL BEAM,	
1. PLC	± .02	PRODUCT SPEC	10-12 AWG, WTB, AMPINERGY	
2. PLC	± .01	APPLICATION SPEC	TM	
3. PLC	± .005	114-6044	SIZE	A2
4. PLC	± .002	HEIGHT	CAGE CODE	00779
ANGLES	± .001	114-6044	DRAWING NO	C-556880
FINISH	± .001	CUSTOMER DRAWING	RESTRICTED TO	-
		SCALE	4:1	SHEET 1 of 1
		REV	C1	

1471-9 (3/11)

556880

B

A