

4

3

2

1

THIS DRAWING IS UNPUBLISHED. RELEASED FOR PUBLICATION
 © COPYRIGHT - By - ALL RIGHTS RESERVED.

LOC		DIST		REVISIONS			
P	LTR	DESCRIPTION		DATE	DWN	APVD	
A1		REVISED PER ECO-11-005150		21MAR11	RK	HMR	

8. PART NUMBER INFORMATION

CONNECTOR	TE CONNECTIVITY PART NUMBER	ELCON PART NUMBER	TERMINATION TYPE	PC TAIL LENGTH DIM 'A'	RECOMMENDED MOUNTING BOARD	MATING BOARD
SOCKET	6650384-1	286-0052-12101	SOLDER TAIL (SHORT)	3.56 [.140] 2.54 [.100]	1.6 [.062] THICK	1.6 [.062] THICK
SOCKET	6650384-2	286-0052-11301	SOLDER TAIL COMPLIANT	5.08 [.200] 4.06 [.160]	3.2 [.125] OR THINNER	1.6 [.062] THICK
SOCKET	6650384-3	287-0032-12301	SOLDER TAIL (STANDARD)	5.08 [.200] 4.06 [.160]	3.2 [.125] OR THINNER	1.6 [.062] THICK

NOTES: UNLESS OTHERWISE SPECIFIED;

- PART NUMBER CHANGES AND OR DESIGN CHANGES AFFECTING ITEM INTERCHANGEABILITY REQUIRE PRIOR ELCON APPROVAL AND AUTHORIZATION BY REVISION TO THIS DRAWING.
- MATERIALS:
INSULATORS: THERMOPLASTIC, GLASS REINFORCED, COLOR-BLACK, UL94V-0 FLAMMABILITY RATED.
CONTACTS: PHOSPHOR-BRONZE ALLOY.
- FINISHES:
CONTACTS: SELECTIVE GOLD PLATE PER MIL-G-45204 TYPE II, GRADE C, CLASS 0, .000030" MIN. THK, OVER NICKEL PER QQ-N-290, CLASS 2, .000040" MIN. THICKNESS.
TERMINALS: TIN PLATED, MATTE FINISH, .000100" MINIMUM THICKNESS.

- 4 SOCKETS ACCEPT 1.6 [.062] ± 10% THK PC BOARD.
- 5 EXAMPLE PCB CONFIGURATION.
- 6 THIS 3 X 2 SEGMENT CONFIGURATION SHOWN IS FOR REFERENCE ONLY. COMBINATION OF MULTIPLE NUMBERS OF 2 AND 3 SEGMENT MODULES COULD BE USED PER USER PREFERENCE. OVERALL COMBINATION SHOULD NOT EXCEED 8" IN LENGTH.
- 7 ITEMS PROVIDED TO THIS SPECIFICATION TO BE PERMANENTLY IDENTIFIED PER THE FOLLOWING IDENTIFIER:



THIS DRAWING IS A CONTROLLED DOCUMENT.		DWN 01/05/05 R. F. A.				
DIMENSIONS: mm[INCHES]		CHK -				
		TOLERANCES UNLESS OTHERWISE SPECIFIED: 0 PLC ± - 1 PLC ± 0.5[0.020] 2 PLC ± 0.25[0.010] 3 PLC ± - 4 PLC ± - ANGLES ± 0.5°		APVD 01/06/05 D. CHAU PRODUCT SPEC	NAME SOCKET CONNECTOR, CROWN EDGE 6 POSITION POWER, STRAIGHT PN: 286-0052-1**01A	
MATERIAL	FINISH	WEIGHT	SIZE A3	CAGE CODE 00779	DRAWING NO. 6650384	RESTRICTED TO
CUSTOMER DRAWING			SCALE 2:1	SHEET 1 OF 5	REV A1	

4

3

2

1

THIS DRAWING IS UNPUBLISHED. RELEASED FOR PUBLICATION
 © COPYRIGHT - By - ALL RIGHTS RESERVED.

REVISIONS							
LOC	DIST	P	LTR	DESCRIPTION	DATE	DWN	APVD
-	-	-	-	SEE SHEET 1	-	-	-

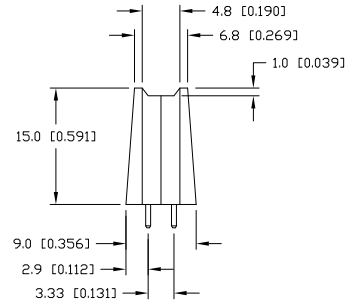
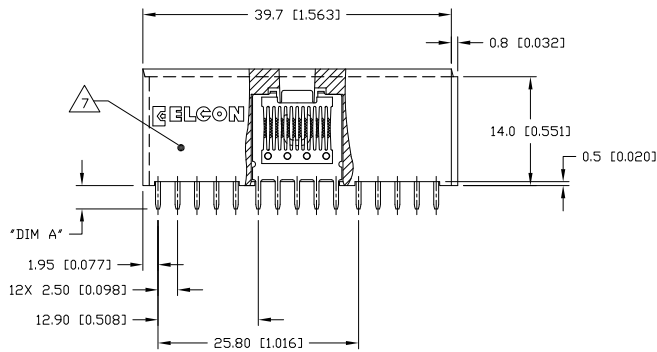
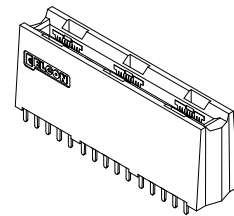
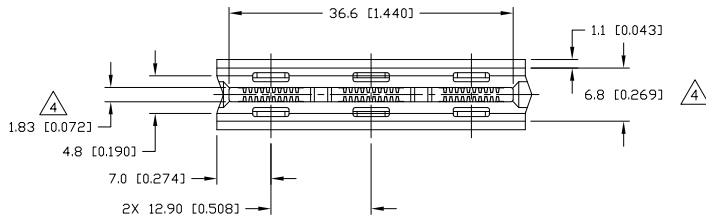

THIS DRAWING IS A CONTROLLED DOCUMENT.

DIMENSIONS: mm[INCHES]	TOLERANCES UNLESS OTHERWISE SPECIFIED:
	0 PLC ± -
	1 PLC ± 0.5[0.020]
	2 PLC ± 0.25[0.010]
	3 PLC ± -
	4 PLC ± -
	ANGLES ± 0.5°
MATERIAL	FINISH
-	-

DWN	R. F. A.	01/05/05
CHK	-	-
APVD	D. CHAU	01/06/05
PRODUCT SPEC	-	-
APPLICATION SPEC	-	-
WEIGHT	-	-
CUSTOMER DRAWING		

TE Connectivity			
NAME SOCKET CONNECTOR, CROWN EDGE 6 POSN POWER, STRAIGHT, SOLDER TAILS PN: 286-0052-12101A			
SIZE	CAGE CODE	DRAWING NO	RESTRICTED TO
A3	00779	6650384	-
SCALE 2:1		SHEET 2 of 5	
		REV A1	

4

3

2

1

THIS DRAWING IS UNPUBLISHED. RELEASED FOR PUBLICATION
 © COPYRIGHT - By - ALL RIGHTS RESERVED.

REVISIONS							
LOC	DIST	P	LTR	DESCRIPTION	DATE	DWN	APVD
-	-	-	-	SEE SHEET 1	-	-	-

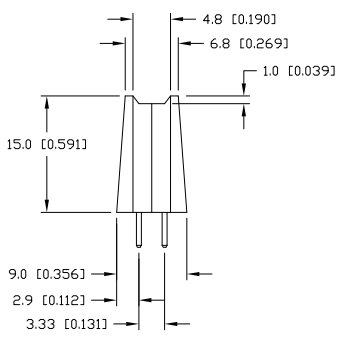
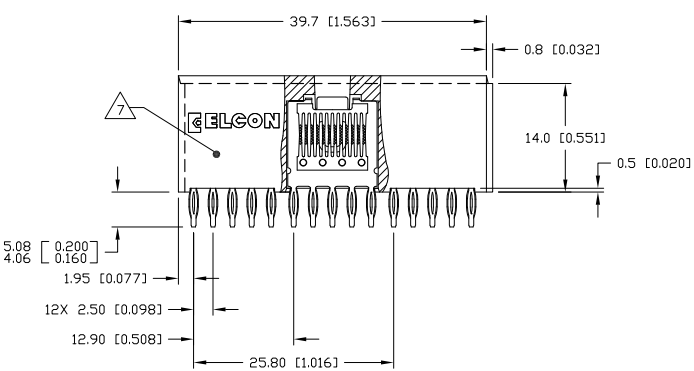
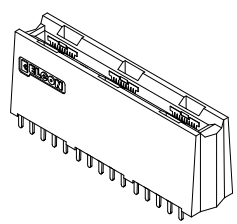
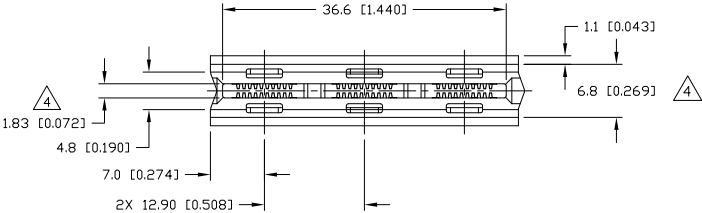

THIS DRAWING IS A CONTROLLED DOCUMENT.		DWN R. F. A.	01/05/05	TE Connectivity
		CHK -	-	
DIMENSIONS: mm[INCHES]		APVD D. CHAU	01/06/05	NAME SOCKET CONNECTOR, CROWN EDGE 6 POSN PWR, STRAIGHT, COMPLIANT TAILS PN: 286-0052-11301A
TOLERANCES UNLESS OTHERWISE SPECIFIED: 0 PLC ± - 1 PLC ± 0.5[0.020] 2 PLC ± 0.25[0.010] 3 PLC ± - 4 PLC ± - ANGLES ± 0.5°		PRODUCT SPEC -		
MATERIAL -		APPLICATION SPEC -		SIZE A3
FINISH -		WEIGHT -		CAGE CODE 00779
		DRAWING NO 6650384		RESTRICTED TO -
CUSTOMER DRAWING			SCALE 2:1	SHEET 3 of 5
			REV A1	

4

3

2

1

THIS DRAWING IS UNPUBLISHED. RELEASED FOR PUBLICATION
 © COPYRIGHT - By - ALL RIGHTS RESERVED.

LOC		DIST		REVISIONS				
P	LTR	DESCRIPTION		DATE	DWN	APVD		
-	-	SEE SHEET 1		-	-	-		

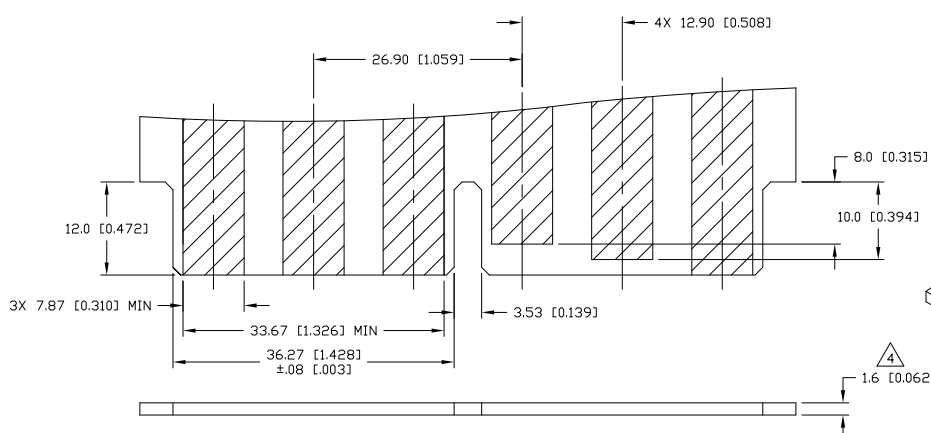

△ 6 DOUBLE SIDED P.C.B. CARD

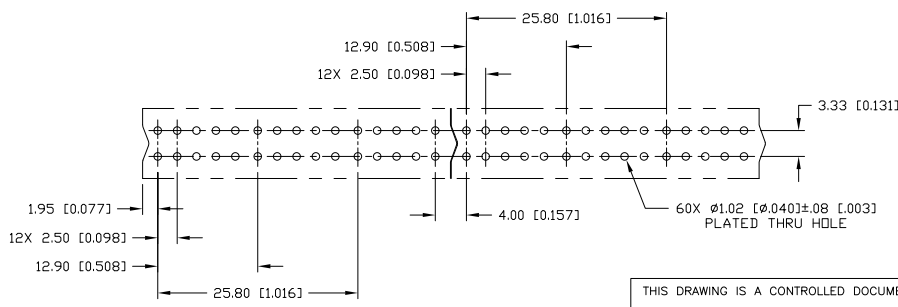
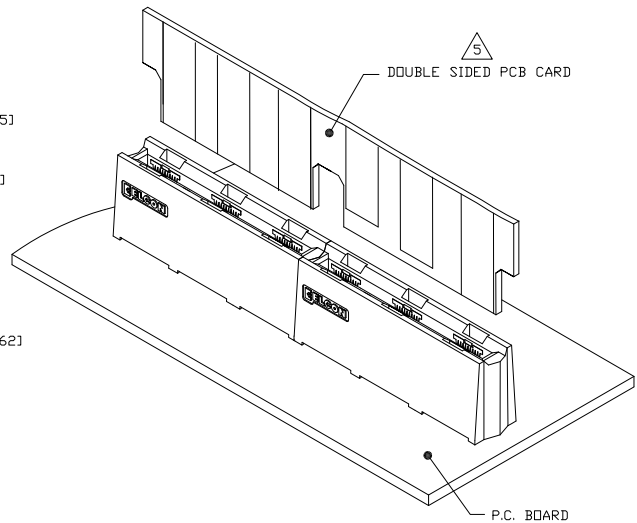

△ 6 RECOMMENDED P.C. BOARD LAYOUT

THIS DRAWING IS A CONTROLLED DOCUMENT.		DWN R. F. A.	01/05/05	TE Connectivity RECOMMENDED PCB LAYOUT PN: 286-0052-12101A/-12301A PN: 286-0052-11301A	
DIMENSIONS: mm[INCHES]		CHK -	-		
TOLERANCES UNLESS OTHERWISE SPECIFIED:		APVD D. CHAU	01/06/05	NAME	
0 PLC ± -		PRODUCT SPEC		SIZE	
1 PLC ± 0.5[0.020]		APPLICATION SPEC		CAGE CODE	
2 PLC ± 0.25[0.010]		WEIGHT		DRAWING NO	
3 PLC ± -		CUSTOMER DRAWING		A3	
4 PLC ± -		SCALE		2:1	
ANGLES ± 0.5°		SHEET		4 of 5	
MATERIAL		REV		A1	
FINISH		RESTRICTED TO		-	

4

3

2

1

THIS DRAWING IS UNPUBLISHED. RELEASED FOR PUBLICATION
 © COPYRIGHT - By - ALL RIGHTS RESERVED.

LOC		DIST		REVISIONS				
P	LTR	DESCRIPTION			DATE	DWN	APVD	
-	-	SEE SHEET 1			-	-	-	

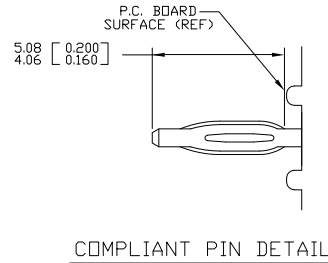
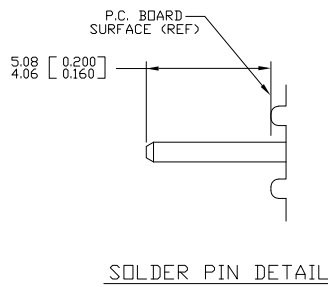
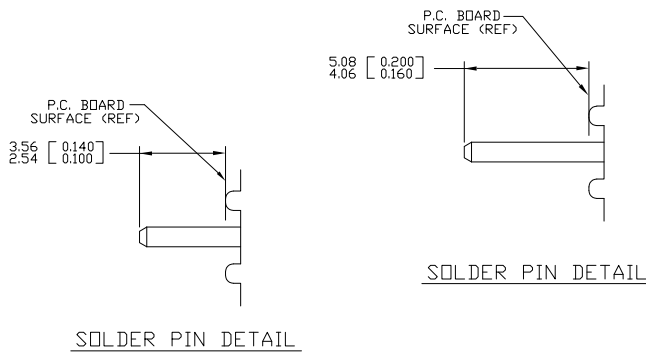

COMPLIANT PIN DETAIL
 INSERTION/EXTRACTION FORCES
 MAXIMUM PUSH-IN: 133.3N PER PIN [30 LBS]
 MINIMUM PUSH-OUT: 44.4N PER PIN [10 LBS]

RECOMMENDED PRINTED CIRCUIT HOLE

FINISHED HOLE: $\phi 1.02 [0.040] \pm 0.08 [0.003]$
 DRILLED HOLE: $\phi 1.15 [0.0453] \pm 0.13 [0.0005]$
 COPPER PLATE: .025 [0.0010] MINIMUM (PER SURFACE)
 TIN PLATE: .008 [0.0003] MINIMUM (PER SURFACE)

THIS DRAWING IS A CONTROLLED DOCUMENT.		DWN	R. F. A.	01/05/05	STE TE Connectivity		
		CHK	-	-			
DIMENSIONS: mm[INCHES]		TOLERANCES UNLESS OTHERWISE SPECIFIED:		APVD	D. CHAU	01/06/05	NAME
		0	PLC	± -	SOCKET CONNECTOR, CROWN EDGE		
		1	PLC	± 0.5[0.020]	USER INFORMATION		
		2	PLC	± 0.25[0.010]	SOLDER & COMPLIANT TAILS TERMINATION		
		3	PLC	± -	RESTRICTED TO		
		4	PLC	± -	APPLICATION SPEC	-	
		ANGLES		± 0.5°	SIZE	A3	
MATERIAL		FINISH		WEIGHT	CAGE CODE	DRAWING NO	
					00779	6650384	
CUSTOMER DRAWING				SCALE	2:1	SHEET	5 of 5
				REV	A1		