

REV		REV		REV		REV		REV	
NO.	DATE	BY	CHKD	DESCRIPTION	DATE	BY	CHKD	DESCRIPTION	DATE
1									
2									
3									

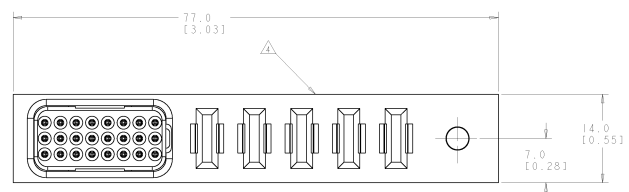

- PART NUMBER CHANGES AND OR DESIGN CHANGES AFFECTING ITEM INTERCHANGEABILITY REQUIRE PRIOR TYCO APPROVAL AND AUTHORIZATION BY REVISION TO THIS DRAWING.
- MATERIAL:
 - INSULATORS - THERMOPLASTIC, GLASS REINFORCED, COLOR: BLACK UL94V-0 FLAMMABILITY RATED.
 - POWER CONTACTS - PHOSPHOR BRONZE ALLOY, COPPER ALLOY
 - CROWN BANDS - BERYLLIUM COPPER ALLOY
 - SIGNAL CONTACTS - PHOSPHOR BRONZE ALLOY
 - GUIDE PIN: TELLURIUM COPPER ALLOY
- FINISH:
 - CONTACTS - GOLD PLATE 0.76µm MIN. THK., OVER NICKEL 1.27µm MIN THK.
 - COMPLAINT TAILS TIN/LEAD, 1.02µm MIN. THK. OVER NICKEL 1.27µm MIN THK.
 - GUIDE PIN - SILVER PLATE 5.08µm MIN THK. OVER NICKEL 1.02µm MIN THK.

△ ITEMS PROVIDED TO THIS SPECIFICATION TO BE PERMANENTLY IDENTIFIED PER THE FOLLOWING IDENTIFIER LABEL

TYCO PART NO. DATE CODE YEAR WEEK
 XXXXXXX-A XXXX (e.g. 0106)

△ ACTIVATED GUIDE PIN ACCEPTS #4-40 SCREWS (USER SUPPLIED).

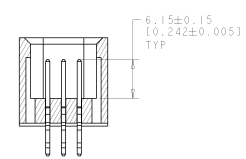
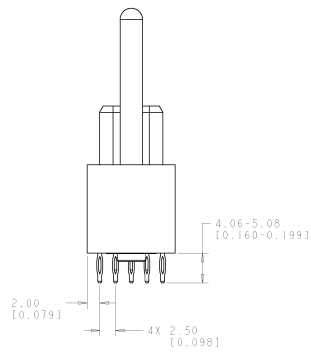
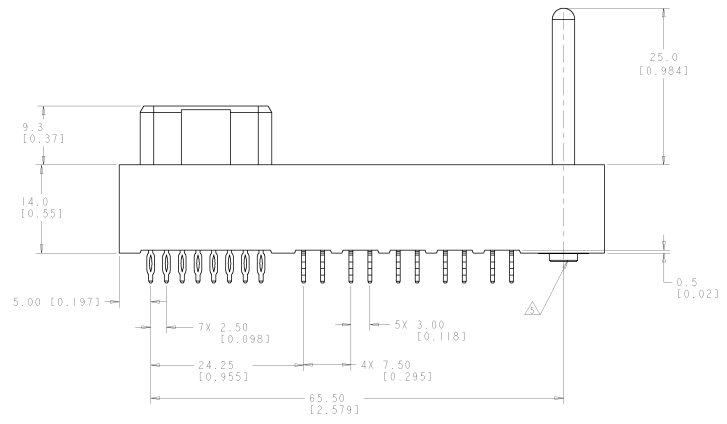

SECTION Z-Z
 GENDER CHANGER REMOVED FOR CLARITY

ELCON FLATPAQ

AS SHOWN	1646571-1
DESCRIPTION	PART NUMBER
SOCKET CONNECTOR STRAIGHT, COMPLAINT TAIL FLATPAQ	
TYCO PART NO.	DATE CODE
XXXXXX-A	XXXX
YEAR WEEK (e.g. 0106)	

8	7	6	5	4	3	2	1
DATE MANUFACTURE TO BE OBSERVED		REVISIONS FOR IDENTIFICATION					
BY THE CUSTOMER		BY THE ELECTRONICS CORPORATION, ALL RIGHTS RESERVED					

REV	DATE	DESCRIPTION	BY	CHK	APP
00		SEE SHEET 1			

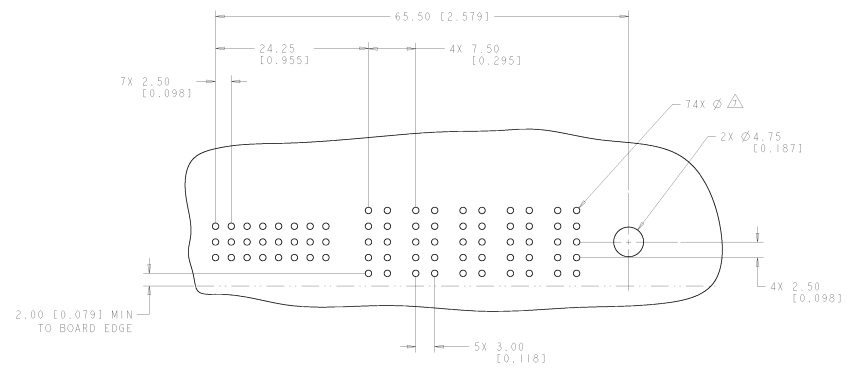

PRINTED CIRCUIT LAYOUT

CONNECTOR	CATALOG MODULE #	QTY	SIZE NO.	CONTACT QTY	MATING PIN	MAX. CURRENT (PER CONTACT)	CONTACT SPACING	VOLTAGE RATING
SOCKET	DEDICATED HOUSING	1	8	5	1.25 X 7.00 1.049 X .216	35 amps	7.50 [0.2953]	250
			22	24	.64 [0.025] SQ.	3 amps	2.50 [0.0984]	125 VOLTS

ELCON FLATPAQ

APPROVED FOR MANUFACTURE BY: _____ DATE: _____		APPROVED FOR MANUFACTURE BY: _____ DATE: _____		tyco electronics Tyco Electronics Corporation, PA 19108-0808	
PART NO. 1646571-001 REV. 001		PART NO. 1646571-001 REV. 001		SOCKET CONNECTOR STRAIGHT, COMPLIANT TAIL FLATPAQ	
MATERIAL: _____		FINISH: _____		PART NO. 1646571-001 REV. 001	
CUSTOMER DRAWING: _____		CUSTOMER DRAWING: _____		PART NO. 1646571-001 REV. 001	

REV	DATE	DESCRIPTION	BY	CHK	APP
00		SEE SHEET 1			

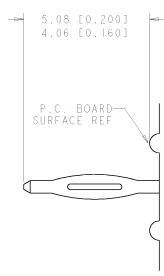

6. COMPLIANT PIN DETAIL
 SCALE 10:1
 INSERTION/EXTRACTION FORCES
 MAXIMUM PUSH IN: 133.3N (30 LBS) PER PIN
 MINIMUM PUSH OUT: 44.4N (10 LBS) PER PIN

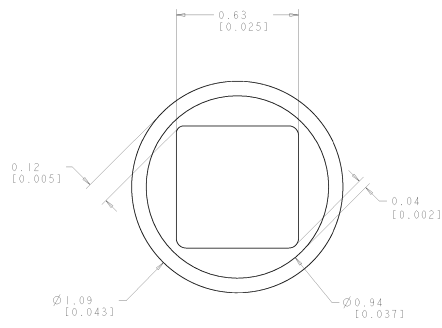

△ SOLDER TERMINATION AREA
 SCALE 40:1
 RECOMMENDED PRINTED CIRCUIT SOLDER HOLE
 COMPLIANT PRESS FIT
 DRILLED HOLE: $\varnothing 1.15 [0.0453] \pm .013 [0.0005]$
 COPPER PLATE: .025 (.0010) MIN (PER SIDE)
 TIN PLATE: .0005 [0.00020] MIN. (PER SURFACE)

ELCON FLATPAQ

ELCON ELECTRONICS CORPORATION 1000 EAST 10TH AVENUE PITTSBURGH, PA 15203-1500		Tyco Electronics Tyco Electronics Harrisburg, PA 17105-0000	
PART NUMBER: 164571 PART NAME: SOCKET CONNECTOR STRAIGHT COMPLIANT TAIL FLATPAQ	QUANTITY: 1000 UNIT WEIGHT: 0.0001 GROSS WEIGHT: 0.1000 NET WEIGHT: 0.0000	PART NUMBER: 164571 PART NAME: SOCKET CONNECTOR STRAIGHT COMPLIANT TAIL FLATPAQ	PART NUMBER: 164571 PART NAME: SOCKET CONNECTOR STRAIGHT COMPLIANT TAIL FLATPAQ
MATERIAL: 164571 FINISH: 164571	PART NUMBER: 164571 PART NAME: SOCKET CONNECTOR STRAIGHT COMPLIANT TAIL FLATPAQ	PART NUMBER: 164571 PART NAME: SOCKET CONNECTOR STRAIGHT COMPLIANT TAIL FLATPAQ	PART NUMBER: 164571 PART NAME: SOCKET CONNECTOR STRAIGHT COMPLIANT TAIL FLATPAQ