

REV. NO.	DATE	DESCRIPTION	BY	CHK	APP
A1	200612007	NEW DRAWING - PRELIMINARY	ER	OK	
A2	2007008	NEW DRAWING PUBLISHED	ER	OK	
A3	2007009	5 AND -8 ADD. PACK. REVOR. (PCN 1-09-00002)	ER	OK	

POTENTIAL OF VERSIONS CABLE OUTLET
MOEGLICHE VARIANTEN KABELABGANG

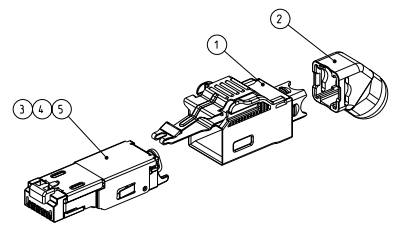

MOUNTED STATE - FOR INFORMATION ONLY
MONTIERTER ZUSTAND - NUR ZUR INFORMATION

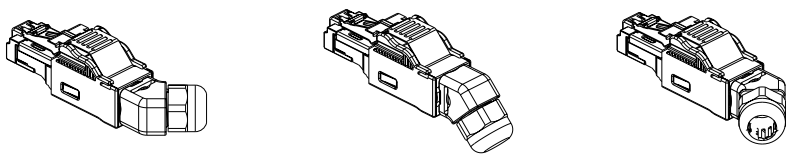
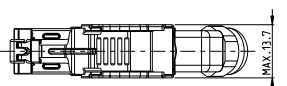
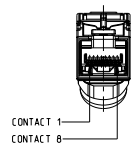
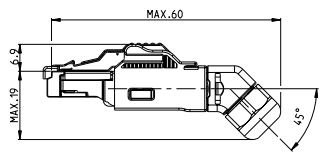

COLOR ALLOCATION OF TERMINAL WIRE TO RJ45 CONTACT 4 POS. TYPE:
FARBZUORDNUNG DES ANSCHLUSSDRAHTES ZUM RJ45-KONTAKT 4 POL. AUSFUEHRUNG:

CONTACT NO./NR.	WIRE COLOR DRAHTFARBE
1	YELLOW GELB
2	ORANGE ORANGE
3	WHITE WEISS
6	BLUE BLAU

COLOR ALLOCATION OF TERMINAL WIRE TO RJ45 CONTACT 8 POS. TYPE:
FARBZUORDNUNG DES ANSCHLUSSDRAHTES ZUM RJ45-KONTAKT 8 POL. AUSFUEHRUNG:

CONTACT NO./NR.	WIRE COLOR DRAHTFARBE
1	WHITE/GREEN WEISS/GRUEN
2	GREEN GRUEN
3	WHITE/ORANGE WEISS/ORANGE
4	BLUE BLAU
5	WHITE/BLUE WEISS/BLAU
6	ORANGE ORANGE
7	WHITE/BROWN WEISS/BRAUN
8	BROWN BRAUN

RECOMMENDED STRIPPING LENGTH
EMPFOHLENE ABISOLIERLAENGE

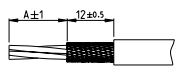

LENGTH LÄNGE	1987236-3, -4 CORE B P.	1987236-1, -2 CORE 4 P.	1987236-5, -8 COMMON CORE B P., GIGABIT SER. HIGH P.P., GIGABIT
A	15	15	18

- △ SINGLE PACKING: BLISTER PACKAGE WITH INSTRUCTION SHEET.
- △ MULTI PACKING: 50 PIECE ITEM NO. 1 IN FOLDING BOX + 50 PIECE ITEM NO. 2 IN PLASTIC BAG (MINI GRIP) + 50 PIECE ITEM NO. 3 OR 4 OR 5 IN FOLDING BOX PACKED IN CORRUGATED SHIPPING BOX WITH INSTRUCTION SHEET.
- △ EINZELVERPACKUNG: BLISTERVERPACKUNG MIT VERARBEITUNGSANWEISUNG.
- △ MEHRFACHVERPACKUNG: 50 STUECK POS. 1 IN FALTSCHACHEL + 50 STUECK POS. 2 IN KUNSTSTOFFBEUTEL (MINI GRIP) + 50 STUECK POS. 3 ODER 4 ODER 5 IN FALTSCHACHEL VERPACKT IN VERSANDKARTON MIT VERARBEITUNGSANWEISUNG.

TYCO ELECTRONICS ORDER NO. BESTELL-NR.	QUANTITY STUECK	ITEM NO. POS.	DESCRIPTION BENEANUNG
1987236-0	50	1	CORNER CORE B P., GIGABIT SER. HIGH P.P., GIGABIT
1987236-1	50	1	CORE 4P ASSY
1987236-2	50	1	CORE 4P ASSY
1987236-3	50	1	CORE 4P ASSY
1987236-4	50	1	CORE 4P ASSY
1987236-5	50	1	CORE 4P ASSY
1987236-6	50	1	CORE 4P ASSY
1987236-7	50	1	CORE 4P ASSY
1987236-8	50	1	CORE 4P ASSY

TYCO ELECTRONICS
 6445 Sankeln Germany
 RJ45 CONNECTOR IP20 45 DEG.
 INDUSTRIAL ETHERNET
 RJ45 STECKER IP20 45 GRAD
 007719 CS-1987236
 CUSTOMER DRAWING