

REV	DATE	DESCRIPTION	BY	CHK	APP
C	REV: ECO-08-030243		SHOENH	JB	SA
D	REV: ECO-11-024234		SHOENH	JB	SA

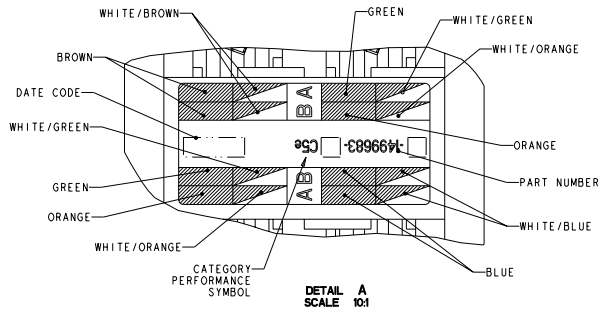

- △ MATERIAL: JACK HOUSING - POLYCARBONATE, 94V-0 RATED, 110 BLOCK AND STRAIN RELIEF - POLYCARBONATE, ARRAY TRAY - PBT POLYESTER.
- JACK CONTACTS ARRAY - BERYLLIUM COPPER, PLATED WITH 1.27µm (.00050) MINIMUM THICK GOLD IN LOCALIZED AREA AND 3.81µm (.00150) MINIMUM THICK WHITE TIN IN BOARD INTERFACE AREA OVER 1.27µm (.00050) MINIMUM THICK NICKEL UNDERPLATE.
- IDC TERMINALS - PHOSPHOROUS BRONZE, PLATED WITH 3.81µm (.0015) MINIMUM THICK WHITE TIN OVER 1.27µm (.0005) MINIMUM THICK NICKEL UNDERPLATE.
- 2. KLS JACK WILL TERMINATE 22-24 AWG SOLID CONDUCTORS, 1.27(.050) MAXIMUM INSULATION DIAMETER. JACK WILL ACCEPT CONDUCTORS UP TO 1.45 (.057) BUT REQUIRE THE USE OF A STRAIN RELIEF.
- △ CAVITY CONFORMS TO FCC RULES AND REGULATIONS PART 68 SUBPART F REQUIREMENTS.
- △ ONE MODULAR JACK ASSEMBLY AND ONE STRAIN RELIEF PER POLYBAG. USE OF STRAIN RELIEF IS OPTIONAL.
- △ USE IS OPTIONAL.
- 6. REFER TO 408-8858 FOR TERMINATION INSTRUCTIONS USING SL SERIES TOOL. TERMINATION: REFER TO 408-8417 FOR TERMINATION INSTRUCTIONS USING 110 PUNCH DOWN TOOL.

DETAIL A
SCALE 10:1

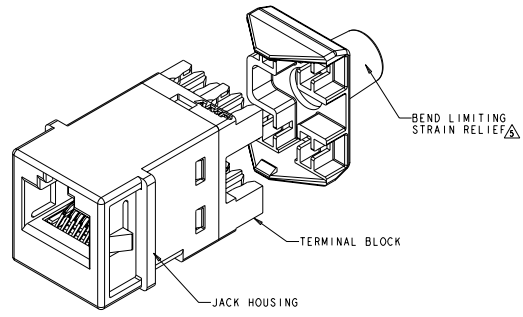
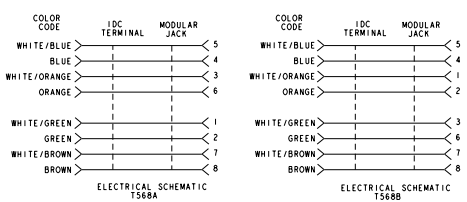
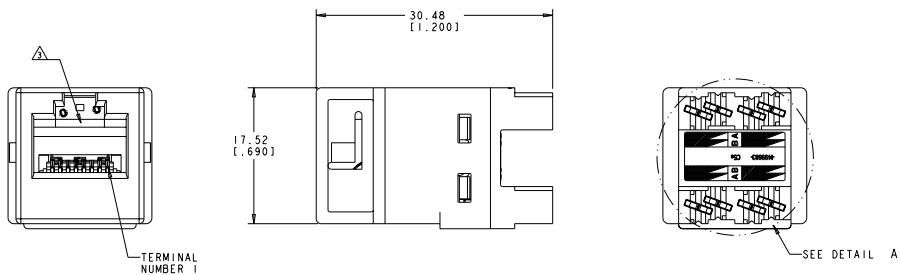

PACKAGE	HOUSING COLOR	PART NUMBER
△	ELECTRIC IVORY	1499683-1
	VIOLET	1499683-0
	GREEN	1499683-9
	YELLOW	1499683-8
	RED	1499683-7
	BLUE	1499683-6
	ORANGE	1499683-5
	NEVA GRAY	1499683-4
	WHITE	1499683-3
	BLACK	1499683-2
	LIGHT ALMOND	1499683-1

THIS DRAWING IS A CONTROLLED DOCUMENT. MICHEL 20F02006
 DATE 20F02006
 P. FILE 20F02006
 P. FILE 20F02006
 ASSEMBLY, CAT5e, UTP, KLS SERIES

STATE CASE CODE DRAWING NO. 00779 © 1499683
 CUSTOMER DRAWING

DATE 2-11-12