

THIS DRAWING IS UNPUBLISHED
 ALL RIGHTS RESERVED

REV	DATE	DESCRIPTION	BY	CHK	APP
GP 00					
A1		REVISED PER EDD-11-004835			

- ⚠ MOLDED PARTS: GLASS FILLED NYLON, UL94V-0 RATED, COLOR BLACK.
- SHELLS & BRACKETS: CARBON STEEL.
- CONTACTS: PHOS BRONZE
- SCREWLOCKS AND WASHERS: CARBON STEEL.
- ⚠ SHELLS: .000200 MIN TIN OVER .000100 MIN COPPER.
- BRACKETS: .000200 MIN TIN OVER .000050 MIN COPPER.
- SCREWLOCKS AND WASHERS: ZINC PLATED WITH CLEAR CHROMATE COATING.
- CONTACTS: SEE TABLE.
- ⚠ GOLD FLASH FOR A LENGTH OF .100 MINIMUM FROM MATING END, .000100 MINIMUM TIN ON OPPOSITE END, BOTH OVER .000050 MINIMUM NICKEL.
- ⚠ .000030 MINIMUM GOLD FOR A LENGTH OF .100 MIN FROM MATING END, .000100 MINIMUM TIN ON OPPOSITE END, BOTH OVER .000050 MIN NICKEL.
- OR-
- GOLD FLASH OVER .000030 MINIMUM PALLADIUM NICKEL FOR A LENGTH OF .100 MIN FROM MATING END, .000100 MIN TIN ON OPPOSITE END, BOTH OVER .000050 MIN NICKEL.

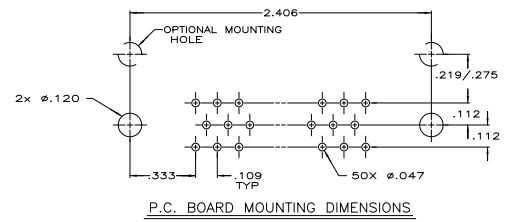
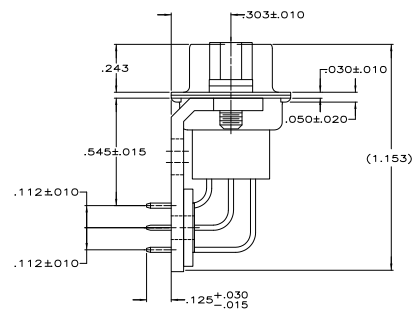
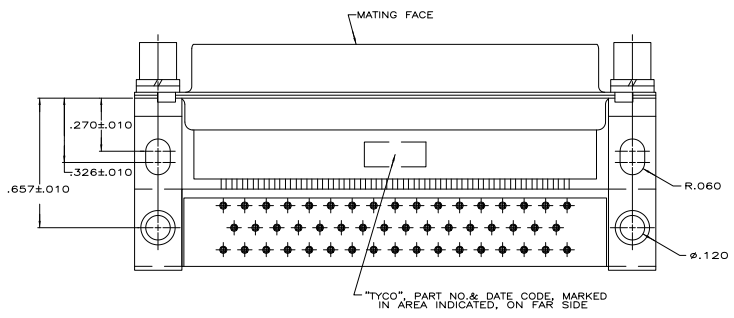
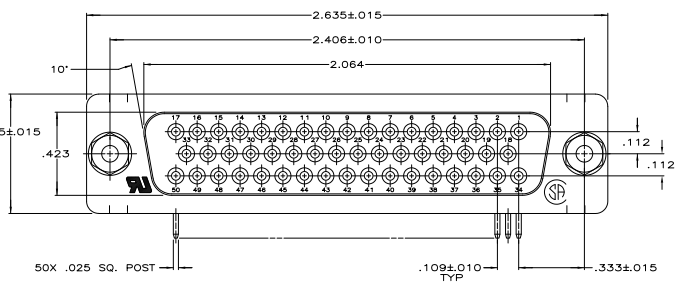

5747193-2	
5747193-1	
CONTACT FINISH	PART NUMBER

THIS DRAWING IS A CONTROLLED DOCUMENT		REV	DATE	DESCRIPTION	BY	CHK	APP
DESIGNED	DESIGNED	GP	00				
APPROVED	APPROVED	A1		REVISED PER EDD-11-004835			

REVISIONS	REV	DATE	DESCRIPTION	BY	CHK	APP
	GP	00				
	A1		REVISED PER EDD-11-004835			

108-40025	114-40013	108-40025	114-40013
-----------	-----------	-----------	-----------

RECEPTACLE ASSEMBLY, SIZE 5, 50 POSITION, RIGHT ANGLE, 540 SERIES, .025 SQ. POSTS, WITH SCREWLOCKS, AMPHANTE 10P	REWORKED TO

CUSTOMER DRAWING	DATE	REV	BY	APP
	4.1	1		A1