

4

3

2

1

THIS DRAWING IS UNPUBLISHED.		RELEASED FOR PUBLICATION		OCT. 1984.	
COPYRIGHT 1984 By -		ALL RIGHTS RESERVED.			
LOC	DIST	REVISIONS			
		P	LTR	DESCRIPTION	DATE
		A2		REVISED PER ECO-11-005030	11MAR11
					DWN
					APVD
					RK
					HMR

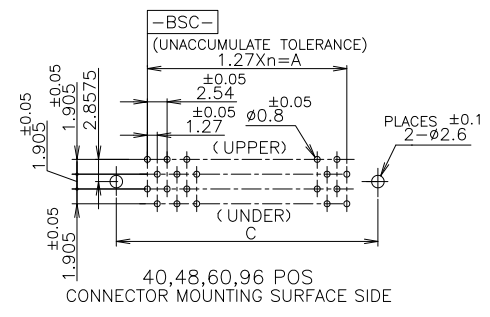
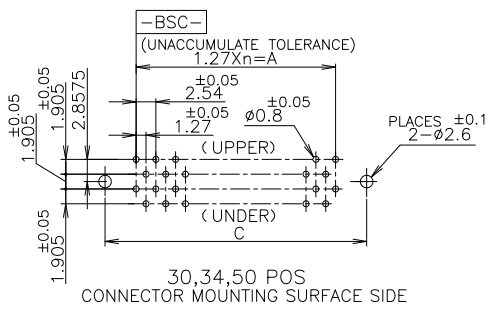
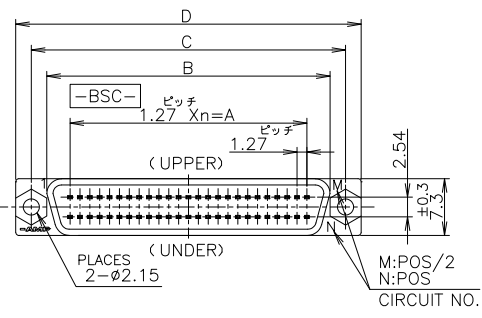
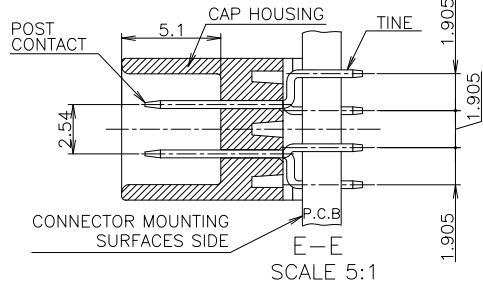
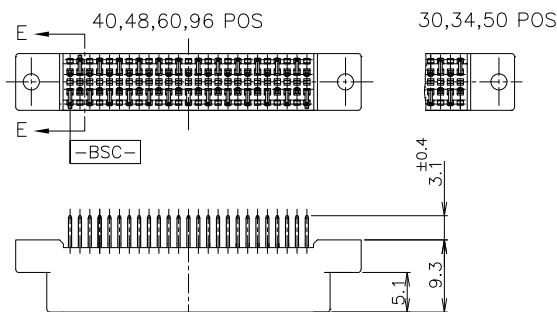

- 1 USE A P.C.B. WHOSE SURFACES ARE TREATED WITH SOLDER RESIST.
 - 2 SHOW P.C.B LAYOUT FROM THE CONNECTOR-MOUNTING SURFACE SIDE.
 - 3 NUMBER THE CONTACTS IN THE P.C.B OR CONNECTOR CONSECUTIVELY FROM THE [-BSC-] SIDE.
 - 4 WHEN SCREWING THE CONNECTOR TO THE P.C.B, USE M2 SCREW, NUT AND WASHERS.
- △ HOUSING MATERIAL : THERMOPLASTICS (UL94-V0). COLOR:BLACK
 △ CONTACT MATERIAL : COPPER ALLOY
 △ FINISH : NICKEL 1.27μ MIN THK. OVERALL SELECTIVE GOLD 0.2μ MIN THK ON CONTACT AREA AND TIN 1μ MIN THK ON TINE AREA.
 △ OBSOLETE PARTS: OBSOLETE CIS STREAMLINING PER D.RENAUD/D.SINISI

△ OBSOLETE	-8	96	47	59.69	65.66	69.66	73.66
	-6	48	23	29.21	35.18	39.18	43.18
△ OBSOLETE	-5	34	16	20.32	26.29	30.29	34.29
	-4	60	29	36.83	42.80	46.80	50.80
	-3	50	24	30.48	36.45	40.45	44.45
	-2	40	19	24.13	30.10	34.10	38.10
	5173280-1	30	14	17.78	23.75	27.75	31.75
	P/N	POS	n	A	B	C	D

GENERAL TOLERANCE	
10 ≥ : ±0.2	
30 ≥ > 10: ±0.25	
100 ≥ > 30: ±0.3	
ANGLES: ±3°	

THIS DRAWING IS A CONTROLLED DOCUMENT.

DIMENSIONS: 単位: 概 MM	TOLERANCES UNLESS OTHERWISE SPECIFIED: 一般公差	DWN T.KAWAMAE	01APROS
		CHK I.NOMOTO	01APROS
		APVD I.NOMOTO	01APROS
		NAME 名	TE Connectivity
		PRODUCT SPEC 製品規格	CAP ASSY VERTICAL
		APPLICATION SPEC 取付適用規格	AMPLIMITE 050 SERIES I B-TO-B CONN.
MATERIAL 材料	FINISH 仕上	SIZE A3	CAGE CODE 00779
		DRAWING NO. 番号	5173280
		RESTRICTED TO	
		CUSTOMER DRAWING	SCALE 尺度 2:1
			SHEET 1 of 3
			REV A2

4

3

2

1

THIS DRAWING IS UNPUBLISHED. RELEASED FOR PUBLICATION OCT. 1984.
 COPYRIGHT 1984 BY - ALL RIGHTS RESERVED.

LOC	DIST	REVISIONS				
P	LTR	DESCRIPTION	DATE	DWN	APVD	
-	-	SEE SHEET 1	-	-	-	

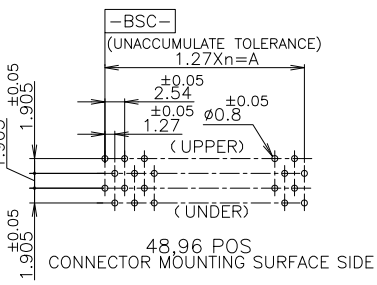
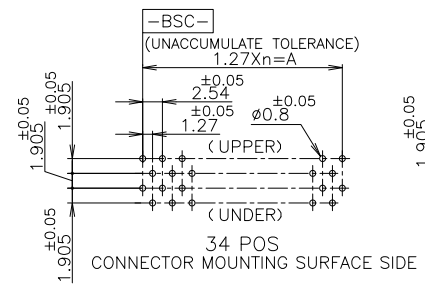
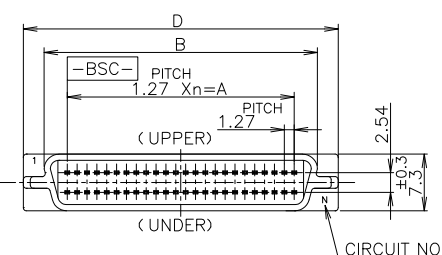
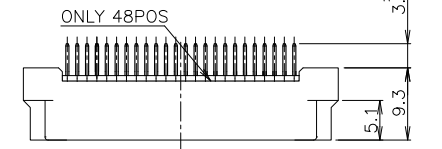
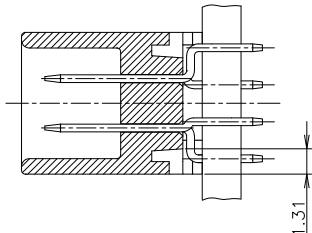
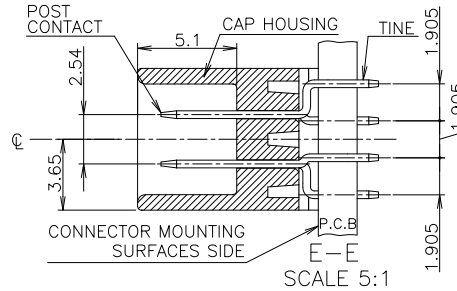
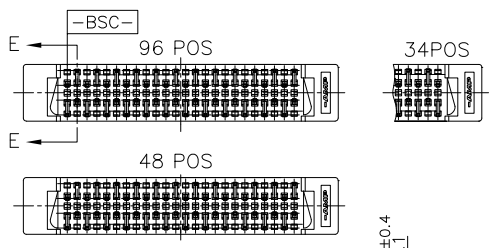

- USE A P.C.B. WHOSE SURFACES ARE TREATED WITH SOLDER RESIST.
- SHOW P.C.B LAYOUT FROM THE CONNECTOR-MOUNTING SURFACE SIDE.
- NUMBER THE CONTACTS IN THE P.C.B OR CONNECTOR CONSECUTIVELY FROM THE [-BSC-] SIDE.

- HOUSING MATERIAL : THERMOPLASTICS (UL94-V0). COLOR:BLACK
- CONTACT MATERIAL : COPPER ALLOY
- FINISH : NICKEL 1.27μ MIN THK, OVERALL SELECTIVE GOLD 0.2μ MIN THK ON CONTACT AREA AND TIN 1μ MIN THK ON TINE AREA.

2-	-8	96	47	59.69	65.66	71.00
2-	-6	48	23	29.21	35.18	40.52
2-5173280-5		34	16	20.32	26.29	31.63
	P/N	極数	n	A	B	D

GENERAL TOLERANCE	
一般公差	
10 ≥	±0.2
30 ≥	> 10: ±0.25
100 ≥	> 30: ±0.3
ANGLES: ±3°	

THIS DRAWING IS A CONTROLLED DOCUMENT.

DIMENSIONS: 單位: 毫米	TOLERANCES UNLESS OTHERWISE SPECIFIED: 一般公差	DWN	CHK	APVD	NAME 名稱
0 PLC ±	1 PLC ±				TE Connectivity CAP ASSY VERTICAL AMPLIMITE .050 SERIES I B-TO-B CONN.
2 PLC ±	3 PLC ±				
4 PLC ±	ANGLES ±				SIZE
MATERIAL 材料	FINISH 仕上				CAGE CODE
SEE-△△	SEE-△				DRAWING NO 番号
					RESTRICTED TO
					5173280
					CUSTOMER DRAWING
					SCALE 尺度
					2:1
					SHEET
					2 of 3
					REV
					A2

4

3

2

1

THIS DRAWING IS UNPUBLISHED. RELEASED FOR PUBLICATION OCT. 1984.
 © COPYRIGHT 1984 BY - ALL RIGHTS RESERVED.

LOC	DIST	REVISIONS				
P	LTR	DESCRIPTION	DATE	DWN	APVD	
-	-	SEE SHEET 1	-	-	-	

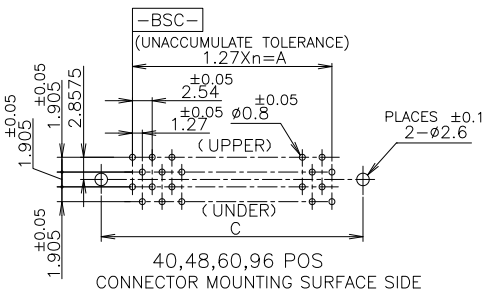
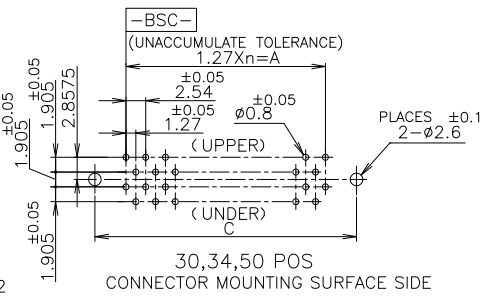
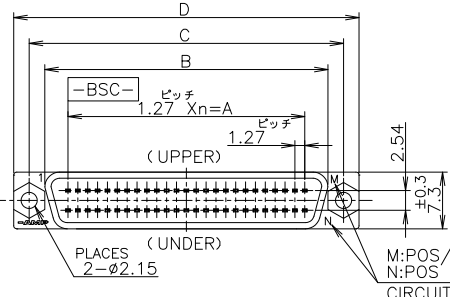
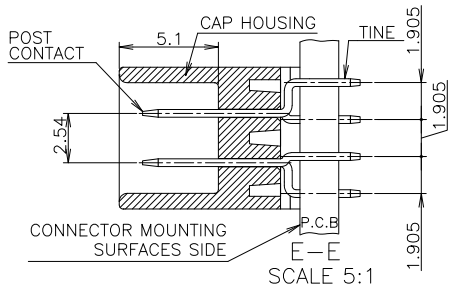
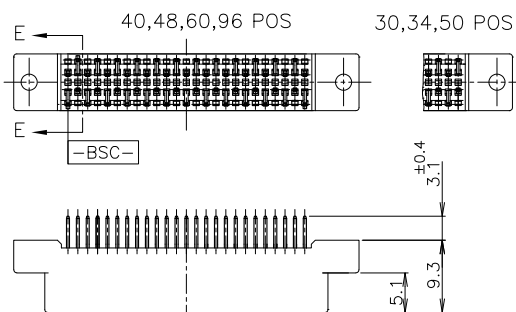

- 1 USE A P.C.B. WHOSE SURFACES ARE TREATED WITH SOLDER RESIST.
 - 2 SHOW P.C.B LAYOUT FROM THE CONNECTOR-MOUNTING SURFACE SIDE.
 - 3 NUMBER THE CONTACTS IN THE P.C.B OR CONNECTOR CONSECUTIVELY FROM THE [BSC] SIDE.
 - 4 WHEN SCREWING THE CONNECTOR TO THE P.C.B, USE M2 SCREW, NUT AND WASHERS.
- △ HOUSING MATERIAL : THERMOPLASTICS (UL94-V0). COLOR:BLACK
 △ CONTACT MATERIAL : COPPER ALLOY
 △ FINISH : NICKEL 1.27µ MIN THK. OVERALL SELECTIVE GOLD 0.76µ MIN THK ON CONTACT AREA AND TIN 1µ MIN THK ON TINE AREA.

P/N	POS	n	A	B	C	D	
6-	-8	96	47	59.69	65.66	69.66	73.66
6-	-6	48	23	29.21	35.18	39.18	43.18
6-	-5	34	16	20.32	26.29	30.29	34.29
6-	-4	60	29	36.83	42.80	46.80	50.80
6-	-3	50	24	30.48	36.45	40.45	44.45
6-	-2	40	19	24.13	30.10	34.10	38.10
6-5173280-1	30	14	17.78	23.75	27.75	31.75	

GENERAL TOLERANCE
 一般公差

10 ≥ : ±0.2
 30 > 10 : ±0.25
 100 ≥ > 30 : ±0.3
 ANGLES : ±3°

THIS DRAWING IS A CONTROLLED DOCUMENT.

DIMENSIONS:	TOLERANCES UNLESS OTHERWISE SPECIFIED:
単位: 概	一般公差
MM	
0 PLC	± -
1 PLC	± -
2 PLC	± -
3 PLC	± -
4 PLC	± -
ANGLES	± -

MATERIAL 材料 SEE 参照
 FINISH 仕上 SEE 参照

TE Connectivity

CAP ASSY VERTICAL
 AMPLIMITE .050 SERIES I B-TO-B CONN.

SIZE: A3 CAGE CODE: 00779 DRAWING NO: 5173280

CUSTOMER DRAWING SCALE: 2:1 SHEET: 3 OF 3 REV: A2