

DO NOT SCALE
DIMENSIONS IN mm

METRIC

THIRD ANGLE PROJECTION

NOTES:

- △ FOR USE ON STANDARD APPLICATORS.(RIGHT-LEFT FEED)
- △ FOR USE ON MINIATURE APPLICATORS.(LEFT-RIGHT FEED)
- △ FOR USE ON MINIATURE APPLICATORS, AMP O-MATOR APPLICATION.(LEFT-RIGHT FEED)
- △ OBSOLETE PARTS: OBSOLETE CIS STREAMLINING PER D.RENAUD/D.SINISI

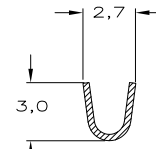
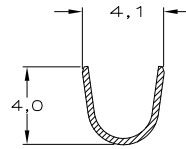
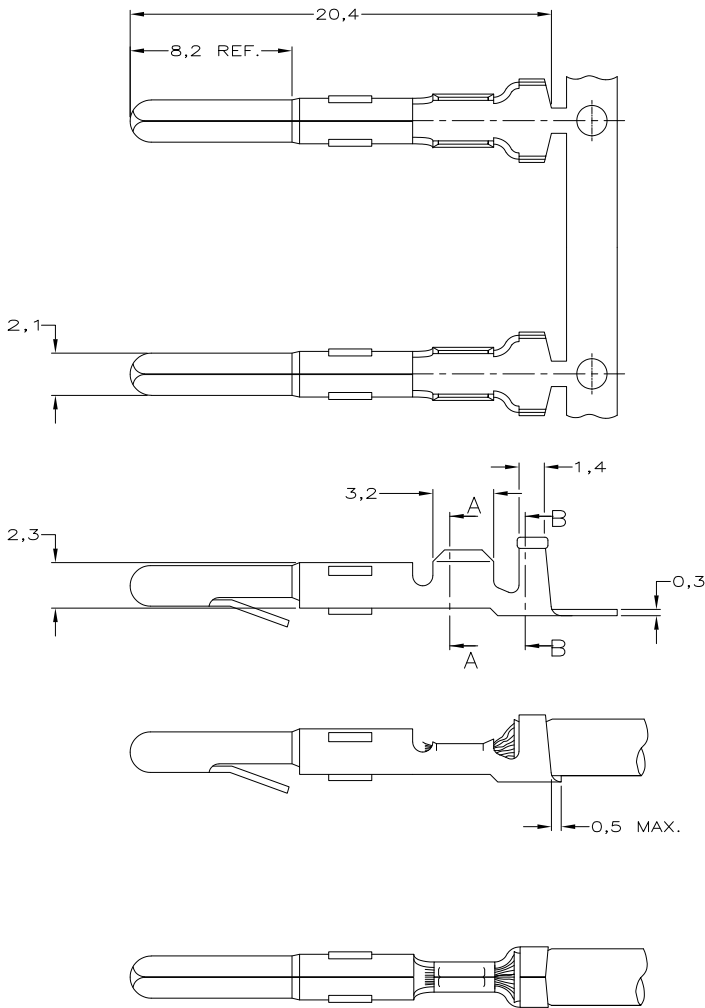

WIRE RANGE :
0,5-1,0mm² AWG
INSULATION RANGE :
1,8-3,3mm DIA.

OBSOLETE		SEL.	GOLD	-	8-163301-3
△ 4	△ 3			BRASS	1-163301-7
	△ 2	NICKEL		BRASS	1-163301-2
	△ 1	NICKEL		BRASS	1-163301-1
	△ 2	PRE-TINPLATED		PHOSPHOR BR.	163301-8
△ OBSOLETE	△ 2	UNPLATED		PHOSPHOR BR.	163301-7
	△ 2	PRE-TINPLATED		BRASS	163301-6
△ OBSOLETE	△ 2	UNPLATED		BRASS	163301-5
	△ 1	PRE-TINPLATED		PHOSPHOR BR.	163301-4
	△ 1	UNPLATED		PHOSPHOR BR.	163301-3
SUP BY 163301-6	△ 1	PRE-TINPLATED		BRASS	163301-2
	△ 1	UNPLATED		BRASS	163301-1
		PLATING		MATERIAL	PARTNUMBER

K2 REVISED PER ECO-11-05294				RK	HMR	05APR11	CUSTOMER DRAWING FOR REFERENCE ONLY WILL NOT BE UPDATED	
DR.: J.V.D.HEIJDEN				CHK.: A.BIJNEN	APP.: L.V.SOEST.		© COPYRIGHT 19 - BY -	
DATE: 10-04-92				DATE: -	DATE: -		ALL INTERNATIONAL RIGHTS RESERVED.	
							THIS DRAWING IS UNPUBLISHED RELEASED FOR PUBLICATION	
							TE Connectivity NAME PIN MATE-N-LOK.	
							DWG.No. C-163301	
							REV.LTR. K2	SHEET 1 OF 1
							A3	