

4

3

2

1

THIS DRAWING IS UNPUBLISHED. RELEASED FOR PUBLICATION. BY TYCO ELECTRONICS CORPORATION. ALL RIGHTS RESERVED.

LOC	DIST	REVISIONS				
FT	0	P	LTR	DATE	MIN	APPRO
		J	REVISED PER	0638-0178-05	4/19/05	SS GS

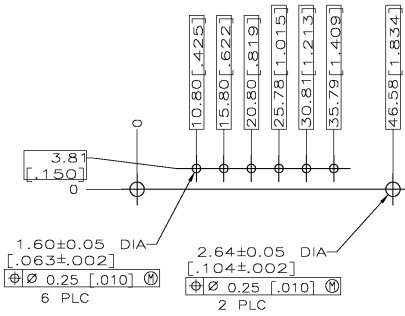
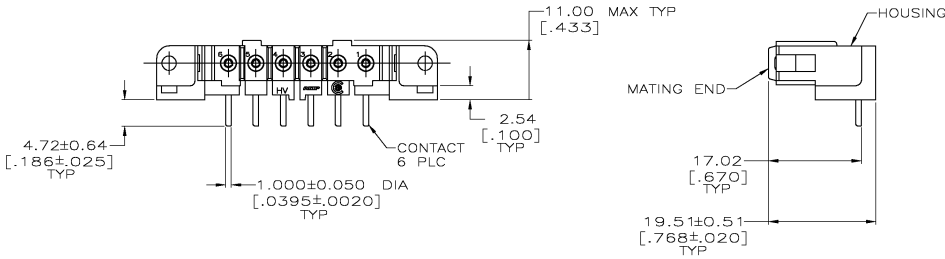
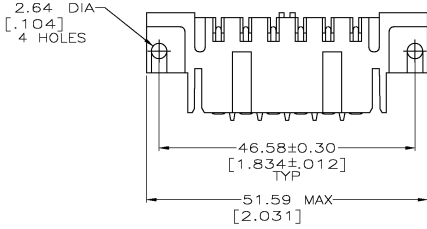

RECOMMENDED PC BOARD LAYOUT

- △ 3.81um [.000150] MIN TIN-LEAD OVER 0.76um [.000030] MIN NICKEL.
- △ 0.76um [.000030] MIN GOLD FOR A LENGTH OF 5.08 [.200] MIN FROM MATING END, 3.81um [.000150] MIN TIN-LEAD FOR A LENGTH OF 5.23 [.206] MIN FROM OPPOSITE END, BOTH OVER 1.27um [.000050] MIN NICKEL.
- △ 3.81um [.000150] MIN TIN OVER 0.76um [.000030] MIN NICKEL.
- △ 0.76um [.000030] MIN GOLD FOR A LENGTH OF 5.08 [.200] MIN FROM MATING END, 3.81um [.000150] MIN TIN FOR A LENGTH OF 5.23 [.206] MIN FROM OPPOSITE END, BOTH OVER 1.27um [.000050] MIN NICKEL.

△	207610-7
△	207610-6
△	207610-3
△	207610-1
CONTACT FINISH	PART NUMBER

THIS DRAWING IS A CONTROLLED DOCUMENT.		DATE	BY	CHK	APP	DATE	BY	CHK	APP	DATE	BY	CHK	APP
DIMENSIONS:		INCHES											
MATERIAL:		HSG: NYLON, RED											
FINISH:		CONTACTS: SEE TBL											
DRAWN:		L. SIPE											
CHECKED:		M. McCLINTON											
APPROVED:		A. TRAVIS											
PRODUCT SPEC:		108-10033											
APPLICATION SPEC:													
WEIGHT:													
CUSTOMER DRAWING													
SHEET		A2	CASE CODE		00779	DRAWING NO		207610		RESTRICTED TO			
SCALE		2:1	SHEET		1	OF		1		REV		J	