

4

3

2

1

THIS DRAWING IS UNPUBLISHED. RELEASED FOR PUBLICATION
 BY TYCO ELECTRONICS CORPORATION. ALL RIGHTS RESERVED.

LOC	DIST	REVISIONS					
FT	O	F	LN	DESCRIPTION	DATE	BY	APPD
		L1		REVISED PER ECO-08-029974	03DEC08	HMR	GS
		L2		REVISED PER ECO-10-000443	13JAN10	KK	AEG

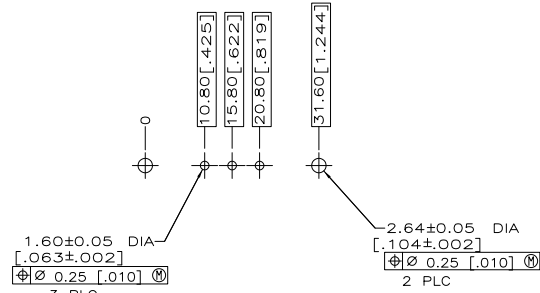
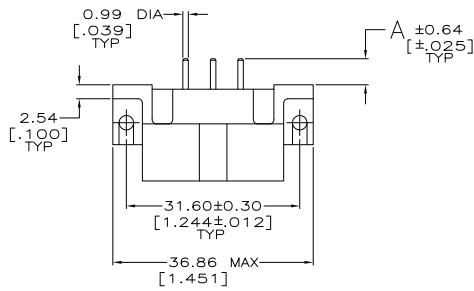

RECOMMENDED PC BOARD LAYOUT

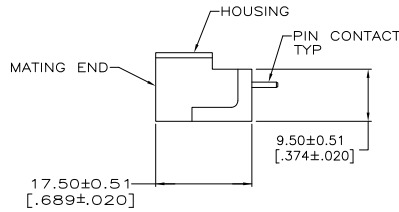
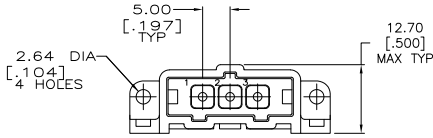

- 1 NYLON, RED.
- 2 BRASS PER ASTM B36.
- 3 3.81µm [.000150] MIN TIN-LEAD OVER 2.54µm [.000100] MIN COPPER OR 1.27µm [.000050] MIN NICKEL.
- 4 0.76µm [.000030] MIN GOLD FOR A LENGTH OF 5.08 [.200] MIN FROM MATING END 3.81µm [.000150] MIN TIN-LEAD FOR A LENGTH OF 5.36 [.211] MIN FROM OPPOSITE END, BOTH OVER 1.27µm [.000050] MIN NICKEL.
- 5 .000150 MIN TIN OVER .000100 MIN CU, OR .000050 MIN NICKEL.
- 6 0.76µm [.000030] MIN GOLD FOR A LENGTH OF 5.08 [.200] MIN FROM MATING END 3.81µm [.000150] MIN TIN FOR A LENGTH OF 5.36 [.211] MIN FROM OPPOSITE END, BOTH OVER 1.27µm [.000050] MIN NICKEL.
- 7 PRELIMINARY PART NUMBER.
- 8 OBSOLETE PARTS: OBSOLETE CIS STREAMLINING PER D.RENAUD/D.SINISI

7	3.50 [.137]	6	1-207365-0
8	7.52 [.296]	6	-207365-9
	4.72 [.186]	6	207365-8
	4.72 [.186]	5	207365-7
	7.52 [.296]	4	207365-6
	4.72 [.186]	4	207365-3
	4.72 [.186]	3	207365-1
A	FINISH	PART NUMBER	

THIS DRAWING IS A CONTROLLED DOCUMENT.		DATE	07/20/92	Tyco Electronics Corporation Harrisburg, Pa 17105-3608	
DIMENSIONS: mm [INCHES]	DESIGNER: J. STONE	CHK:	7-24-92	PIN HEADER ASSEMBLY, 3 POSN, IN-LINE, SMALL METRIC CONNECTOR, METRIMATE	
0 PLC	1	APPROVED:	A. TRAVIS	SIZE	A2
1 PLC	2	PRODUCT SPEC:		QTY	00779
2 PLC	3	APPLICATION SPEC:		DATE	07/20/92
3 PLC	4	WEIGHT:		SCALE	2:1
4 PLC	5	CONTACTS: SEE TABLE		SHEET	1 OF 1
MATERIAL:	HOUSING: 1	CONTACTS: 2		REV	L2
FINISH:					