

4

3

2

1

THIS DRAWING IS UNPUBLISHED. RELEASED FOR PUBLICATION. ALL RIGHTS RESERVED.

LOC		REVISONS		DATE	BY	APP'D
FT	0	F	LR			
		S2		11MAR11	RK	HMR
		REVIS PER ECO-11-004917				

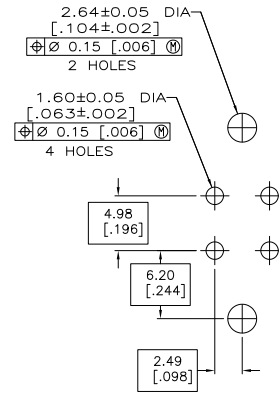
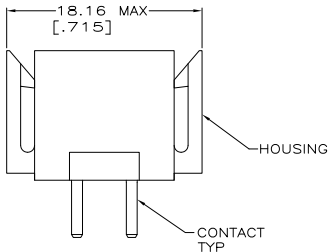
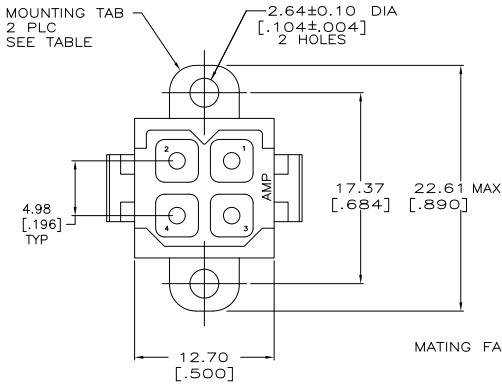

RECOMMENDED PC BOARD LAYOUT

- ▲ NYLON, UL 94V-0 RATED, RED.
- ▲ BRASS PER ASTM B36.
- ▲ 3.81µm [.000150] MIN TIN OVER 2.54µm [.000100] MIN COPPER.
- ▲ 0.76µm [.000030] MIN GOLD FOR A LENGTH OF 5.08 [.200] FROM MATING END, 3.81µm [.000150] MIN TIN FOR A LENGTH OF 4.83 [.190] MIN FROM OPPOSITE END, BOTH OVER 1.27µm [.000050] MIN NICKEL.
- ▲ CONTACTS SELECT LOADED IN POSITIONS 2, 3 AND 4.
- ▲ 3.81µm [.000150] MIN TIN OVER 2.54µm [.000100] MIN COPPER.
- ▲ 0.76µm [.000030] MIN GOLD FOR A LENGTH OF 5.08 [.200] FROM MATING END, 3.81µm [.000150] MIN TIN FOR A LENGTH OF 4.83 [.190] MIN FROM OPPOSITE END, BOTH OVER 1.27µm [.000050] MIN NICKEL.
- ▲ OBSOLETE PARTS: OBSOLETE CIS STREAMLINING PER D.RENAUD/D.SINISI

▲/5	OBSOLETE	▲	YES	1-207119-2
		▲	NO	1-207119-1
		▲	YES	1-207119-0
		▲	NO	207119-9
		▲	YES	207119-8
▲/5	OBSOLETE	▲	YES	207119-7
		▲	NO	207119-4
		▲	YES	207119-3
		▲	NO	207119-2
		▲	YES	207119-1
		CONTACT FINISH	MOUNTING TABS	PART NUMBER

THIS DRAWING IS A CONTROLLED DOCUMENT. DW 03/10/92

L. SHIP 3-17-92

R. STONE

TE Connectivity

PIN HEADER ASSEMBLY, 4 POSITION, METRIMATE

PRODUCT SPEC: 108-10033

APPLICATION SPEC:

SIZE: A2 CASE CODE: C=207119 DRAWING NO: 207119

RESTRICTED TO:

MATERIAL: HOUSING: 1 CONTACT: SEE TABLE

FINISH:

CUSTOMER DRAWING

SCALE: 4:1 SHEET: 1 of 1 REV: S2