

DO NOT SCALE  
DIMENSIONS IN mm

METRIC

THIRD ANGLE  
PROJECTION

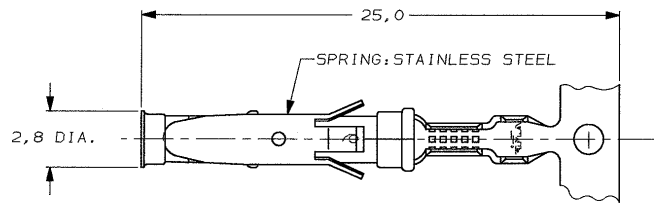

STRIP

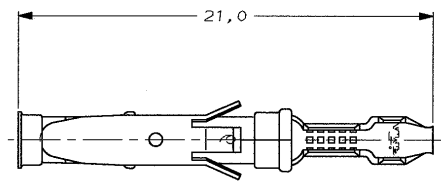

LOOSE-PIECE

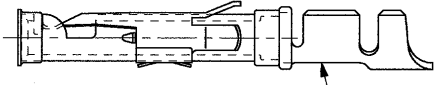
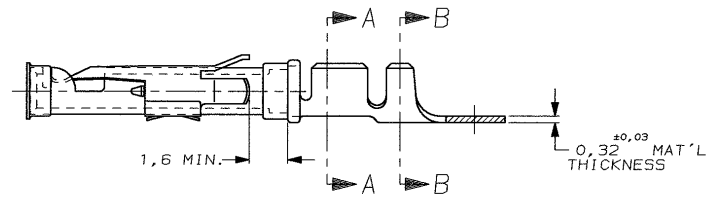

COLOR CODE: BLUE

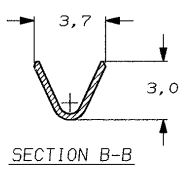
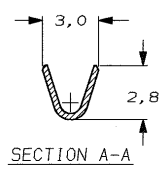

WIRE RANGE : 0,75-1,50 mm<sup>2</sup> (18-16 AWG)  
INSUL. RANGE : 2,0 -2,5 mm (.080-.100)

- NOTES :
- U.L. RECOGNIZED UNDER FILE E28476 VOL. VI SEC. I .
  - FOR CRIMP DETAILS SEE AMP-SPEC. 114-19.000 .
  - MEETS PRODUCTS SPECIFICATION 108-10042.
  - SPECIAL REEL WITH 200 PCS FOR REEL-FED HANDTOOL.
  - OBsolete PARTS: OBSOLETE CIS STREAMLINING PER D.RENAUD/D.SINISI

| OBsolete   | 5-163083-3        |             |            | BRASS   | ECON. GOLD   |
|------------|-------------------|-------------|------------|---------|--------------|
|            | 5-163083-2        |             |            | BRASS   | SEL. GOLD    |
|            | 5-163083-1        |             |            | BRASS   | EL. TIN      |
|            | 1-163083-4        |             | 1-163084-4 | BRASS   | EL. TIN      |
| OBsolete   | 1-163083-3        |             | 1-163084-3 | BRASS   | BR. TIN/LEAD |
|            | 1-163083-2        |             |            | BRASS   | SILVER       |
|            | 1-163083-1        |             |            | BRASS   | ECON. GOLD   |
|            | 1-163083-0        |             | 1-163084-0 | BRASS   | ECON. GOLD   |
|            | 163083-9          |             |            | BRASS   | SILVER       |
|            | 163083-8          |             |            | BRASS   | EL. TIN      |
|            | 163083-7          |             |            | BRASS   | SEL. GOLD    |
|            | 163083-2          |             | 163084-2   | BRASS   | SEL. GOLD    |
|            | 163083-1          |             | 163084-1   | BRASS   | EL. TIN      |
| PARTNUMBER | DIRECTION OF REEL | LOOSE-PIECE | MATERIAL   | PLATING |              |

DIRECTION OFF TOP OF REEL

|                                    |   |
|------------------------------------|---|
| AMPOMATOR + MINI-APPL. 107-3-F16.1 | ▲ |
| 107-3-F16.2                        | ▲ |
| 107-3-F16.4                        | ▲ |

| NOTES | MATERIAL   | THICKNESS  | AREA         |
|-------|------------|------------|--------------|
| ▲     | TIN        | 2,0 μm     | ALL OVER     |
| ▲     | NICKEL     |            | ALL OVER     |
| ▲     | GOLD       | 0,8 μm     | CONTACT AREA |
| ▲     | TIN/LEAD   |            | BARREL       |
| ▲     | NICKEL     | 0,8 μm     | ALL OVER     |
| ▲     | GOLD       |            | CONTACT AREA |
| ▲     | NICKEL     | 1,2 μm     | ALL OVER     |
| ▲     | GOLD       |            | CONTACT AREA |
| ▲     | TIN/LEAD   |            | BARREL       |
| ▲     | SILVER     | 1,5-2,5 μm | ALL OVER     |
| ▲     | NICKEL     | 0,75 μm    | ALL OVER     |
| ▲     | SILVER     | 2,5 μm     | ALL OVER     |
| ▲     | NICKEL     | 1,27 μm    | ALL OVER     |
| ▲     | TIN/LEAD   | 1,27 μm    | ALL OVER     |
| ▲     | LUBRICATED |            |              |

| AZ1  | ECO-10-000445   | KK   | HMR  | 19JAN10   |
|------|-----------------|------|------|-----------|
| AZ   | EBD0-0003-05    | AM   | FWK  | 05/01/05  |
| AY   | EBD0-0335-04    | JMS  | FWK  | 02/08/04  |
| V    | EH-1020-98      | D.K. | R.V. | 08 JUL 98 |
| U    | EH-1347-96      | JvL  | RV   | 21-11-96  |
| T    | EH-0302-94      | JvL  | MvD  | 03-05-94  |
| S    | ECN H-9813      | JvdH | RD   | 18-05-92  |
| LTR. | REVISION RECORD | DR.  | CHK. | DATE      |

**CUSTOMER DRAWING** FOR REFERENCE ONLY WILL NOT BE UPDATED.

© COPYRIGHT 19- BY AMP HOLLAND B.V.  
ALL INTERNATIONAL RIGHTS RESERVED. AMP PRODUCTS MAY BE COVERED BY U.S. AND FOREIGN AND/OR PATENTS PENDING.

THIS DRAWING IS UNPUBLISHED  
RELEASED FOR PUBLICATION

**AMP** AMP HOLLAND B.V.  
s-Hertogenbosch, The Netherlands.

NAME: SOCKET TYPE III CONTACT  
SIZE 16

DRG. No. 163083  
REV. LTR. AZ1  
SHEET 1 of 1