

THIS DRAWING IS UNPUBLISHED. RELEASED FOR PUBLICATION. ALL RIGHTS RESERVED.

LOC		DIST		REVISIONS		
FT	O	F	LR	DESCRIPTION	DATE	BY
		AD1		REVISED PER ECO-11-004587	11MAR11	RK HMR

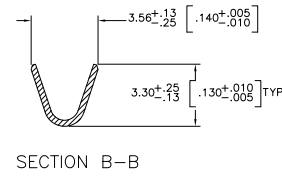
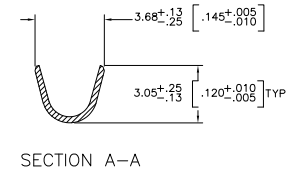
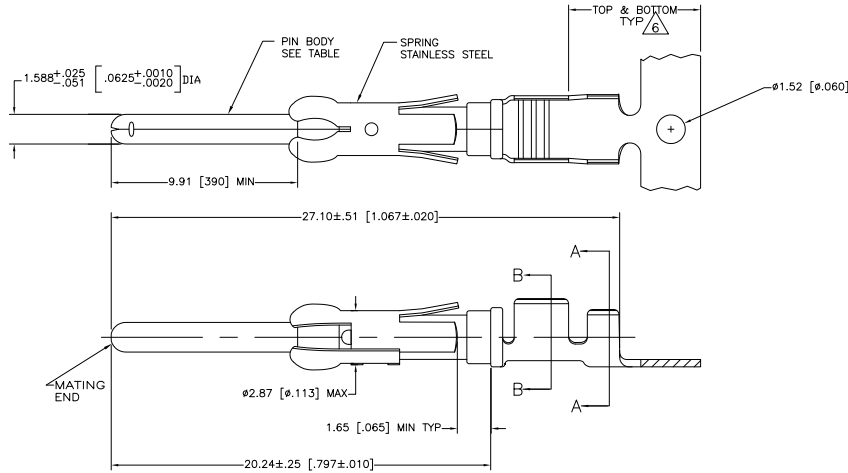

- $\Delta 1$ REVERSE REELED FOR MINI-APPLICATOR.
- $\Delta 2$ 0.76 μ m [$.000030$] MIN PRECIOUS METAL PLATE ON MATING END FOR A LENGTH OF 5.08 [$.200$] MIN OVER 1.27 μ m [$.000050$] MIN NICKEL. GOLD FLASH ALL OVER. CONFORMS TO THE REQUIREMENTS OF TE CONNECTIVITY PRODUCT SPEC 108-10042, BASED ON EIA/ECA-364-1000.01 (CONTROLLED ENVIRONMENT APPLICATIONS).
- $\Delta 3$ 0.76 μ m [$.000030$] MIN PRECIOUS METAL PLATE ON MATING END FOR A LENGTH OF 5.08 [$.200$] MIN WITH A UNIFORM GRADIENT TO 0.25 μ m [$.000010$] MIN ON REMAINDER, OVER 1.27 μ m [$.000050$] MIN NICKEL PLATE. GOLD FLASH ALL OVER. CONFORMS TO THE REQUIREMENTS OF TE CONNECTIVITY PRODUCT SPEC 108-10042, BASED ON EIA/ECA-364-1000.01 (CONTROLLED ENVIRONMENT APPLICATIONS).
- $\Delta 4$ 0.38 μ m [$.000015$] MIN GOLD PER MIL-G-45204 ON MATING END FOR A LENGTH OF 5.08 [$.200$] MIN WITH GOLD FLASH ON THE REMAINDER OVER 1.27 μ m [$.000050$] MIN NICKEL PER QQ-N-290.
- $\Delta 5$ 1.27 μ m [$.000050$] MIN TIN-LEAD PER MIL-T-10727 OVER 1.27 μ m [$.000050$] MIN NICKEL PER QQ-N-290.
- $\Delta 6$ GOLD PLATING NEED NOT APPEAR IN THIS AREA.
- 7 WIRE RANGE 18-14 AWG.
- 8 INSULATION RANGE 2.03 [$.080$] - 2.54 [$.100$] DIA.
- $\Delta 9$ 0.38 μ m [$.000015$] MIN GOLD PER MIL-G-45204 ON MATING END FOR A LENGTH OF 5.08 [$.200$] MIN, 1.27 μ m [$.000050$] MIN TIN-LEAD PER MIL-T-10727 FOR A LENGTH OF 5.69 [$.224$] MIN ON OPPOSITE END, BOTH OVER 1.27 μ m [$.000050$] MIN NICKEL PER QQ-N-290 ON ENTIRE CONTACT.
- $\Delta 10$ 1.27 μ m [$.000050$] MIN TIN PER MIL-T-10727 OVER 1.27 μ m [$.000050$] MIN NICKEL PER QQ-N-290.
- $\Delta 11$ 2.54 μ m [$.000100$] MIN SILVER OVER 0.76 μ m [$.000030$] MIN NICKEL PER QQ-N-290

STANDARD	FINISH	MATERIAL	PIN BODY	LOOSE PIECE REF	PART NO
		BRASS			2-66359-0
		CU-NI ALLOY	1-66361-6		1-66359-9
STANDARD		BRASS	1-66361-2		1-66359-8
		CU-NI ALLOY	1-66361-5		1-66359-7
		CU-NI ALLOY	1-66361-4		1-66359-6
		PHOSPHOR BRONZE			1-66359-5
		BRASS	1-66361-2		1-66359-4
OBSOLETE		BRASS	66361-9		1-66359-3
		PHOSPHOR BRONZE	66361-8		1-66359-2
		PHOSPHOR BRONZE	66361-7		1-66359-1
		BRASS	66361-4		1-66359-0
		BRASS	66361-3		66359-9
		BRASS	66361-2		66359-6
		BRASS	66361-1		66359-5
STANDARD		BRASS	66361-4		66359-4
STANDARD		BRASS	66361-3		66359-3
STANDARD		BRASS	66361-2		66359-2
STANDARD		BRASS	66361-1		66359-1
	REELING	PIN BODY FINISH	PIN BODY	LOOSE PIECE REF	PART NO

THIS DRAWING IS A CONTROLLED DOCUMENT. DWG: V. FURLER 23AA2003
 CHK: G. STEINHAUER 24AX.03
 APPR: G. STEINHAUER 24AX.03 NAME

TE Connectivity

PIN ASSEMBLY, .062, TYPE III+

APPLICATION SPEC: - SIZE: A2 00779 C=66359
 WEIGHT: -
 MATERIAL: SEE CALLOUTS
 FINISH: SEE TABLE
 CUSTOMER DRAWING
 SCALE: NTS
 SHEET: 1 of 1
 REV: AD1