

THE DRAWING IS UNPUBLISHED.  
 © COPYRIGHT - BY -  
 RELEASED FOR PUBLICATION  
 ALL RIGHTS RESERVED.

REVOLUTIONS		DATE	BY	APP
1	REVISED PER ECO-11-004587	11MAR11	RK	HMR

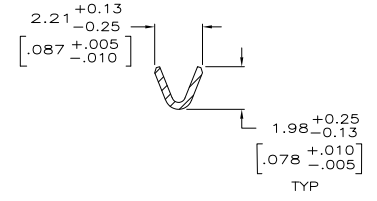
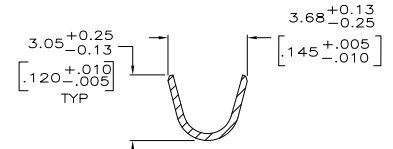
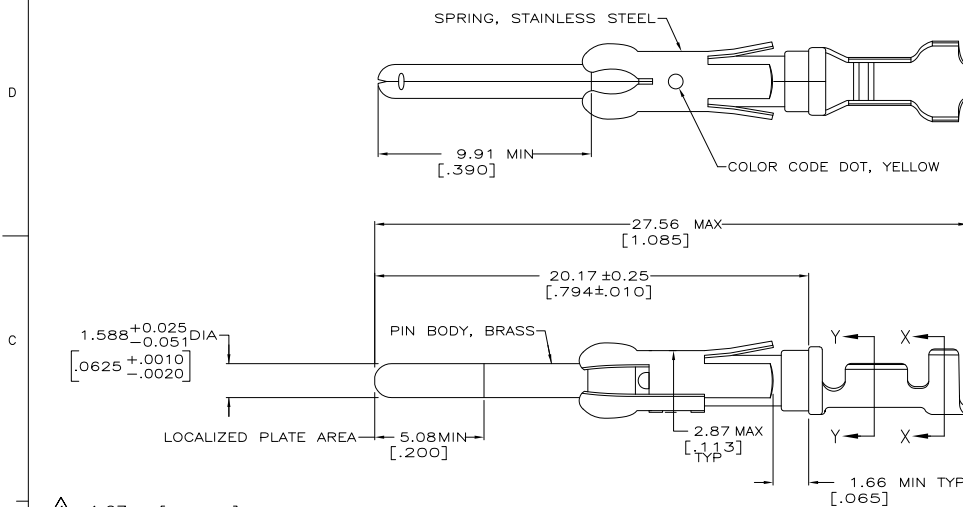

- 1. 1.27 $\mu$ m [.000050] MIN TIN-LEAD OVER  
1.27 $\mu$ m [.000050] MIN NICKEL.
- 2. 0.76 $\mu$ m [.000030] MIN PRECIOUS METAL PLATE ON MATING END FOR A LENGTH OF 5.08 [.200] MIN OVER 1.27 $\mu$ m [.000050] MIN NICKEL PLATE. GOLD FLASH ALL OVER. CONFORMS TO THE REQUIREMENTS OF TE CONNECTIVITY PRODUCT SPEC 108-10042, BASED ON EIA/ECA-364-1000.01A ( CONTROLLED ENVIRONMENT APPLICATIONS ).
- 3. 0.76 $\mu$ m [.000030] MIN PRECIOUS METAL PLATE ON MATING END FOR A LENGTH OF 5.08 [.200] MIN WITH A UNIFORM GRADIENT TO 0.25 $\mu$ m [.000010] ON REMAINDER, OVER 1.27 $\mu$ m [.000050] MIN NICKEL PLATE. GOLD FLASH ALL OVER. CONFORMS TO THE REQUIREMENTS OF TE CONNECTIVITY PRODUCT SPEC 108-10042, BASED ON EIA/ECA-364-1000.01A ( CONTROLLED ENVIRONMENT APPLICATIONS ).
- 4. 0.38 $\mu$ m [.000015] MIN GOLD IN LOCALIZED PLATE AREA, GOLD FLASH ON THE REMAINDER ALL OVER 1.27 $\mu$ m [.000050] NICKEL.
- 5. WIRE RANGE 24-20 AWG.
- 6. INSULATION RANGE 2.03[.080]-2.54[.100] DIA.
- 7. 0.38 $\mu$ m [.000015] MIN GOLD PER MIL-G-45204 ON LOCALIZED GOLD PLATE AREA, 1.27 $\mu$ m [.000050] MIN TIN-LEAD PER MIL-T-10727 FOR A LENGTH OF 5.69 [.224] MIN ON OPPOSITE END, BOTH OVER 1.27 $\mu$ m [.000050] MIN NICKEL PER QQ-N-290 ON ENTIRE CONTACT.
- 8. 1.27 $\mu$ m [.000050] MIN TIN OVER  
1.27 $\mu$ m [.000050] MIN NICKEL.
- 9. OBSOLETE PARTS: OBSOLETE CIS STREAMLINING PER D.RENAUD/D.SINISI

	SMALL PACK	1-66332-4	1-66400-1
	STANDARD	1-66332-4	1-66400-0
	SMALL PACK	66332-4	66400-9
OBsolete	SMALL PACK	66332-3	66400-8
OBsolete	SMALL PACK	66332-6	66400-7
	SMALL PACK	66332-1	66400-6
OBsolete	STANDARD	1-66332-2	66400-5
	STANDARD	66332-4	66400-4
	STANDARD	66332-3	66400-3
	STANDARD	66332-6	66400-2
	STANDARD	66332-1	66400-1
	PACKAGING TYPE	FINISH	STRIP P/N REF PART NO

THIS DRAWING IS A CONTROLLED DOCUMENT. ON 9-27-90  
 BY H. MOLL 12-15-90  
 BY J. MCCLELLIN 12-10-90  
 BY A. BOULLIANNE 12-10-90

TE Connectivity  
 PIN ASSEMBLY, LOOSE PIECE, TYPE III+

SIZE: A2 CASE CODE: C DRAWING NO: 00779 ©=66400 RESTRICTED TO: S1

MATERIAL: SEE CALL OUT FINISH: PIN BODY: SEE TABLE WEIGHT: CUSTOMER DRAWING SCALE: 8:1 SHEET: 1 of 1 REV: S1

66400