

4

3

2

1

THIS DRAWING IS UNPUBLISHED. RELEASED FOR PUBLICATION. ALL RIGHTS RESERVED.

LOC	DIST	REVISIONS		DATE	BY	APP'D
FT	0	F	LR	DESCRIPTION		
		AF1		REVISED PER ECO-11-004587	11MAR11	RK HMR

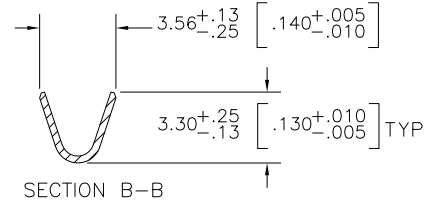
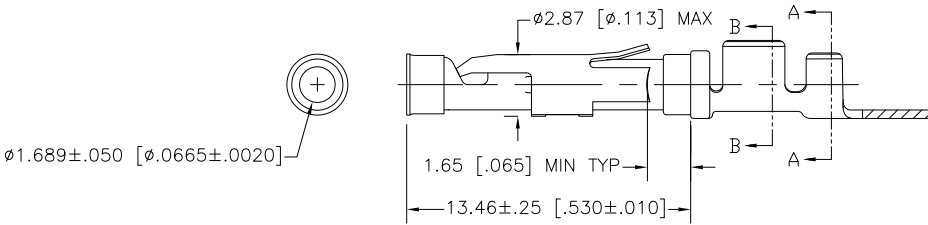
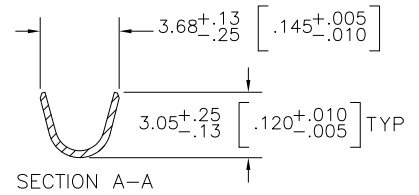
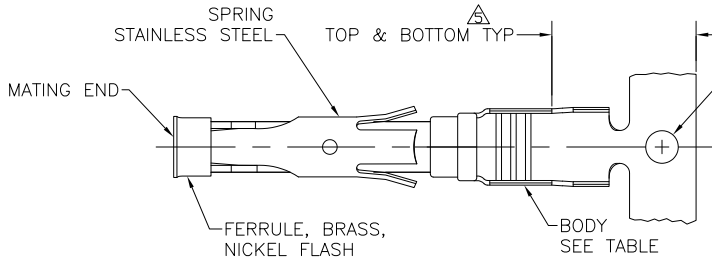

- 1 .076µm [.000030] MIN GOLD PER MIL-G-45204 ON MATING END FOR A LENGTH OF 5.08 [.200] MIN WITH GOLD FLASH ON THE REMAINDER OVER 0.76µm [.000030] MIN NICKEL PER QQ-N-290.
- 2 1.27µm [.000050] MIN TIN-LEAD PER MIL-T-10727 OVER 0.76µm [.000030] MIN NICKEL PER QQ-N-290.
- 3 0.76µm [.000030] MIN GOLD PER MIL-G-45204 ON MATING END FOR A LENGTH OF 5.08 [.200] MIN WITH A UNIFORM GRADIENT TO 0.25 [.000010] MIN GOLD PER MIL-G-45204 ON THE REMAINDER OVER 0.76µm [.000030] MIN NICKEL PER QQ-N-290.
- 4 0.38µm [.000015] MIN GOLD PER MIL-G-45204 ON MATING END FOR A LENGTH OF 5.08 [.200] MIN WITH GOLD FLASH ON THE REMAINDER OVER 0.76µm [.000030] MIN NICKEL PER QQ-N-290.
- 5 GOLD PLATING NEED NOT APPEAR IN THIS AREA.
- 6 REVERSE REELED FOR MINI-APPLICATOR.
- 7 WIRE RANGE 18-14 AWG. INSULATION RANGE 2.03[.080]-2.54[.100].
- 8 0.38µm [.000015] MIN GOLD PER MIL-G-45204 ON MATING END FOR A LENGTH OF 5.08 [.200] MIN, 1.27µm [.000050] MIN TIN-LEAD PER MIL-T-10727 FOR A LENGTH OF 5.08 [.224] MIN ON OPPOSITE END, BOTH OVER 1.27µm [.000050] MIN NICKEL PER QQ-N-290 ON ENTIRE CONTACT.
- 9 1.27µm [.000050] MIN TIN PER MIL-T-10727 OVER 0.6µm [.000030] MIN NICKEL PER QQ-N-290.
- 10 2.54µm [.000100] MIN SILVER OVER 0.76µm [.000030] MIN NICKEL PER QQ-N-290.
- 11 OBSOLETE PARTS: OBSOLETE CIS STREAMLINING PER D.RENAUD/D.SINISI

REELING	BODY FINISH	BODY MATERIAL	LOOSE PIECE REF	PART NO.
△	△	BRASS	-	2-66358-3
△	△	BRASS	-	2-66358-2
△	△	CU-NI ALLOY	1-66360-6	2-66358-1
△	△	CU-NI ALLOY	1-66360-5	2-66358-0
△	△	CU-NI ALLOY	1-66360-4	1-66358-9
△	△	PHOSPHOR BRONZE	-	1-66358-8
STANDARD	△	BRASS	1-66360-2	1-66358-7
△	△	BRASS	1-66360-2	1-66358-6
OBSOLETE	△	BRASS	66360-9	1-66358-5
△	△	BRASS	-	1-66358-4
△	△	PHOSPHOR BRONZE	66360-8	1-66358-3
OBSOLETE	△	PHOSPHOR BRONZE	66360-7	1-66358-2
△	△	BRASS	66360-4	1-66358-0
△	△	BRASS	66360-3	66358-9
△	△	BRASS	66360-2	66358-6
△	△	BRASS	66360-1	66358-5
STANDARD	△	BRASS	66360-4	66358-4
STANDARD	△	BRASS	66360-3	66358-3
STANDARD	△	BRASS	66360-2	66358-2
STANDARD	△	BRASS	66360-1	66358-1

THIS DRAWING IS A CONTROLLED DOCUMENT. DWG V. FURLER 23MAR2003

CHK G. STEINHAUER 23MAY03

APP'D G. STEINHAUER 23MAY03 NAME

PRODUCT SPEC

APPLICATION SPEC

SIZE CASE CODE DRAWING NO. RESTRICTED TO

WEIGHT

A2 00779 C-66358

CUSTOMER DRAWING SCALE 8:1 SHEET 1 of 1 REV AF1

TE Connectivity

SOCKET ASSEMBLY, .062, TYPE III+