

- △ CLAMSHELLS AND HEADER HOUSING: THERMO PLASTIC, UL94 V-0, CONTACTS: COPPER ALLOY; SCREWS: STEEL.
- △ CONTACTS: .000030 MIN GOLD IN MATING AREA, .000050 MIN TIN ON CRIMP AREAS, BOTH OVER .000050 MIN NICKEL. SCREWS: ZINC
- △ TYCO PART NUMBER AND DATE CODE MARKED IN AREA.
- △ DIM S IS CENTERLINE SPACING OF POWER MODULES ON LEFT SIDE OF CONNECTOR.
- △ DIM T IS CENTERLINE SPACING OF POWER MODULES ON RIGHT SIDE OF CONNECTOR.

REV		DESCRIPTION		DATE	BY	CHK	APP
A	INITIAL REL PER ECO-00-017536						

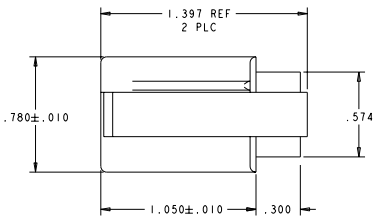
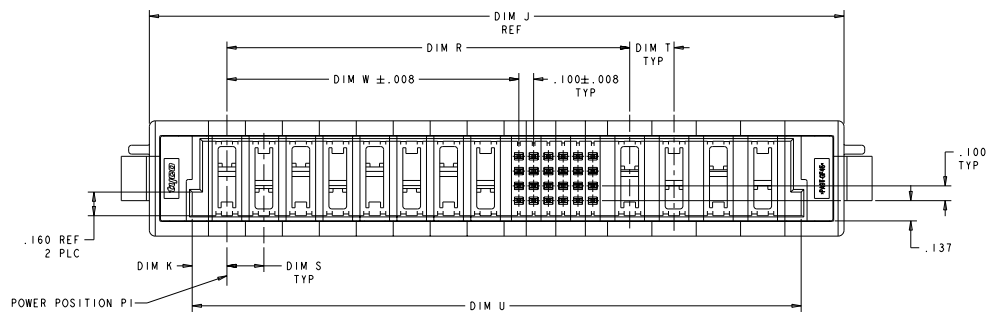
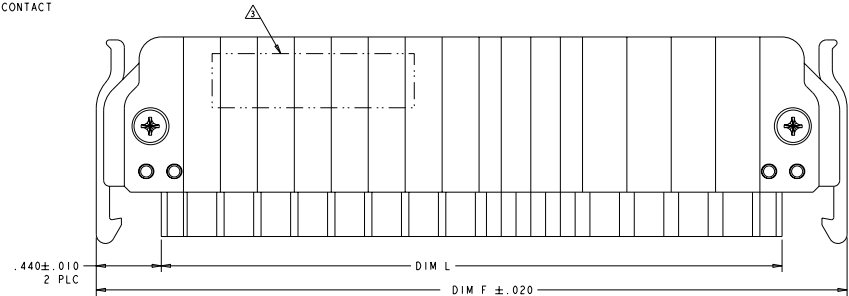

DIM J	DIM L	DIM U	DIM S	DIM T	DIM R	DIM W	DIM F	DIM K	DESCRIPTION	PART NUMBER
3.300	2.800	2.720	.300	.300	1.600	.850	3.680	.260	3ACP(8AWG) + 24S + 3ACP(8AWG)	1600238-6
2.500	2.000	1.920	.250	.250	1.200	.475	2.880	.235	2P(10AWG) + 24S + 2P(10AWG)	1600238-5
1.800	1.300	1.220	-	-	.750	.225	2.180	.235	1P(10AWG) + 16S + 1P(10AWG)	1600238-4
2.000	1.500	1.420	-	-	.950	.225	2.380	.235	1P(10AWG) + 24S + 1P(10AWG)	1600238-3
4.700	4.200	4.120	.250	.300	2.725	1.975	5.080	.235	8P(12AWG) + 24S + 4ACP(8AWG)	1600238-2
4.700	4.200	4.120	.250	.300	2.725	1.975	5.080	.235	8P(10AWG) + 24S + 4ACP(8AWG)	1600238-1

DIMENSIONS: INCHES TYPICAL DIMENSIONS: INCHES FINISH: PLATED TOLERANCES: .005 MATERIAL: THERMO PLASTIC	DATE: 25 JAN 2005 BY: 1800L CHECKED: 28 JAN 2005 DRAWN BY: 188-2151-1 SPECIFICATION SHEET: 116-1316E STATE: CAKE CODE (SEE DRAWING 40) WEIGHT: 0.0779 CUSTOMER DRAWING: 1600238	Tyco Electronics Harrisburg, PA 17105-3600 SQUEEZE TO RELEASE CABLE PLUG. WITH KEYS, TYPE PSP MULTI-BEAM XL 00779 © 1600238 PAGE 3:1 OF 2
--	--	---

