

REV	DATE	DESCRIPTION	BY	CHK	APP
ES	00				
K1		ADD NEW PART -27	BLUMENH	AT	SZ
K2		ADDED THE DASH NO -26	ESHPHIL	ML	SZ
K3		REVISED	ESHPHIL	ML	SZ

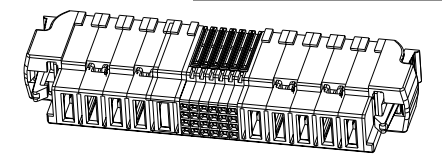

ISOMETRIC VIEW WITHOUT
 OPTIONAL CENTER MODULE
 SCALE 2:1

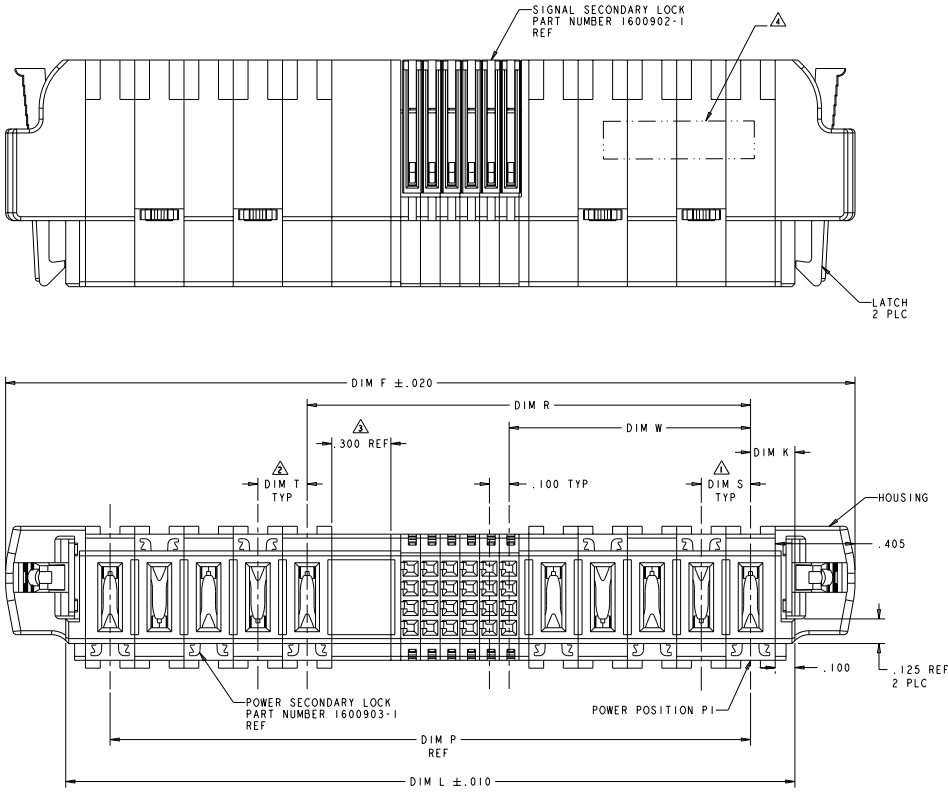
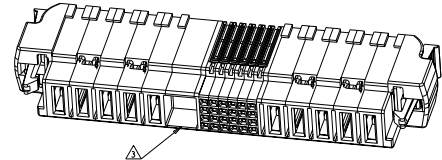

ISOMETRIC VIEW WITH
 OPTIONAL CENTER MODULE
 SCALE 2:1

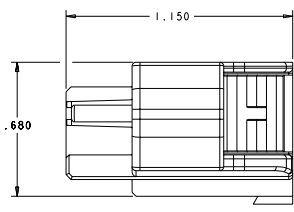

- △ DIM S IS CENTERLINE SPACING OF POWER MODULE ON RIGHT SIDE OF HOUSING.
- △ DIM T IS CENTERLINE SPACING OF POWER MODULE ON LEFT SIDE OF HOUSING.
- △ OPTIONAL CENTER MODULE
- △ COMPANY TRADEMARK, PART NUMBER, AND DATE CODE TO BE MARKED IN APPROX AREA SHOWN. PARTS UNDER 2.00 LONG MAY BE MARKED ON BOTH SIDES.
- △ THERMO PLASTIC, UL94 V-0, BLACK
- △ VARIABLE DIMENSIONS SHOWN ON VIEW (SHEET 2).
- △ FOR PART NUMBER 1-1600788-6, THE OTHER DIMENSION PLEASE SEE TABLE ON SHEET 2.
- △ NOT RELEASED FOR PRODUCTION.
- △ DIMENSION REFER TO THE PART REVIEW IN PAGE 2.
- △ THE CONFIGURATION WITH VENT, PLEASE REFER TO SHEET 2.

THIS DRAWING IS A CONTROLLED DOCUMENT.		DATE: 10/20/05	BY: TOMAYES	TE Connectivity SQUEEZE TO RELEASE CABLE RECEPTACLE ASSEMBLY W/ LATCHES AND KEY. MULTI-BEAM XL
DIMENSIONS: INCHES UNLESS OTHERWISE SPECIFIED	QUANTITIES: AS SHOWN UNLESS OTHERWISE SPECIFIED	DATE: 10/20/05 BY: TOMAYES	STATE: CA COUNTY: SAN JOAQUIN CITY: STOCKTON	
MATERIAL:	FINISH:	PART NUMBER: 1600788-6 REVISION: 00 DATE: 10/20/05	STATE: CA COUNTY: SAN JOAQUIN CITY: STOCKTON	PART NUMBER: 1600788-6 REVISION: 00 DATE: 10/20/05
		CUSTOMER DRAWING		SCALE: 2:1 SHEET: 1 OF 6 FILE: K3

DATE REVISIONS TO IMPLEMENTATION RECEIVED FOR PUBLICIZATION
 02/03/2022 01 ALL RIGHTS RESERVED

REV	DATE	REVISIONS	BY	CHK	APP
ES	00	SEE SHEET 1			

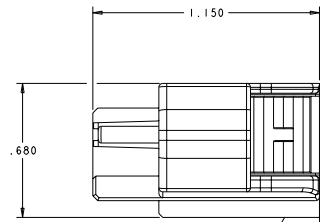
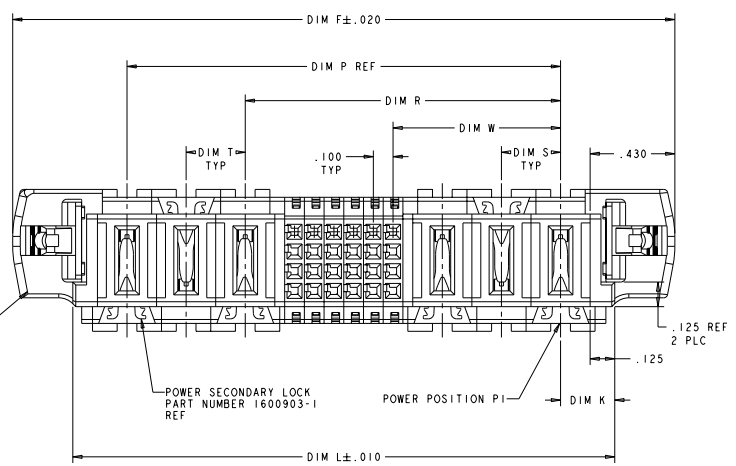
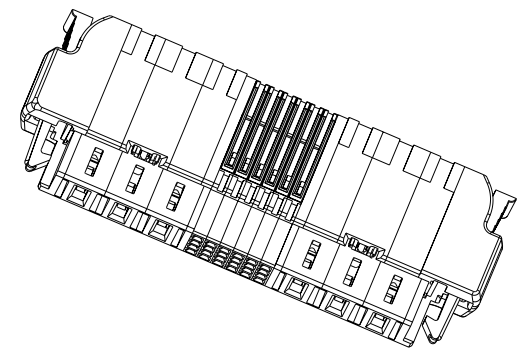
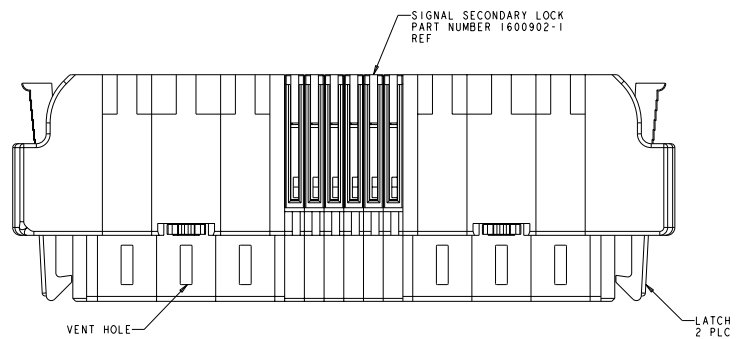

(K2) THE CONFIGURATION WITH VENT HOLES
 PART NO.: 2-1600788-6

THIS DRAWING IS A CONTROLLED DOCUMENT.		DATE APPROVED: 02/03/2022	TODAY'S DATE: 02/03/2022	MTE TE Connectivity SQUEEZE TO RELEASE CABLE RECEPTACLE ASSEMBLY W/ LATCHES AND KEY. MULTI-BEAM XL
DIMENSIONS: INCHES UNLESS OTHERWISE SPECIFIED	QUANTITIES: AS SHOWN UNLESS OTHERWISE SPECIFIED	DRAWN BY: 168-2157 CHECKED BY: 116-13112 MATERIAL:	STATE: CA CITY: FOLSOM CUSTOMER DRAWING: A100779-1600788	

DATE REVISION TO IMPLEMENTED REVISIONS FOR PUBLICATION ALL RIGHTS RESERVED

REV	ES	NO	DESCRIPTION	DATE	BY	CHK
	00		SEE SHEET 1			

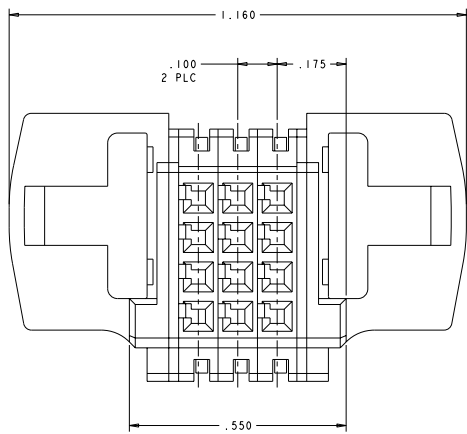

PART 2-1600788-6

NO						DIM L	DIM K	DIM F	DESCRIPTION	PART NUMBER
	DIM P	DIM W	DIM T	DIM S	DIM R					
NO	2.200	.850	.300	.300	1.600	2.750	.275	3.360	3ACP + 24S + 3ACP	2-1600788-7
NO	1.100	.500	.300	.300	.800	1.600	.250	2.210	2ACP + 8S + 2ACP	2-1600788-6
NO	.450	.225	-	-	.450	.900	.225	1.510	1P + 4S + 1P	2-1600788-4
NO	2.400	.850	.300	.300	1.800	2.950	.275	3.560	3ACP + 32S + 3ACP	2-1600788-3
NO	1.600	.550	.300	.300	1.300	2.150	.275	2.760	2ACP + 24S + 2ACP	2-1600788-0
NO	2.200	.850	.300	.300	1.600	2.750	.275	3.360	3ACP + 24S + 3ACP	1-1600788-9
NO	3.450	1.475	.250	.250	2.200	3.900	.225	4.510	6P + 24S + 6P	1-1600788-7
NO	-	-	-	-	-	2.000	.200	2.610	0P + 68S + 0P	1-1600788-6
NO	2.800	1.150	.300	.300	1.900	3.350	.275	3.960	4ACP + 24S + 4ACP	1-1600788-5
NO	2.450	.975	.250	.250	1.700	2.900	.225	3.510	4P + 24S + 4P	1-1600788-4
NO	1.050	.475	.250	.250	.800	1.500	.225	2.110	2P + 8S + 2P	1-1600788-3
NO	2.200	.850	.300	.300	1.600	2.750	.275	3.360	3ACP + 24S + 3ACP	1-1600788-2
NO	1.250	.475	.250	.250	1.000	1.700	.225	2.310	2P + 16S + 2P	1-1600788-0
NO	1.550	.725	.250	.250	1.050	2.000	.225	2.610	3P + 8S + 3P	1600788-9
NO	.950	.225	-	-	.950	1.400	.225	2.010	1P + 24S + 1P	1600788-8
NO	3.975	1.650	.250	.250	2.575	4.475	.225	5.085	6P + 32S + 6P	1600788-7
NO	2.750	1.475	.250	.250	2.500	3.200	.225	3.810	6P + 36S + 2P	1600788-4
NO	4.625	1.150	.250	.300	1.875	5.125	.275	5.735	4ACP + 24S + 12P	1600788-3
NO	2.650	.975	.250	.250	1.900	3.100	.225	3.710	4P + 32S + 4P	1600788-2
NO	1.450	.475	.250	.250	1.200	1.900	.225	2.510	2P + 24S + 2P	1600788-1
CENTER MODULE	DIM P	DIM W	DIM T	DIM S	DIM R	DIM L	DIM K	DIM F	DESCRIPTION	PART NUMBER

THIS DRAWING IS A CONTROLLED DOCUMENT.		DATE APPROVED: 10/24/03		DATE REVISION: 10/24/03		TE Connectivity	
DRAWING: 1600788-6		REV: 00		DRAWING TITLE: 1600788-6		SQUEEZE TO RELEASE CABLE RECEPTACLE ASSEMBLY W/ LATCHES AND KEY, MULTI-BEAM XL	
INCHES: 0.0001		SCALE: 1:1		REV: 00		STATE CASE CODE (DRAWING NO): 00779	
MATERIAL: 303		FINISH: 00		REV: 00		CUSTOMER DRAWING: 1600788-6	

DATE STANDARD IS OBSOLETE: 01
 REVISIONS FOR PUBLICATION: 01
 ALL RIGHTS RESERVED

REV	DATE	REVISIONS			
		BY	APP	CHK	DATE
00	ES	SEE SHEET 1			

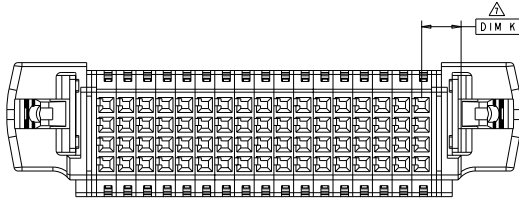

FPR PART NUMBER I-1600788-6, OTHER DIMENSIONS PLEASE SEE TABLE ON SHEET 2.

THIS DRAWING IS A CONTROLLED DOCUMENT.				<input checked="" type="checkbox"/> ASSEMBLY TOMAYES <input checked="" type="checkbox"/> DIMENSIONS TOMAYES		TE Connectivity	
ORIENTATION: INCHES: <input checked="" type="checkbox"/> ASSEMBLY TOMAYES <input checked="" type="checkbox"/> DIMENSIONS TOMAYES	PART NUMBER: 168-2157 SPECIFICATION DOC: 114-13112	STATE CASE CODE (DRAWING NO): A 100779	PART NUMBER TO: I-1600788	SQUEEZE TO RELEASE CABLE RECEPTACLE ASSEMBLY W/ LATCHES AND KEY, MULTI-BEAM XL			
MATERIAL: .	FINISH: .	CUSTOMER DRAWING	SCALE: 1:1	SHEET: 4	OF: 6	FILE: K3	REVISIONS TO:

4408 13/0113

REV	DATE	DESCRIPTION	BY	CHK	APP
ES	00				

PART NUMBER	ROWS	POWER (L)		SIGNAL					POWER (R)			
		P4	P3	6	5	4	3	2	1	P2	P1	
1600788-1	D C B A	RM	RM	E	E	E	E	E	E	E	RA	RA
		RM	RM	E	E	E	E	E	E	E	RA	RA
		RM	RM	E	E	E	E	E	E	E	RA	RA
2P + 24S + 2P												

PART NUMBER	ROWS	POWER (L)		SIGNAL					POWER (R)			
		P2	P6	5	4	3	2	1	P1	P1		
1600788-8	D C B A	RM	RM	E	E	E	E	E	E	E	RM	RM
		RM	RM	E	E	E	E	E	E	E	RM	RM
		RM	RM	E	E	E	E	E	E	E	RM	RM
1P + 24S + 1P												

PART NUMBER	ROWS	POWER (L)		SIGNAL										POWER (R)						
		P8	P7	P6	P5	8	7	6	5	4	3	2	1	P4	P3	P2	P1			
1600788-2	D C B A	RM	RM	RM	RM	E	E	E	E	E	E	E	E	E	E	E	E	RM	RM	RM
		RM	RM	RM	RM	E	E	E	E	E	E	E	E	E	E	E	E	RM	RM	RM
		RM	RM	RM	RM	E	E	E	E	E	E	E	E	E	E	E	E	RM	RM	RM
4P + 32S + 4P																				

PART NUMBER	ROWS	POWER (L)		SIGNAL					POWER (R)			
		P4	P3	4	3	2	1	P2	P1			
I-1600788-0	D C B A	RM	RM	E	E	E	E	E	E	E	RA	RA
		RM	RM	E	E	E	E	E	E	E	RA	RA
		RM	RM	E	E	E	E	E	E	E	RA	RA
2P + 16S + 2P												

PART NUMBER	ROWS	POWER (L)										SIGNAL					POWER (R)										
		P16	P15	P14	P13	P12	P11	P10	P9	P8	P7	P6	P5	6	5	4	3	2	1	P4	P3	P2	P1				
1600788-3	D C B A	RA	RM	RA	RM	RA	RM	RA	RM	RA	RM	RA	RM	RA	RM	E	E	E	E	E	E	E	E	RA	RM	RA	RM
		RA	RM	RA	RM	RA	RM	RA	RM	RA	RM	RA	RM	RA	RM	E	E	E	E	E	E	E	E	RA	RM	RA	RM
		RA	RM	RA	RM	RA	RM	RA	RM	RA	RM	RA	RM	RA	RM	E	E	E	E	E	E	E	E	RA	RM	RA	RM
4ACP + 24S + 12P																											

PART NUMBER	ROWS	POWER (L)		SIGNAL					POWER (R)							
		P6	P5	P4	6	5	4	3	2	1	P3	P2	P1			
I-1600788-2	D C B A	RM	RM	RM	E	E	E	E	E	E	E	E	E	RM	RM	RM
		RM	RM	RM	E	E	E	E	E	E	E	E	E	RM	RM	RM
		RM	RM	RM	E	E	E	E	E	E	E	E	E	RM	RM	RM
3ACP + 24S + 3ACP																

PART NUMBER	ROWS	POWER (L)		SIGNAL					POWER (R)									
		P8	P7	9	8	7	6	5	4	3	2	1	P6	P5	P4	P3	P2	P1
1600788-4	D C B A	RM	RM	E	E	E	E	E	E	E	E	E	RM	RM	RM	RM	RM	RM
		RM	RM	E	E	E	E	E	E	E	E	E	E	RM	RM	RM	RM	RM
		RM	RM	E	E	E	E	E	E	E	E	E	E	RM	RM	RM	RM	RM
6P + 36S + 2P																		

PART NUMBER	ROWS	POWER (L)		SIGNAL		POWER (R)	
		P4	P3	2	1	P2	P1
I-1600788-3	D C B A	RM	RM	E	E	RA	RM
		RM	RM	E	E	RA	RM
		RM	RM	E	E	RA	RM
2P + 8S + 2P							

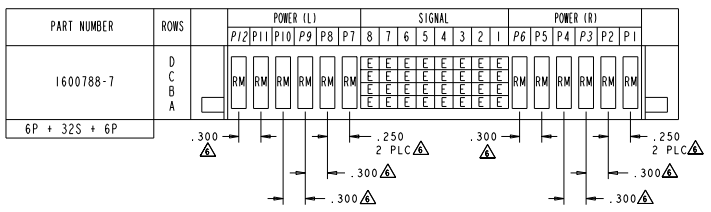

HOUSING MODULE	CONTACT	INSULATION DIAMETER RANGE
.300 POWER	8 - 10 REF 1600960	[.176 - .272]
.250 POWER	8 - 10 REF 1600960	[.176 - .203]
	12 - 14 REF 1600961	[.156 - .176]
.200 POWER	12 - 14 REF 1600961	[.120 - .156]
.100 SIGNAL	22 - 26 REF 531216-5	[.036 - .069]

POWER CONTACT, STD	RM
POWER CONTACT, MFBL	RA
SIGNAL CONTACT	E
DESCRIPTION	CODE
CODES	

THIS DRAWING IS A CONTROLLED DOCUMENT. DATE: 11/15/12

INCHES: 1/16" (25.4mm)

DATE: 11/15/12

1600788-7

116-13112

100779@1600788

TE Connectivity

SQUEEZE TO RELEASE CABLE RECEPTACLE ASSEMBLY W/ LATCHES AND KEY, MULTI-BEAM XL

116-13112

100779@1600788

116-13112

100779@1600788

116-13112

100779@1600788

REV	DATE	DESCRIPTION	BY	CHK	APP
ES	00	SEE SHEET 1			

PART NUMBER	ROWS	POWER (L)			SIGNAL							POWER (R)						
		P8	P7	P6	P5	6	5	4	3	2	1	P4	P3	P2	P1			
1-1600788-4	D	RM	RM	RM	E	E	E	E	E	E	E	E	E	E	E	RM	RM	RM
	C				E	E	E	E	E	E	E	E	E	E	E			
	B				E	E	E	E	E	E	E	E	E	E	E			
	A				E	E	E	E	E	E	E	E	E	E	E			

4P + 24S + 4P

PART NUMBER	ROWS	POWER (L)			SIGNAL							POWER (R)						
		P6	P5	P4	8	7	6	5	4	3	2	1	P3	P2	P1			
1600788-9	D	RM	RM	RM	E	E	E	E	E	E	E	E	E	E	E	RM	RM	RM
	C				E	E	E	E	E	E	E	E	E	E	E			
	B				E	E	E	E	E	E	E	E	E	E	E			
	A				E	E	E	E	E	E	E	E	E	E	E			

3P + 8S + 3P

PART NUMBER	ROWS	POWER (L)			SIGNAL							POWER (R)						
		P8	P7	P6	P5	6	5	4	3	2	1	P4	P3	P2	P1			
1-1600788-5	D	RM	RM	RM	E	E	E	E	E	E	E	E	E	E	E	RM	RM	RM
	C				E	E	E	E	E	E	E	E	E	E	E			
	B				E	E	E	E	E	E	E	E	E	E	E			
	A				E	E	E	E	E	E	E	E	E	E	E			

4ACP + 24S + 4ACP

PART NUMBER	ROWS	POWER		SIGNAL							POWER							
		P6	P5	P4	8	7	6	5	4	3	2	1	P3	P2	P1			
2-1600788-3	D	RM	RM	RM	E	E	E	E	E	E	E	E	E	E	E	RM	RM	RM
	C				E	E	E	E	E	E	E	E	E	E	E			
	B				E	E	E	E	E	E	E	E	E	E	E			
	A				E	E	E	E	E	E	E	E	E	E	E			

3ACP+32S+3ACP

PART NUMBER	ROWS	SIGNAL																
		17	16	15	14	13	12	11	10	9	8	7	6	5	4	3	2	1
1-1600788-6	D	E	E	E	E	E	E	E	E	E	E	E	E	E	E	E	E	E
	C	E	E	E	E	E	E	E	E	E	E	E	E	E	E	E	E	E
	B	E	E	E	E	E	E	E	E	E	E	E	E	E	E	E	E	E
	A	E	E	E	E	E	E	E	E	E	E	E	E	E	E	E	E	E

0P + 68S + 0P

PART NUMBER	ROWS	P (L)		SIGNAL		P (R)	
		P2	P1	I	P1	P2	P1
2-1600788-4	D	RM		E	E	RM	
	C			E	E		
	B			E	E		
	A			E	E		

1P + 4S + 1P

PART NUMBER	ROWS	POWER (L)			SIGNAL							POWER (R)						
		P12	P11	P10	P9	P8	P7	6	5	4	3	2	1	P6	P5	P4	P3	P2
1-1600788-7	D	RM	RM	RM	RM	RM	E	E	E	E	E	E	E	E	E	E	E	E
	C						E	E	E	E	E	E	E	E	E	E	E	E
	B						E	E	E	E	E	E	E	E	E	E	E	E
	A						E	E	E	E	E	E	E	E	E	E	E	E

6P + 24S + 6P

PART NUMBER	ROWS	POWER (L)		SIGNAL		POWER (R)	
		P4	P3	2	1	P2	P1
2-1600788-5	D	RA	RA	E	E	RA	RA
	C			E	E		
	B			E	E		
	A			E	E		

2ACP + 8S + 2ACP

PART NUMBER	ROWS	POWER (L)			SIGNAL							POWER (R)					
		P6	P5	P4	6	5	4	3	2	1	P3	P2	P1				
1-1600788-9	D	RM	RM	RM	E	E	E	E	E	E	E	E	E	E	RM	RM	RM
	C				E	E	E	E	E	E	E	E	E	E			
	B				E	E	E	E	E	E	E	E	E	E			
	A				E	E	E	E	E	E	E	E	E	E			

3ACP + 24S + 3ACP

PART NUMBER	ROWS	POWER (L)			SIGNAL							POWER (R)					
		P6	P5	P4	6	5	4	3	2	1	P3	P2	P1				
2-1600788-6	D	RA	RM	RM	E	E	E	E	E	E	E	E	E	E	RM	RA	RA
	C				E	E	E	E	E	E	E	E	E	E			
	B				E	E	E	E	E	E	E	E	E	E			
	A				E	E	E	E	E	E	E	E	E	E			

3ACP + 24S + 3ACP

PART NUMBER	ROWS	POWER		SIGNAL					POWER		
		P4	P3	6	5	4	3	2	1	P2	P1
2-1600788-0	D	RM	RM	E	E	E	E	E	E	RM	RM
	C			E	E	E	E	E	E		
	B			E	E	E	E	E	E		
	A			E	E	E	E	E	E		

2ACP+24S+2ACP

PART NUMBER	ROWS	SIGNAL		
		3	2	1
2-1600788-7	D	E	E	E
	C	E	E	E
	B	E	E	E
	A	E	E	E

12S

THIS DRAWING IS A CONTROLLED DOCUMENT. DATE: 10/20/15. DRAWN BY: J. HAYES. CHECKED BY: J. HAYES. APPROVED BY: J. HAYES. SCALE: 1:1. SHEET 6 OF 6. REV: K3.

TE Connectivity
 SQUEEZE TO RELEASE CABLE RECEPTACLE ASSEMBLY W/ LATCHES AND KEY. MULTI-BEAM XL

STATE: CA. DATE: 10/20/15. PART NUMBER: 1600788-0. CUSTOMER DRAWING: A100779@1600788