

THIS DRAWING IS UNPUBLISHED. ALL RIGHTS RESERVED.
 © 2008 BY TYS ELECTRONICS CORPORATION. ALL RIGHTS RESERVED.

REV	DATE	DESCRIPTION	BY	CHK	APP
00					
C		REV PER EC 09-028503			

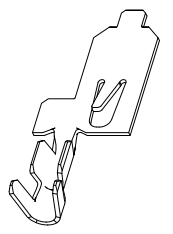
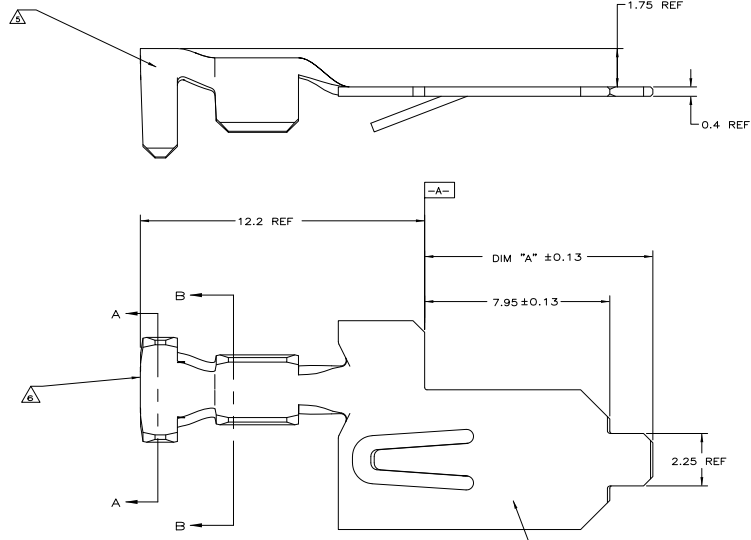
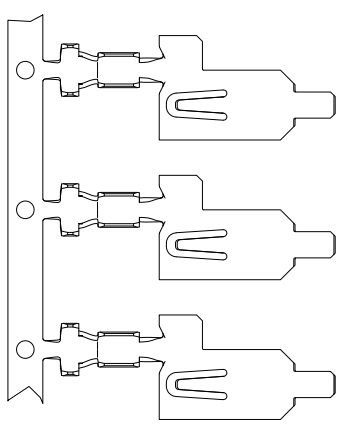

SCALE 5:1

- △ MATERIAL: BRASS
- △ MATERIAL: HIGH CONDUCTIVITY COPPER ALLOY
- △ FINISH: CONTACT MATING AREA .35μm MIN Au;
CRIMP AREA 2.03μm MIN. Sn;
UNDERPLATE OVERALL 1.27μm MIN. Ni
- △ FINISH: CONTACT MATING AREA 1.27μm MIN Au;
CRIMP AREA 2.03μm MIN. Sn;
UNDERPLATE OVERALL 1.27μm MIN Ni
- △ CONTACT SHOWN W/O CARRIER, OR HIDDEN LINES, FOR CLARITY
- △ CUT OFF TO BE .13 MAX
- 7 INSULATION DIAMETER : 2.0-3.1 mm
- 8 WIRE DIAMETER: 16-20 AWG
- △ THIS PRODUCT HAS NOT COMPLETED VALIDATION TESTING.
- △ FINISH: ENTIRE CONTACT 1.27μm MIN Au;
UNDERPLATE OVERALL 1.27μm MIN Ni

SCALE 12:1

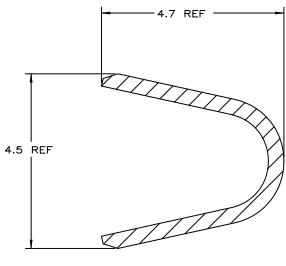

SECTION A-A
SCALE 20:1

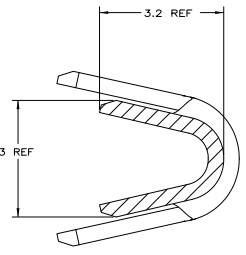

SECTION B-B
SCALE 20:1

REV	DATE	DESCRIPTION	BY	CHK	APP
11.4					
9.8					
11.4					
9.8					
11.4					
9.8					
11.4					
9.8					
11.4					
9.8					
11.4					
9.8					
11.4					
9.8					

THIS DRAWING IS A CONTROLLED DOCUMENT.		DATE: 12 SEP 03		TYS ELECTRONICS CORPORATION Middletown, Pa 17057	
DRAWING NO: 114-13067		PROJECT TITLE: 108-1998		PART NO: 1489128-6	
REV: C		DATE: 09-02-03		DESCRIPTION: MINI POWER DRAWER CRIMP PLUG CONTACT	
BY: [Signature]		CHK: [Signature]		MATERIAL: LOOSE PIECE	
APP: [Signature]		DATE: 09-02-03		FINISH: DIM "A"	
CUST: CUSTOMER DRAWING		SIZE: 4.1		PART NO: 1489128-2	