

4

3

2

1

THIS DRAWING IS UNPUBLISHED. RELEASED FOR PUBLICATION.
 BY TYCO ELECTRONICS CORPORATION. ALL INTERNATIONAL RIGHTS RESERVED.

REV	DATE	BY	APPD
F			
E1	23.01.08	SR	ST
E2	17FEB11	HMR	MM

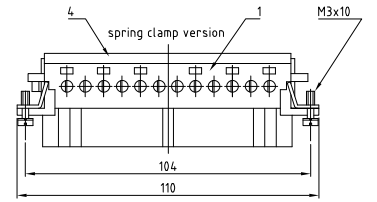
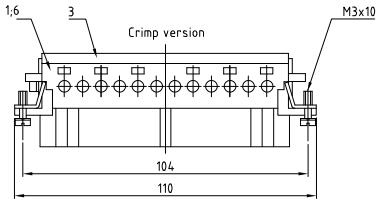
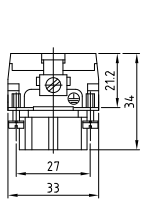
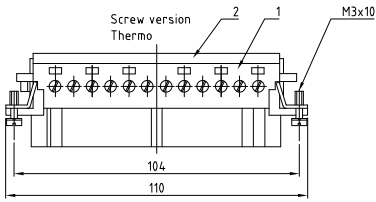

Contact arrangement view from termination side

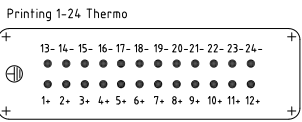

Contact arrangement view from termination side

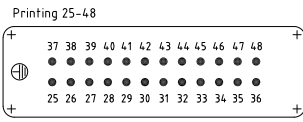
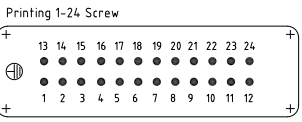
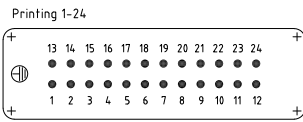

assembly directions

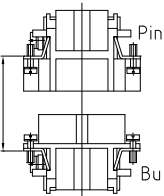

x distance for a safe contact max: max: 21 mm

NOTES:

- SUITABLE CRIMP CONTACTS: SERIES HE/HA OUTER DIMENSIONS OF INSULATION: MAX. Ø3.2 MM
 - SUITABLE HOOD SIZE 8: 12-SERIES HB; HD; HIP; EMV SUITABLE INSERTION AND EXTRACTION TOOL: SCREWDRIVER 0.5x3 DIN 5264
 - Strip length: Screw connection 10mm Spring clamp connection 10mm Crimp connection 7.5mm
 - STANDARDS: DIN EN 61984; DIN EN 60664-1
- PACKAGING: 5 SETS IN A CARTON, PRE-MOUNTED
- SPECIAL PACKAGING: Krauss-Maffei PACKAGING UNIT: 220 PIECES

Panel cut-out for contact insert when used without housing

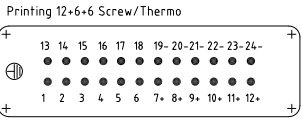
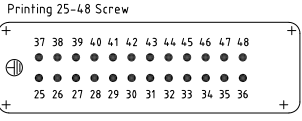
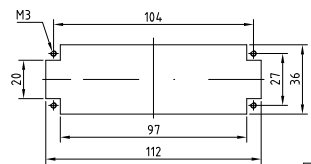

QTY	DESCRIPTION / BENENNUNG	MATERIAL	COLOR / FARB	ITEM NO
1	Socket contact		light grey	5
1	Deckel Federklemmversion		light grey	4
1	Crimp Crimp version		light grey	3
1	Cover screw version		light grey	2
1	Buchseinsatz		light grey	1

THIS DRAWING IS A CONTROLLED DOCUMENT.		DATE: 08.02.2000
DRW: Schneider	CHK: Schneider	DATE: 08.02.2000
APP: Schwilger	DATE: 08.02.2000	
PRODUCT SPEC		
APPLICATION SPEC		
WEIGHT		
CUSTOMER DRAWING		

TYCO ELECTRONICS CORPORATION	DATE: 08.02.2000
Harrisburg, Pa 17105-3608	
DESCRIPTION: Female insert	
HE.24.BU.S/C	
SIZE: A2	CAGE CODE: 1103641
SCALE: 1:1	SHEET: 1 of 1
REV: E2	