

THIS DRAWING IS UNPUBLISHED
 ALL RIGHTS RESERVED

REV	DATE	DESCRIPTION	BY	APP
00				
01		REVISED PER EDD-11-013373		

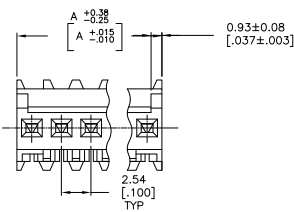
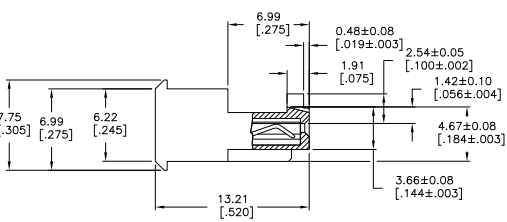
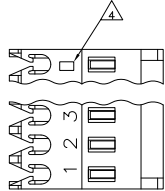

- 1 MATERIAL: CONNECTOR-NYLON UL94V-2 (BLUE).
 CONTACTS-0.30 [.012] THICK COPPER ALLOY
 0.00076 [.00030] GOLD OR 0.00076 [.00030]
 TOTAL GOLD FLASH OVER PALLADIUM NICKEL,
 PER TE CONNECTIVITY'S DISCRETION, IN CONTACT
 AREA WITH BRIGHT TIN-LEAD FOR 644726-2 THRU
 1-644726-5, MATTE WHISKER MITIGATED TIN
 FOR 3-644726-2 THRU 4-644726-5 OVER
 NICKEL UNDERPLATE.
2. CONTACTS ACCEPT 26 AWG WIRE WITH 1.52 [.060] MAX INSULATION DIAMETER.
3. CONTACTS MUST ACCEPT 0.64±0.03 [.025±.001] SQUARE POST AND REMAIN LOCKED IN POSITION.
- 4 IDENTIFICATION NUMBER FOR LAST CIRCUIT MAY NOT APPEAR ON ALL ASSEMBLIES.
5. DIMENSIONS IN BRACKETS ARE IN INCHES.
6. HOUSING FEATURES ARE: FEED THRU WITH LOCKING RAMP AND POLARIZING TAB.
- 7 OBSOLETE PARTS: OBSOLETE CIS STREAMLINING PER D.RENAUD/D.SINISI

DIM A	NO. OF POSN	ASSEMBLY
38.10	[1.500]	15 4-644726-5
35.56	[1.400]	14 4-644726-4
33.02	[1.300]	13 4-644726-3
30.48	[1.200]	12 4-644726-2
27.94	[1.100]	11 4-644726-1
25.40	[1.000]	10 4-644726-0
22.86	[.900]	9 3-644726-9
20.32	[.800]	8 3-644726-8
17.78	[.700]	7 3-644726-7
15.24	[.600]	6 3-644726-6
12.70	[.500]	5 3-644726-5
10.16	[.400]	4 3-644726-4
7.62	[.300]	3 3-644726-3
5.08	[.200]	2 3-644726-2

LEAD FREE

SUPERCEDED

SUPERCEDED

DIM A	NO. OF POSN	ASSEMBLY
38.10	[1.500]	15 1-644726-5
35.56	[1.400]	14 1-644726-4
33.02	[1.300]	13 1-644726-3
30.48	[1.200]	12 1-644726-2
27.94	[1.100]	11 1-644726-1
25.40	[1.000]	10 1-644726-0
22.86	[.900]	9 644726-9
20.32	[.800]	8 644726-8
17.78	[.700]	7 644726-7
15.24	[.600]	6 644726-6
12.70	[.500]	5 644726-5
10.16	[.400]	4 644726-4
7.62	[.300]	3 644726-3
5.08	[.200]	2 644726-2

CONTAINS LEAD

METRIC

THIS DRAWING IS A CONTROLLED DOCUMENT.

TE CONNECTIVITY

TE Connectivity
 MTA .100 CONNECTOR ASSEMBLY,
 26 AWG, STANDARD

114-1019

DATE 100779

REVISED PER EDD-11-013373