

REV	DATE	REVISIONS
0		
1		REVISED PER ECO-11-00524

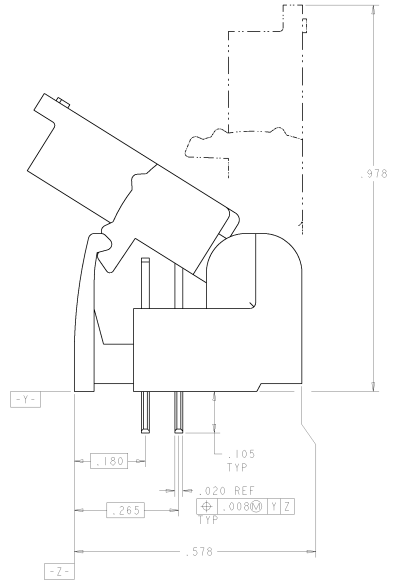

- △ MATERIAL: BASE - POLYESTER MOLDING COMPOUND, BLACK. WIRE STUFFER - POLYCARBONATE MOLDING COMPOUND, SEE TABLE FOR COLOR.
- △ TERMINAL - COPPER ALLOY, PLATED WITH 3.81µm MINIMUM THICK TIN OVER 1.27µm MINIMUM THICK NICKEL UNDERPLATE.
- △ EACH WIRE ENTRY HOLE ACCEPTS ONE UNSTRIPPED SOLID COPPER 22-26 AWG WIRE WITH WIRE INSULATION DIAMETER RANGE FROM .060 THROUGH .040. OTHER WIRE SIZES AND TYPES SHALL BE SUBMITTED TO AMP ENGINEERS FOR APPLICATION APPROVAL.
- 3. SOLDER TABS PROVIDED FOR PERMANENT BOARD MOUNTING.
- △ LOCATION OF HOLE PATTERN DETERMINED BASED ON CUSTOMER REQUIREMENTS.

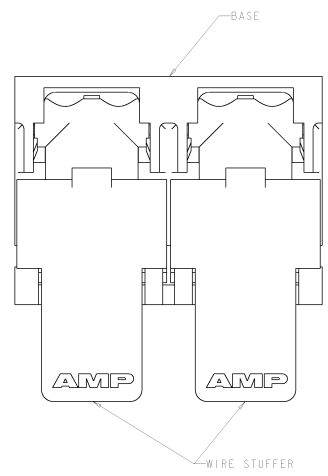
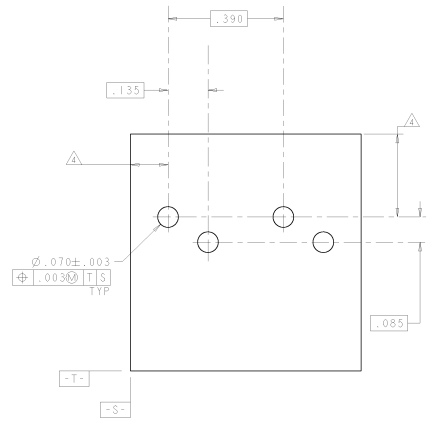
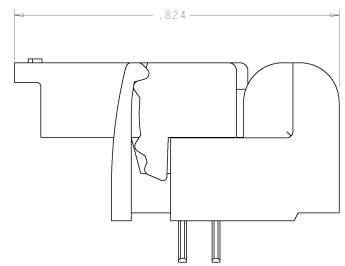
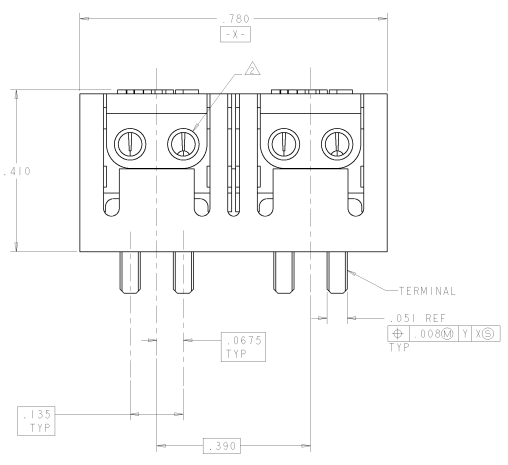

SUGGESTED PRINTED CIRCUIT BOARD MOUNTING DIMENSIONS (VIEWED FROM SOLDER SIDE)

DOUBLE	WHITE	4 PAIR, SH 2	1339376-3
SINGLE	CLEAR	4 PAIR, SH 2	1339376-2
SINGLE	CLEAR	AS SHOWN	1339376-1
ENTRY BASE	STUFFER COLOR	DESCRIPTION	PART NUMBER

UNITS: INCHES	ASSEMBLY	TE Connectivity
MATERIAL: PBT	ASSEMBLY: SINGLE ENTRY, PIVOT II CONNECTOR	REV: A1 00779
REV: 0	DATE: 11/07/99	REV: 0
REV: 1	DATE: 11/07/99	REV: 1
REV: 2	DATE: 11/07/99	REV: 2
REV: 3	DATE: 11/07/99	REV: 3
REV: 4	DATE: 11/07/99	REV: 4
REV: 5	DATE: 11/07/99	REV: 5
REV: 6	DATE: 11/07/99	REV: 6
REV: 7	DATE: 11/07/99	REV: 7
REV: 8	DATE: 11/07/99	REV: 8
REV: 9	DATE: 11/07/99	REV: 9
REV: 10	DATE: 11/07/99	REV: 10
REV: 11	DATE: 11/07/99	REV: 11
REV: 12	DATE: 11/07/99	REV: 12
REV: 13	DATE: 11/07/99	REV: 13
REV: 14	DATE: 11/07/99	REV: 14
REV: 15	DATE: 11/07/99	REV: 15
REV: 16	DATE: 11/07/99	REV: 16
REV: 17	DATE: 11/07/99	REV: 17
REV: 18	DATE: 11/07/99	REV: 18
REV: 19	DATE: 11/07/99	REV: 19
REV: 20	DATE: 11/07/99	REV: 20
REV: 21	DATE: 11/07/99	REV: 21
REV: 22	DATE: 11/07/99	REV: 22
REV: 23	DATE: 11/07/99	REV: 23
REV: 24	DATE: 11/07/99	REV: 24
REV: 25	DATE: 11/07/99	REV: 25
REV: 26	DATE: 11/07/99	REV: 26
REV: 27	DATE: 11/07/99	REV: 27
REV: 28	DATE: 11/07/99	REV: 28
REV: 29	DATE: 11/07/99	REV: 29
REV: 30	DATE: 11/07/99	REV: 30
REV: 31	DATE: 11/07/99	REV: 31
REV: 32	DATE: 11/07/99	REV: 32
REV: 33	DATE: 11/07/99	REV: 33
REV: 34	DATE: 11/07/99	REV: 34
REV: 35	DATE: 11/07/99	REV: 35
REV: 36	DATE: 11/07/99	REV: 36
REV: 37	DATE: 11/07/99	REV: 37
REV: 38	DATE: 11/07/99	REV: 38
REV: 39	DATE: 11/07/99	REV: 39
REV: 40	DATE: 11/07/99	REV: 40
REV: 41	DATE: 11/07/99	REV: 41
REV: 42	DATE: 11/07/99	REV: 42
REV: 43	DATE: 11/07/99	REV: 43
REV: 44	DATE: 11/07/99	REV: 44
REV: 45	DATE: 11/07/99	REV: 45
REV: 46	DATE: 11/07/99	REV: 46
REV: 47	DATE: 11/07/99	REV: 47
REV: 48	DATE: 11/07/99	REV: 48
REV: 49	DATE: 11/07/99	REV: 49
REV: 50	DATE: 11/07/99	REV: 50

