

4

3

2

1

THIS DRAWING IS UNPUBLISHED. RELEASED FOR PUBLICATION.
 © COPYRIGHT - By - ALL RIGHTS RESERVED.

LOC	DIST	REVISIONS				
FT	0	F	LR	DATE	MIN	APD
		R2	REVISED PER ECO-11-018934	01OCT11	KH	MZ

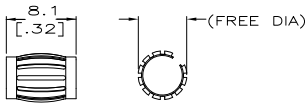

STYLE B
(MALE)

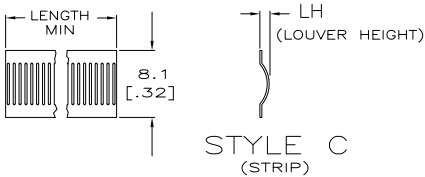

STYLE C
(STRIP)

1. FINISH-SILVER PLATE 200 μIN MIN THICK.
 2. FINISH-NICKEL PLATE 40 μIN MIN THICK.
 3. FINISH-GOLD PLATE 10 μIN MIN THICK.
 4. FINISH-GOLD PLATE 50 μIN MIN THICK.
 5. FINISH-CADMIUM PLATE 300 μIN MIN THICK.
 6. FINISH-NICKEL PLATE 100 μIN MIN THICK.
 7. FINISH-TIN PLATE 300 μIN MIN THICK.
 - 8.
 - 9.
 - 10.
 11. PLATING NOTES ARE TO BE INTERPRETED AS FOLLOWS, 6-8 AS 6 OVER 8.
 12. PRODUCT IS SOLD BY THE FOOT.
 13. 12 FOOT STRIP WOUND TO A ONE INCH INSIDE DIAMETER.
 14. MATERIAL-BeCu (CDA172).
 15. MATERIAL-STAINLESS STEEL.
 16. CUT LENGTH 508.0 [20.00] APPROXIMATELY 714 LOUVERS.
- 17. BAND WIDTH .310±.005 FOR P/N 6-192042-6.
 - 18. FINISH - GOLD PLATE 30μIN MIN THICK.
 - 19. OVERLAPPED WITH GAP.
 - 20. OBSOLETE PARTS: OBSOLETE CIS STREAMLINING PER D.RENAUD/D.SINISI
 - 21. PRILIMINARY PART

QTY	DESCRIPTION	DATE	MIN	APD
△	OBSOLETE .022	04133	4-192042-7	
△	OBSOLETE .022	04054	4-192042-6	
△	OBSOLETE .022	04100	4-192042-5	
△	OBSOLETE .022	04156	4-192042-4	
△	OBSOLETE .022	04101	4-192042-3	
△	OBSOLETE .024	04132	4-192042-2	
△	OBSOLETE .024	04131	4-192042-1	
△	OBSOLETE .024	04048	4-192042-0	
△	OBSOLETE .024	04173	3-192042-9	
△	OBSOLETE .026	04043	3-192042-8	
△	OBSOLETE .026	04135	3-192042-7	
△	OBSOLETE .026	04039	3-192042-6	
△	OBSOLETE .026	04134	3-192042-5	
△	OBSOLETE .032	04034	3-192042-4	
△	OBSOLETE .032	04033	3-192042-3	
△	OBSOLETE .032	04032	3-192042-2	
△	OBSOLETE .032	04063	3-192042-1	
△	OBSOLETE .022	04130	3-192042-0	
△	OBSOLETE .022	04155	2-192042-9	
△	OBSOLETE .022	04088	2-192042-8	
△	OBSOLETE .022	04088	2-192042-7	
△	OBSOLETE .022	04087	2-192042-6	
△	OBSOLETE .022	04089	2-192042-5	
△	OBSOLETE .022	04026	2-192042-4	
△	OBSOLETE .022	04022	2-192042-3	
△	OBSOLETE .022	04021	2-192042-2	
△	OBSOLETE .022	04018	2-192042-1	
△	OBSOLETE .026	04016	2-192042-0	
△	OBSOLETE .026	04014	1-192042-9	
△	OBSOLETE .022	04012	1-192042-8	
△	OBSOLETE .022	04011	192042 -7	
△	OBSOLETE .026	04152	1-192042-6	
△	OBSOLETE .026	04171	1-192042-5	
△	OBSOLETE .026	04219	1-192042-4	
△	OBSOLETE .020	04153	1-192042-3	
△	OBSOLETE .020	04150	1-192042-2	
△	OBSOLETE .026	04151	1-192042-1	
△	OBSOLETE .028	04175	1-192042-0	
△	OBSOLETE .028	04127	192042-9	
△	OBSOLETE .028	04160	192042-8	
△	OBSOLETE .028	04161	192042-7	
△	OBSOLETE .026	04003	192042-6	
△	OBSOLETE .026	04217	192042-5	
△	OBSOLETE .026	04085	192042-4	
△	OBSOLETE .026	04141	192042-3	
△	OBSOLETE .016	--	192042-2	
△	OBSOLETE .016	04181	192042-1	

LH	LENGTH	STYLE	(FREE DIA)	MAT'L NOTE	MATING HOLE φ	REF	NUM LOUV	PLATING	MAT'L THK	REF	PART NO.

THIS DRAWING IS A CONTROLLED DOCUMENT. **TE** TE Connectivity

DATE: 06-12-92
 CHK: J. JAYNE
 DATE: 07-21-93
 P/NO: J. LURNER
 DATE: 07-21-93
 NAME: S. SIGURIST

PRODUCT SPEC: CONTACT BAND, MALE

APPLICATION SPEC: --

SIZE: A2
 CASE CODE: 00779
 DRAWING NO: 192042

RESTRICTED TO: --

WEIGHT: --

CUSTOMER DRAWING
 SCALE: 1:1
 SHEET: 1 of 2
 REV: R2

