

REV. NO.	DATE	BY	CHK	APPV
A1	-	LM		
D2		MCP 1.5, 1534334 ADDED		
E1		Aufnahmegeh. optimiert		

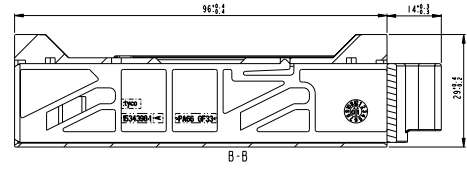

- Notes
- SUITABLE TAB HEADER 1534046
 - USED WITH HOUSING 1534181
 - SUITABLE CONTACTS
 - MCP 1.5: 1241372, 1241374, 1534334
 - MCP 2.8: 1241386, 1241388, 1241390
 - MCP 4.8: 1241400, 1241402, 1241404, 1241406
 - FORM CONDITIONED DELAY OF +0.3 -0.6 ADMISSABLE

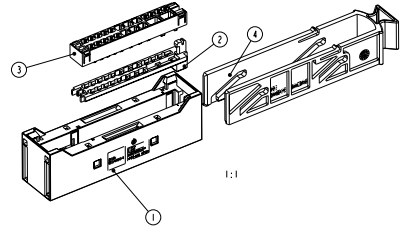
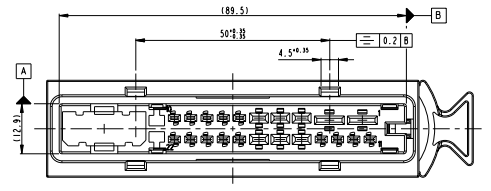
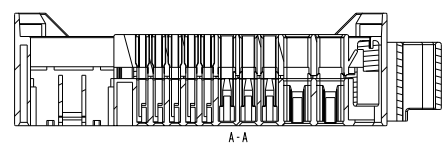

- Bemerkungen
- Passende Stiflleiste 1534046
 - Verwendet mit Gehäuse 1534181
 - Passende Kontakte
 - MCP 1.5: 1241372, 1241374, 1534334
 - MCP 2.8: 1241386, 1241388, 1241390
 - MCP 4.8: 1241400, 1241402, 1241404, 1241406
 - Formbedingter Verzug zul. +0.3 -0.6

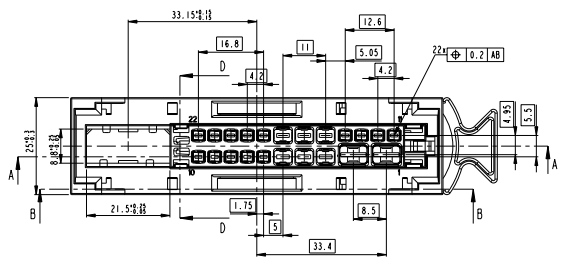
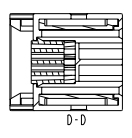

ORDER NO.	Rev.	Material	COLOUR	DESCRIPTION	QTY.	LITER
1534399-1	E	PA66-GF33	BLACK / schwarz	SLIDE / Schieber	1	4
		PA66-GF13	BLACK / schwarz	HOLDER-PLATE / Halteplatte	1	3
		PA66-GF30	VIOLET / violett	RETAINER / Halter	1	2
		PBT+ASA-GF20	BLACK / schwarz	CARRIER HSG. / Aufnahmegeh.	1	1

ORDER NO. 1534399-1 REV. E MATERIAL PA66-GF33 COLOUR BLACK / schwarz DESCRIPTION SLIDE / Schieber QTY. 1 LITER 4	ORDER NO. 1534399-1 REV. E MATERIAL PA66-GF13 COLOUR BLACK / schwarz DESCRIPTION HOLDER-PLATE / Halteplatte QTY. 1 LITER 3	ORDER NO. 1534399-1 REV. E MATERIAL PA66-GF30 COLOUR VIOLET / violett DESCRIPTION RETAINER / Halter QTY. 1 LITER 2	ORDER NO. 1534399-1 REV. E MATERIAL PBT+ASA-GF20 COLOUR BLACK / schwarz DESCRIPTION CARRIER HSG. / Aufnahmegeh. QTY. 1 LITER 1
--	--	--	--