

THIS DRAWING IS UNPUBLISHED. RELEASED FOR PUBLICATION 2000  
 © COPYRIGHT 2000 BY TYCO ELECTRONICS CORPORATION. ALL RIGHTS RESERVED.

CONTACT ARRANGEMENT  
 VIEW FROM CONNECTING SIDE

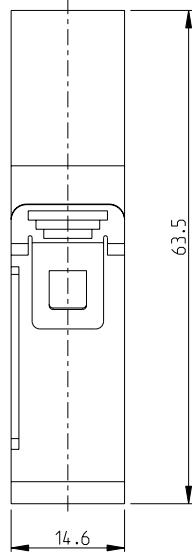

CONTACT ARRANGEMENT VIEW  
 FROM TERMINATION SIDE

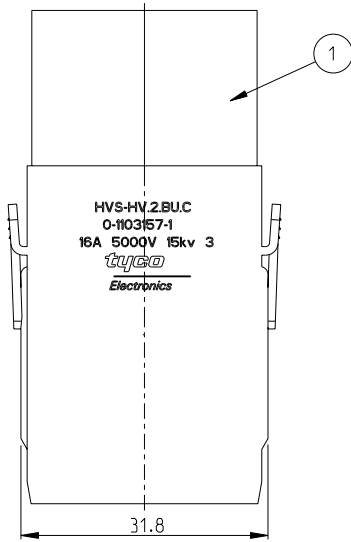
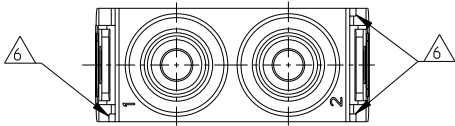
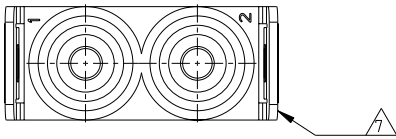

LOC	DIST	REVISIONS					
		P	LTR	DESCRIPTION	DATE	DNW	APVD
A1		B1		ECR-10-023156	10NOV2010	SR	OH

NOTES

- SUITABLE CRIMP CONTACTS: SERIES HVT  
 CUSTOMER DRAWING: 1105301  
 OUTER DIMENSIONS OF INSULATION: MAX. Ø7.4mm
- SUITABLE MODULE FIXING FRAME: SERIES HVS SIZE 3 TO 8  
 CUSTOMER DRAWING: 1103250
- SUITABLE INSERTION TOOL:  
 CUSTOMER DRAWING: 1102855
- SUITABLE EXTRACTION TOOL:  
 CUSTOMER DRAWING: 1102855
- STANDARDS:  
 DIN EN 61984; DIN EN 60664-1
- POLARIZATION RIBS
- MARKING OF POLARIZATION ACCORDING TO MARKING OF MODULE FRAME
- PACKAGING:  
 10 PIECES IN A CARTON, PRE-MOUNTED

PN 0-1 AS SHOWN

1	FEMALE INSERT	PC-GF20	LIGHT GREY	-	1
QTY	DESCRIPTION	MATERIAL	COLOR	NOTE	ITEM NO
	HVS-HV.2.BU.C				

<small>THIS DRAWING IS A CONTROLLED DOCUMENT FOR TYCO ELECTRONICS CORPORATION                  IT IS SUBJECT TO CHANGE AND THE CONTROLLING ENGINEERING ORGANIZATION                  SHOULD BE CONTACTED FOR THE LATEST REVISION.</small>		OWN 13.02.2006 CHK T.SCHNURPFIL 13.02.2006 APVD T.SCHNURPFIL 13.02.2006	Tyco Electronics AMP GmbH 53757 Sankt Augustin, Germany
DIMENSIONS: mm 	TOLERANCES UNLESS OTHERWISE SPECIFIED: 0 P.L.C. ± 1 P.L.C. ± 2 P.L.C. ± 3 P.L.C. ± 4 P.L.C. ± ANGLES ±	NAME FEMALE INSERT HVS-HV.2.BU.C	RESTRICTED TO
MATERIAL 	FINISH 	PRODUCT SPEC 108-74.075 APPLICATION SPEC 114-74.074	SIZE CAGE CODE DRAWING NO A3 00779 C-1103157
CUSTOMER DRAWING		SCALE 2:1	SHEET 1 OF 1 REV B1