

NO.	REV.	DESCRIPTION	DATE	BY	CHK.
1	1	Released as per EC8-08-019227	16.03.2008	SP	TS

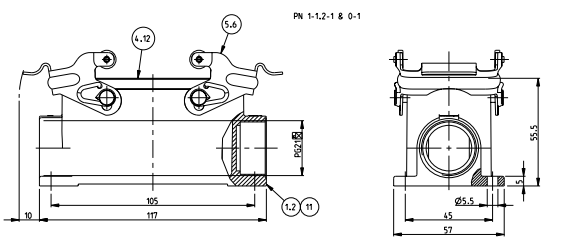

- NOTES:
- Material:Housing:Aluminium Diecasting Alloy
Seals:Neoprene,Viton
 - Surface:Varnish
-Aluminium Oxide -Varnish Black
-W/Flout varnish
-Grey
 - Varnish on the inside not necessary
 - Packaging
Quantity 5 Pieces in a box

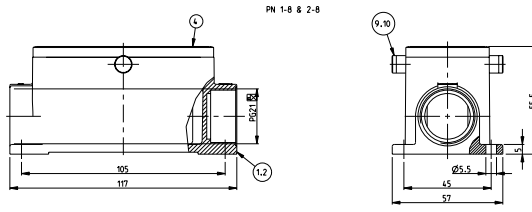
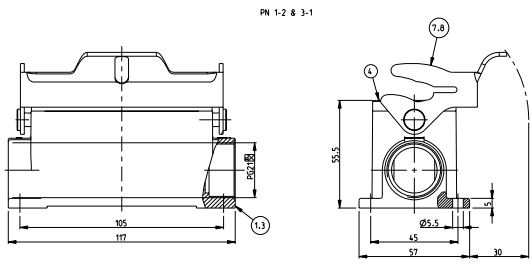
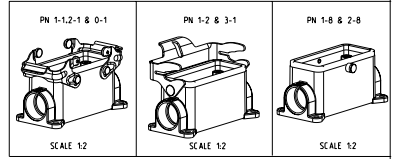

QTY	NO.	DESCRIPTION	MATERIAL	SURFACE	COLOR	ITEM NO.	REMARKS					
1		Profile seat	Viton		Light grey	12						
1		Surface mounted housing side entry HB-X	Aluminium		Blank	11						
1	2	ZB-Clip bolt	Stainless steel			10						
1	2	ZB-Clip bolt	Steel	Zinc plated		9						
1	1	LB-Side clip	Stainless steel			8						
1	1	LB-Side clip	Steel	Zinc plated		7						
1	2	VS-Locking Clip	Stainless steel			6						
1	2	VS-Locking Clip	Steel	Zinc plated		5						
1	1	1	1	1	1	1	Profile seat	Neoprene		Black	4	
1	1	1	1	1	1	1	Surface mounted housing side entry HB-X	Aluminium	Aluminium oxide	Black	3	
1	1	1	1	1	1	1	Surface mounted housing side entry HB	Aluminium		Grey	2	

ORDERING TEXT:
 HB-X-16-SG-VS-1.21.Z
 HB-16-SG-VS-1.21.Z
 HB-16-SG-VS-1.21.Z
 HB-16-SG-VS-1.21.Z
 HB-16-SG-VS-1.21.Z
 HB-16-SG-VS-1.21.Z
 HB-16-SG-VS-1.21.Z
 HB-16-SG-VS-1.21.Z
 HB-16-SG-VS-1.21.Z

DATE: 05.03.1999
 DRAWING NO: HB.16.1.21.2
 SURFACE MOUNTED HOUSING SIDE ENTRY
 HB.16.1.21.2
 CUSTOMER DRAWING