

4

3

2

1

THIS DRAWING IS UNPUBLISHED. RELEASED FOR PUBLICATION
 © COPYRIGHT - By - ALL RIGHTS RESERVED.

LOC	DIST	REVISIONS		
P	LTR	DESCRIPTION	DATE	BY
F		UPDATE PER ECO-11-013272	28 JUN 11	CAS/MKS

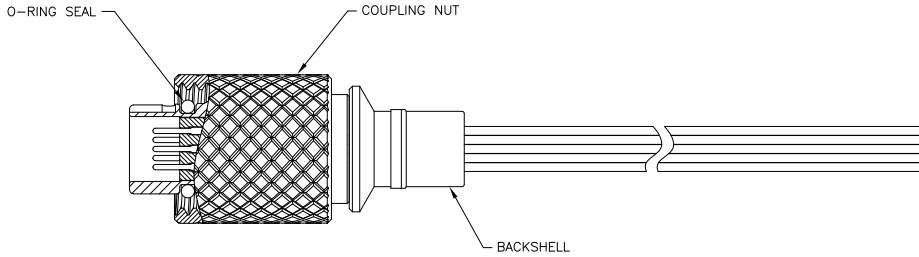
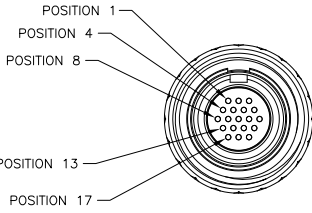
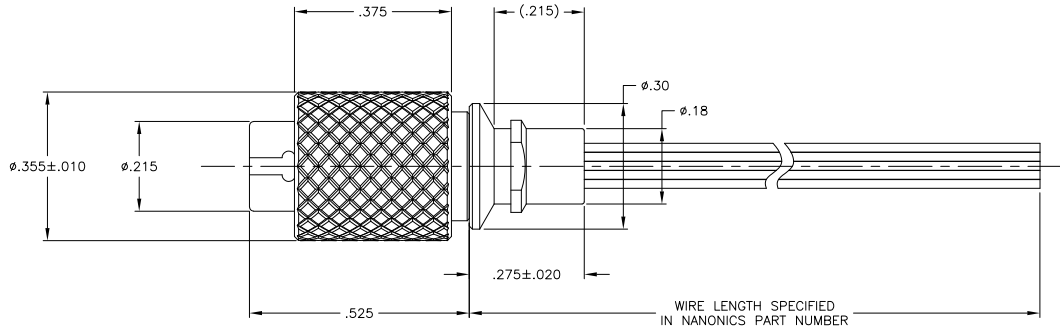

- CONNECTOR BODY, COUPLING NUT & BACKSHELL MATERIAL: 6061-T6 ALUMINUM, ELECTROLESS NICKEL PLATED PER SAE-AMS-C-26074 OR SAE-AMS-2404E
 LOCKING RING MATERIAL: BERYLLIUM COPPER, ELECTROLESS NICKEL PLATED PER SAE-AMS-C-26074 OR SAE-AMS-2404E
 INSULATOR MATERIAL: LIQUID CRYSTAL POLYMER (LCP) PER ASTM D5138 OR POLYPHENYLENE SULFIDE (PPS) PER ASTM D4067
 O-RING MATERIAL: FLUOROSILICONE
- WIRE TERMINATION: 28 AWG SOLID, 30 AWG STRANDED WIRE OR SMALLER
- BONDING RESISTANCE BETWEEN CONNECTOR BODY AND BACKSHELL TO BE 25 MILLIOHMS MAXIMUM. BACKSHELL TO BE BONDED TO PLUG SHELL WITH CONDUCTIVE EPOXY.
- LUBRICATE O-RING WITH PARKER SUPER-O-LUBE PRIOR TO INSTALLATION
- THIS DRAWING ALSO IDENTIFIED AS NANONICS 303-0091

THIS DRAWING IS A CONTROLLED DOCUMENT.		DR. C. SCHOLL 11 JUN 01	
DIMENSIONS: INCHES		CHK. M. STORRY 13 JUN 01	
0 PLC ± .005 1 PLC ± .005 2 PLC ± .010 3 PLC ± .005 4 PLC ± .010 ANGLES ± .1°		NAME: M. STORRY PRODUCT SPEC: -- APPLICATION SPEC: -- HEIGHT: --	PLUG ASSEMBLY, CIRCULAR, THREADED COUPLING, STRAIGHT BACKSHELL, METAL, 19 POSITION
MATERIAL: SEE NOTES		FINISH: SEE NOTES	SIZE: CASE CODE (DRAWING NO) A20PJN9C=1589688
CUSTOMER DRAWING		SCALE: 6:1	SHEET: 1 of 1 REV: F

1471-9 (3/11)

1589688

A