

4

3

2

1

THIS DRAWING IS UNPUBLISHED.
 RELEASED FOR PUBLICATION
 ALL RIGHTS RESERVED.

LOC	DIST	REVISIONS		DATE	BY	APPD
J	-	F	LR	DESCRIPTION		
		A1		REVISED PER ECO-11-005140	30MAR11	RK HMR

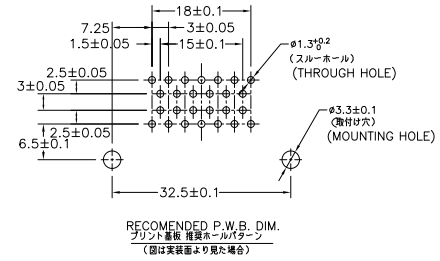
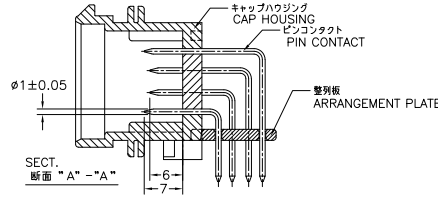
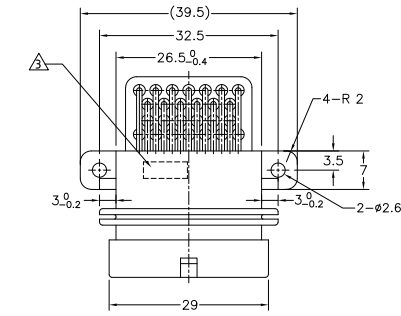

RECOMMENDED P.W.B. DIM.
 プラント基板 推奨ホールパターン
 (図は実装面より見た場合)

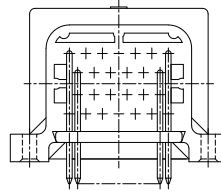
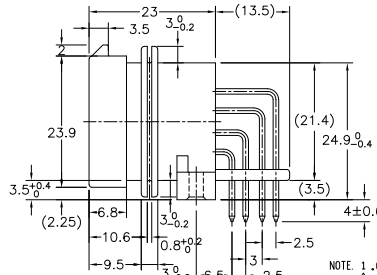
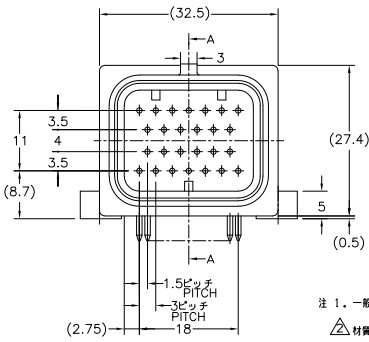

注 1. 一般公差: ±0.3

NOTE 1. GENERAL TOLERANCE: ±0.3

- △材質 キヤップハウジング: 熱可塑性ポリエステル樹脂
 整列板: 熱可塑性ポリエステル樹脂
 ピンコンタクト: 真鍮/ニッケル下地、金めっき (接点部)
 はんだめっき (基板側)
- △当箇所には製造日管理番号 (ロット番号) を印字する。
- 4. 基板取付けねじ
 JIS B 1122 十字穴付きタッピンねじ なべ2種 3xL (L=6.5+基板厚)
 先端溝付き及び溝無し (亜鉛メッキ)
 上記以外のねじを使用の場合、別途打ち合わせの事。
- △材質 キヤップハウジング: 熱可塑性ポリエステル樹脂
 整列板: 熱可塑性ポリエステル樹脂
 ピンコンタクト: 真鍮/ニッケル下地、金めっき (接点部)
 すずめっき (基板側)
- 6. 嵌合相手型番: TABLE-1 参照

- △MATERIAL
 CAP HOUSING - POLYESTER
 ARRANGEMENT PLATE - POLYESTER
 PIN CONTACT - BRASS GOLD PLATING OVER NI PLATING (CONTACT PART)
 BRASS TIN-LEAD PLATING OVER NI PLATING (SOLDERING PART)
 AS FOLLOWING IS INDICATED.
- 4. MOUNTING SCREW
 JIS B 1122 (CROSS RECESSED PAN HEAD TAPPING SCREW (ZINC PLATING)
 TYPE 2 3xL (L=6.5+BOARD THICKNESS))
- △MATERIAL
 CAP HOUSING - POLYESTER
 ARRANGEMENT PLATE - POLYESTER
 PIN CONTACT - BRASS GOLD PLATING OVER NI PLATING (CONTACT PART)
 BRASS TIN PLATING OVER NI PLATING (SOLDERING PART)
- 6. PART NUMBER OF PLUG ASSEMBLY TO BE MATED: SEE TABLE-1

9-6437287-9	△	-	-
9-6437287-8	△	-	本 図
6473423-2	△	-	SEE DWG14.734.23
6473423-1	△	-	SEE DWG14.734.23
OBsolete	△	1473423-2	SEE DWG14.734.23
OBsolete	△	1473423-1	SEE DWG14.734.23
OBsolete	△	9-1437287-9	3900134-2612
OBsolete	△	9-1437287-8	3900134-2611
		Part No.	Old Part No.
		型番	旧型番
			REMARK
			備考

9-6437287-9	3-1437290-8
9-1437287-9	
9-6437287-8	3-1437290-7
9-1437287-8	
PART NUMBER	MATING PLUG ASSEMBLY

TABLE-1

THIS DRAWING IS A CONTROLLED DOCUMENT.

DWG (AISHIJIMA)	1000T00
CHK (K. SHINADA)	1000T00
APPD (K. SHINADA)	1000T00
PRODUCT SPEC	BR1408-78140
APPLICATION SPEC	取付仕様
WEIGHT	-
CUSTOMER DRAWING	

TE Connectivity
 SUPER SEAL CONNECTOR (UPPER LOCK)
 CAP HOUSING 26POS. ASSY

SIZE CASE CODE DRAWING NO. RESTRICTED TO
 A2 00779 9-1437287-8

SCALE 2:1 SHEET 1 of 3 REV A1

THIS DRAWING IS UNPUBLISHED.
 © COPYRIGHT - By -
 RELEASED FOR PUBLICATION
 ALL RIGHTS RESERVED.

LOC	DIST	REV	DESCRIPTION	DATE	BY	APPD
J	-	F	LR	-	-	-
-	-	-	SEE SHEET 1	-	-	-

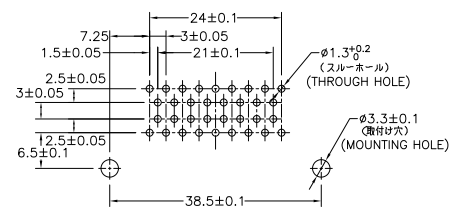
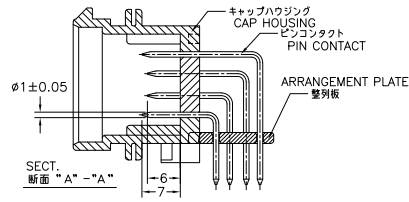
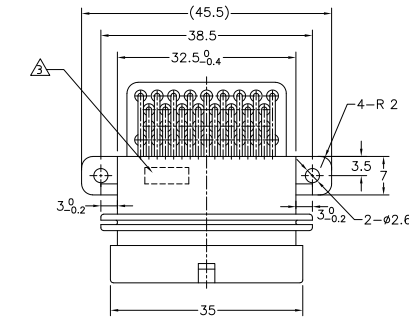

RECOMMENDED P.W.B. DIM.
 プリント基板 推奨ホールパターン
 (図は実装面より見た場合)

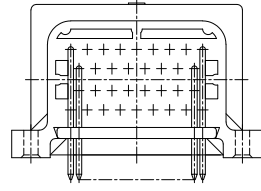
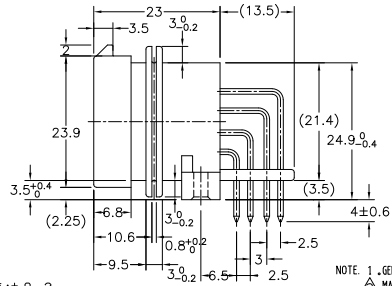
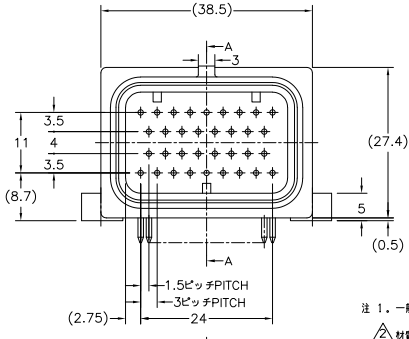

注 1. 一般公差: ± 0.3

NOTE 1. GENERAL TOLERANCE: ± 0.3

- △ 材質 キャップハウジング: 熱可塑性ポリエステル樹脂
- △ 整列板: 熱可塑性ポリエステル樹脂
- △ ピンコンタクト: 真鍮/ニッケル下地, 金めっき (接点部)
- △ はんだめっき (基板側)
- △ 当箇所は製造日管理番号 (ロット番号) を印字する。
- 4. 基板取付けねじ
 JIS B 1122 十字穴付きタッピンねじ なべ2種 3xL (L=6, 5+基板厚)
 先端溝付き及び溝無し (垂鉛メッキ)
 上記以外のねじを使用の場合、別途打ち合わせの事。
- △ 材質 キャップハウジング: 熱可塑性ポリエステル樹脂
- △ 整列板: 熱可塑性ポリエステル樹脂
- △ ピンコンタクト: 真鍮/ニッケル下地, 金めっき (接点部)
- △ はんだめっき (基板側)

- △ MATERIAL
- △ CAP HOUSING - POLYESTER
- △ ARRANGEMENT PLATE - POLYESTER
- △ PIN CONTACT - BRASS GOLD PLATING OVER NI PLATING (CONTACT PART)
- △ BRASS TIN-LEAD PLATING OVER NI PLATING (SOLDERING PART)
- △ MANUFACTURED DATE CONTROL NO.(LOT NO.)
- AS FOLLOWING IS INDICATED.
- 4. MOUNTING SCREW
 JIS B 1122 CROSS RECESSED PAN HEAD TAPPING SCREW (ZINC PLATING)
 TYPE 2 3xL (L=6+BOARD THICKNESS)
- △ MATERIAL
- △ CAP HOUSING - POLYESTER
- △ ARRANGEMENT PLATE - POLYESTER
- △ PIN CONTACT - BRASS GOLD PLATING OVER NI PLATING (CONTACT PART)
- △ BRASS TIN PLATING OVER NI PLATING (SOLDERING PART)

6. 嵌合相手型番: TABLE-1 参照

6437288-2	4-1437290-1
1437288-2	
6437288-1	4-1437290-0
1437288-1	
PART NUMBER	MATING PLUG ASSEMBLY

TABLE-1

6437288-2	-	-	-
6437288-1	-	-	本 図
OBSOLETE 1437288-2	3900134-3412	-	-
OBSOLETE 1437288-1	3900134-3411	-	本 図
Part No.	Old Part No.	REMARK	
型番	旧型番	備考	

THIS DRAWING IS A CONTROLLED DOCUMENT.

DIMENSIONS 単位: ㎜ mm	TOLERANCES UNLESS OTHERWISE SPECIFIED	DWG CHK APPD	NAME NO. 8-78140
0 PLC ±	一般公差	PRODUCT SPEC	TE Connectivity
1 PLC ±		APPLICATION SPEC	SUPERSEAL コネクタ(上ロック)キャップハウジング 34PIN ASS'Y SUPER SEAL CONNECTOR (UPPER LOCK) CAP HOUSING 34POS. ASS'Y
2 PLC ±		SIZE	A2
3 PLC ±		ONE CODE	00779
4 PLC ±		FORMING NO.	9-1437287-8
ANGLES		RESTRICTED TO	
FINISH		SCALE	2:1
FINISH		SHEET	2 of 3
SEE TABLE		CUSTOMER DRAWING	REV A1

4

3

2

1

THIS DRAWING IS UNPUBLISHED. RELEASED FOR PUBLICATION ALL RIGHTS RESERVED.

LOC	DIST	REVISIONS		DATE	DWN	APPD
		NO.	DESCRIPTION			
J	-	F	LR	-	-	-
			SEE SHEET 1	-	-	-

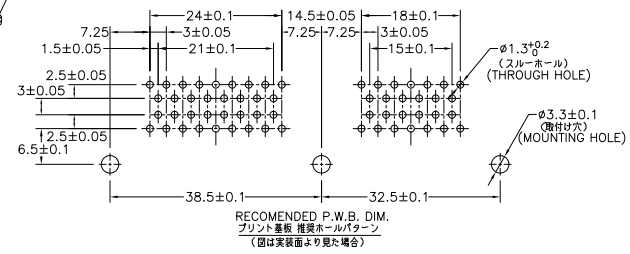
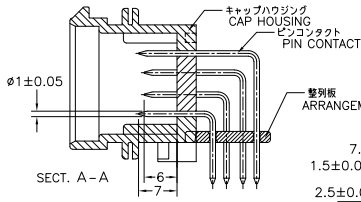
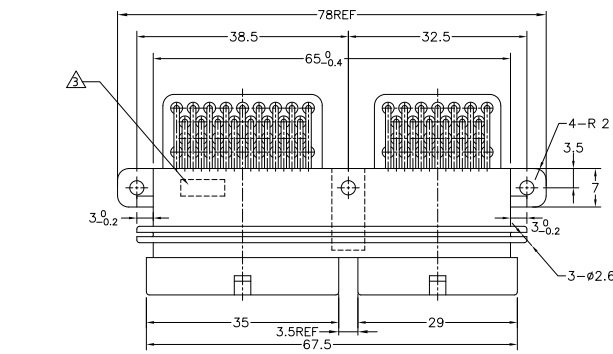

RECOMMENDED P.W.B. DIM.
プリント基板 推奨ホールパターン
(図は裏面より見た場合)

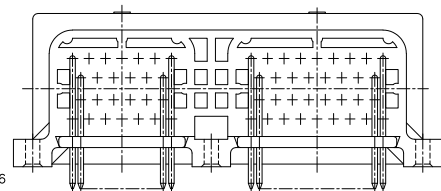
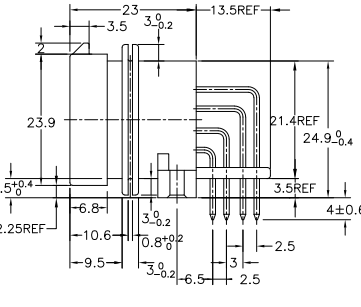
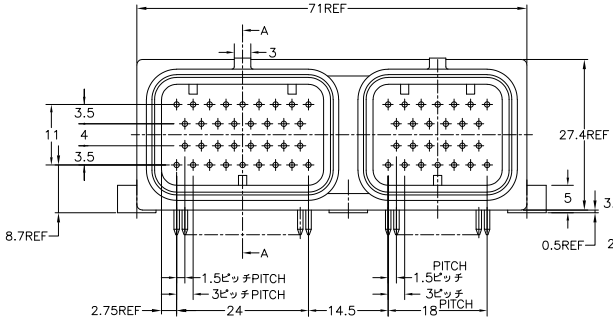

注 1. 一般公差: ±0.3

- △ 材質 キャップハウジング: 熱可塑性ポリエステル樹脂
- △ 整列板: 熱可塑性ポリエステル樹脂
- △ ピンコンタクト: 真鍮/ニッケル下地, 金めっき (接点部) はんだめっき (基板側)

- △ 当箇所は製造日管理番号 (ロット番号) を印字する。
- 4. 基板取付けねじ
JIS B 1122 十字穴付きタッピングねじ ね2種 3xL (L=6.5+基板厚)
先端溝付き及び溝無し (垂鉛メッキ)
上記以外のねじを使用の場合、別途打ち合わせの事。

- △ 材質 キャップハウジング: 熱可塑性ポリエステル樹脂
- △ 整列板: 熱可塑性ポリエステル樹脂
- △ ピンコンタクト: 真鍮/ニッケル下地, 金めっき (接点部) すずめっき (基板側)

6. 嵌合相手型番: TABLE-1 参照

NOTE 1. GENERAL TOLERANCE: ±0.3

- △ MATERIAL
CAP HOUSING: POLYESTER
ARRANGEMENT PLATE: POLYESTER
PIN CONTACT: BRASS GOLD PLATING OVER NI PLATING (CONTACT PART)
BRASS TIN-LEAD PLATING OVER NI PLATING (SOLDERING PART)
- △ MANUFACTURED DATE CONTROL NO.(LOT NO.)
AS FOLLOWING IS INDICATED.

- 4. MOUNTING SCREW
JIS B 1122 CROSS RECESSED PAN HEAD TAPPING SCREW (ZINC PLATING)
TYPE 2 3xL (L=6.5+BOARD THICKNESS)

- △ MATERIAL
CAP HOUSING: POLYESTER
ARRANGEMENT PLATE: POLYESTER
PIN CONTACT: BRASS GOLD PLATING OVER NI PLATING (CONTACT PART)
BRASS TIN PLATING OVER NI PLATING (SOLDERING PART)

6. PART NUMBER OF PLUG ASSEMBLY TO BE MATED: SEE TABLE-1

6437288-3	3-1437290-7 (26Pos.)
1437288-3	4-1437290-0 (34Pos.)
PART NUMBER	MATING PLUG ASSEMBLY

TABLE-1

6473427-1	-	SEE DWG1473427
6437288-3	-	本 図
OBSOLETE 1473427-1	-	SEE DWG1473427
OBSOLETE 1437288-3	3900134-6011	本 図
Part No. 型 番	Old Part No. 旧 型 番	REMARK 備 考

THIS DRAWING IS A CONTROLLED DOCUMENT.

DWG (A)SHIJIMA	1000T00	DATE	1000T00
CHK K. SHINADA	1000T00	NAME	TE Connectivity
APPD K. SHINADA	1000T00	PRODUCT SPEC	TE SUPERSEAL コネクタ (上ロック) キャップハウジング 60pos ASSY
PRODUCT SPEC	TE 8-78140	APPLICATION SPEC	SUPER SEAL CONNECTOR (UPPER LOCK)
TE 8-78140		REVISIONS	CAP HOUSING 60POS. ASSY
SIZE	A2	SCALE	2:1
WEIGHT		SHEET	3 of 3
MATERIAL	SEE TABLE	FINISH	注 1
RESTRICTED TO		REV	A1

CUSTOMER DRAWING