

REV		REVISIONS			
NO	DATE	DESCRIPTION	BY	CHK	APP
BV	00	CS REVISED PER ECO-11-005030			

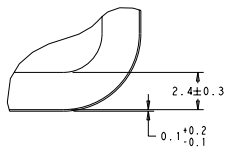
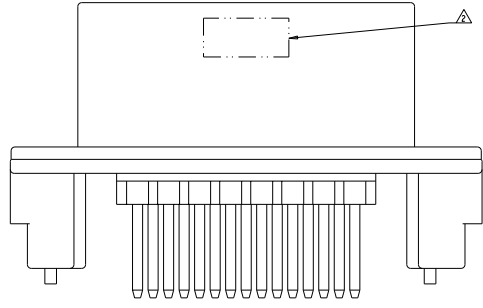
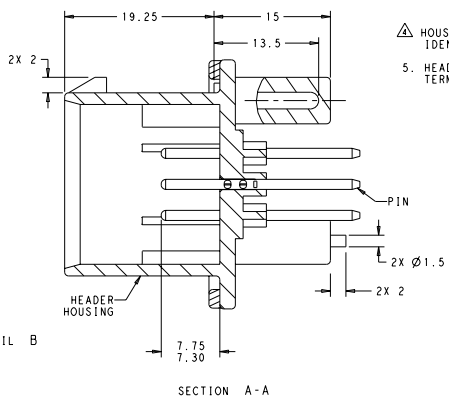
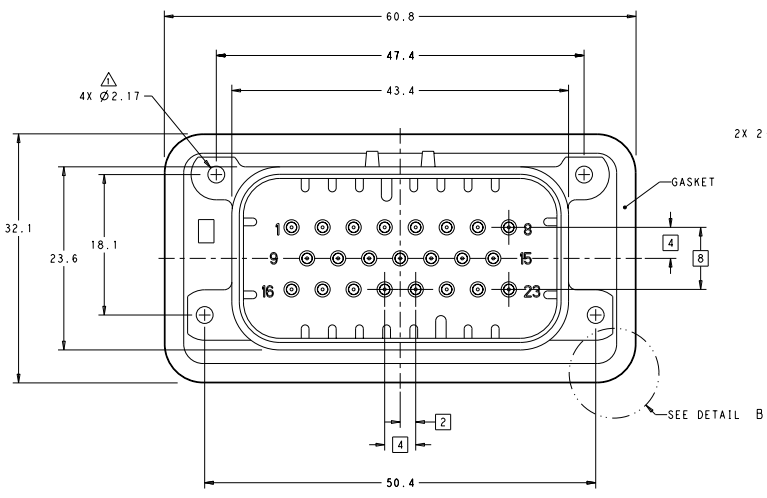

DETAIL B
SCALE 8:1

- △ ACCEPTS #4 SELF TAPPING THREAD CUTTING SCREWS OR METRIC EQUIVALENT. DRIVE TO 0.6 N-m MAX
- △ DATE CODE IN THIS LOCATION USING 5 DIGIT CODE
FIRST 2 DIGITS = YEAR, SECOND 2 DIGITS = WEEK
LAST DIGIT = DAY.
- △ MATERIALS: HEADER HOUSING - GLASS FILLED PBT
PINS - TIN OR GOLD PLATED BRASS
GASKET - SILICONE
- △ HOUSING COLORS ARE MECHANICALLY KEYS TO MATE ONLY WITH IDENTICALLY COLORED PLUG ASSEMBLIES.
- 5. HEADER MATES TO PLUG ASSEMBLY 770680 WHICH USES REELED TERMINAL 770520 OR LOOSE PIECE TERMINAL 770854

776228-1 & 1-776228-1 SHOWN

HEADER COLOR	PLATING	PART NUMBER
BLUE	DURAGOLD	1-776228-5
GRAY	DURAGOLD	1-776228-4
NATURAL	DURAGOLD	1-776228-2
BLACK	DURAGOLD	1-776228-1
BLUE	TIN	776228-5
GRAY	TIN	776228-4
NATURAL	TIN	776228-2
BLACK	TIN	776228-1

THIS DRAWING IS A CONTROLLED DOCUMENT. © STRASSER 2015

DATE: 108-1329
 PROJECT CODE: 116-18016
 PART: 776228

TE Connectivity
STE
 ASSEMBLY, HEADER, 23 POSITION, VERTICAL AMPSEAL WITH FLANGE SEAL

SIZE: A | CASE CODE: 776228 | PART NUMBER: 776228

CUSTOMER DRAWING | SHEET: 4-1 | OF: 2 | REV: C5

DATE REVISION TO IMPLEMENTED	REVISION FOR FABRICATION
BY	ALL RIGHTS RESERVED

REV	BY	DATE	DESCRIPTION	APP'D	CHK'D
00			SEE SHEET 1		

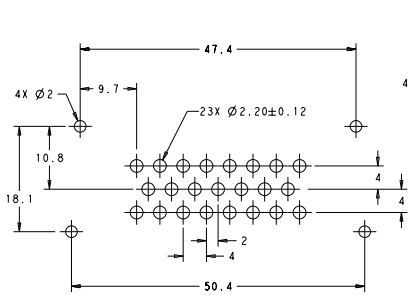

RECOMMENDED P.C. BOARD LAYOUT FOR 1.57 THICK P.C. BOARD

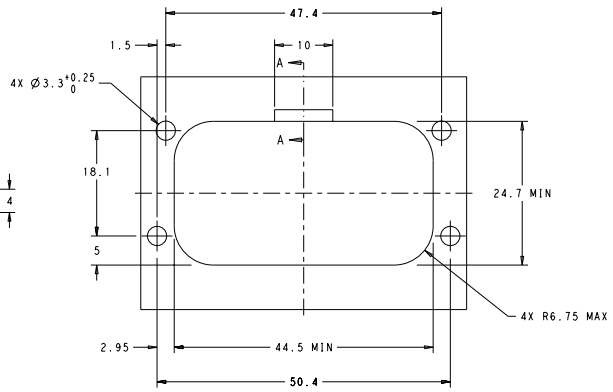

RECOMMENDED MOUNTING HOLE LAYOUT FOR 5.0 MAX THICK PANEL

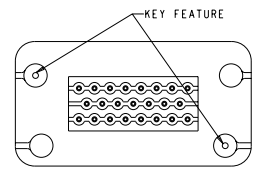

KEYING FOR 776228-1 AND 776228-5 SCALE 2:1

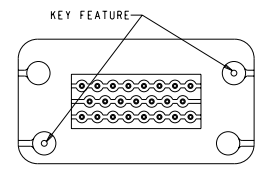

KEYING FOR 776228-2 AND 776228-4 SCALE 2:1

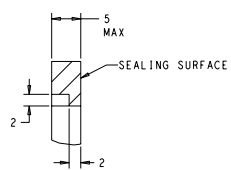

SECTION A-A
OPTIONAL CONSTRUCTION IF PANEL THICKNESS IS GREATER THAN 2.0

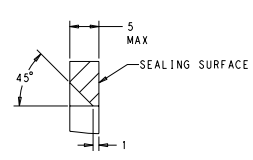

SECTION A-A
OPTIONAL CONSTRUCTION IF PANEL THICKNESS IS GREATER THAN 2.0

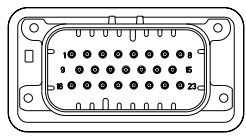

776228-2 & 1-776228-2
KEY LOCATION
SCALE 2:1

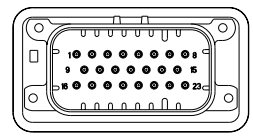

776228-4 & 1-776228-4
KEY LOCATION
SCALE 2:1

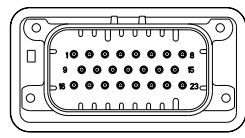

776228-5 & 1-776228-5
KEY LOCATION
SCALE 2:1

THIS DRAWING IS A CONTROLLED DOCUMENT.		REVISED BY: STRASSER	DATE: 03/20/15		TE Connectivity
REVISED BY: STRASSER	DATE: 03/20/15	REVISED BY: STRASSER	DATE: 03/20/15		
REVISED BY: STRASSER	DATE: 03/20/15	REVISED BY: STRASSER	DATE: 03/20/15	ASSEMBLY: HEADER	23 POSITION, VERTICAL
REVISED BY: STRASSER	DATE: 03/20/15	REVISED BY: STRASSER	DATE: 03/20/15	WITH FLANGE SEAL	
REVISED BY: STRASSER	DATE: 03/20/15	REVISED BY: STRASSER	DATE: 03/20/15	SCALE CODE: 2:1	776228
REVISED BY: STRASSER	DATE: 03/20/15	REVISED BY: STRASSER	DATE: 03/20/15	REVISED BY: STRASSER	DATE: 03/20/15
REVISED BY: STRASSER	DATE: 03/20/15	REVISED BY: STRASSER	DATE: 03/20/15	CUSTOMER DRAWING	SCALE: 2:1 SHEET 2 OF 2