

| REV | DATE | DESCRIPTION | BY | CHK | APP |
|-----|----------------------------|-------------|----|-----|-----|
| 00 | | | | | |
| 01 | 11-001732 | | | | |
| 02 | REVISSED PER ECR-11-000189 | | | | |

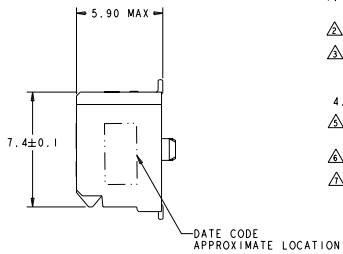

- PART COMPATIBLE KEMPAK & X2 MSA. REFER TO THESE MSA'S FOR DIMENSIONS NOT SHOWN ON THIS PRINT.
- HOUSING: HIGH TEMPERATURE LCP, UL 94V-0 RATED, BLACK.
- CONTACTS: 0.00038 MIN GOLD IN CONTACT AREA, 0.00013 MIN GOLD ON SOLDER AREA, OVER 0.0038 MIN NICKEL UNDERPLATE ON ENTIRE CONTACT.
- PACKAGED 480 PIECES PER REEL.
- GROUND, POWER AND SIGNAL PAD ARRANGEMENT TO BE DETERMINED BY CUSTOMER.
- DATUMS AND BASIC DIMENSIONS ESTABLISHED BY CUSTOMER.
- CONTACTS: 0.00076 MIN GOLD IN CONTACT AREA, 0.00013 MIN GOLD ON SOLDER AREA, OVER 0.0038 MIN NICKEL UNDERPLATE ON ENTIRE CONTACT.

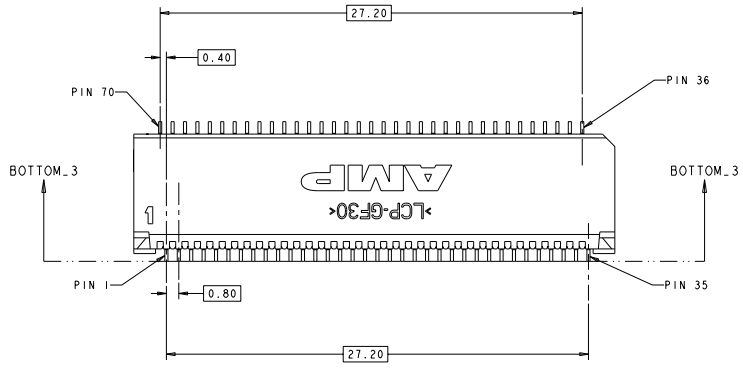
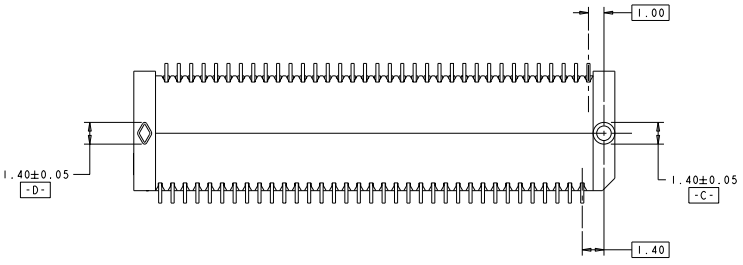
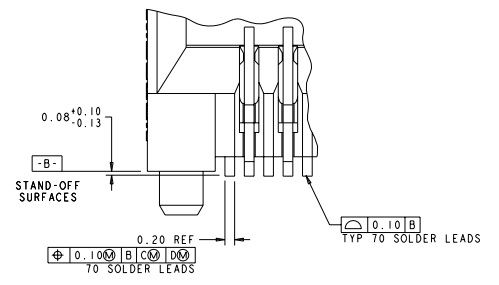
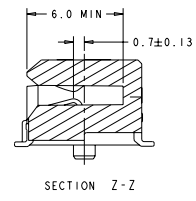
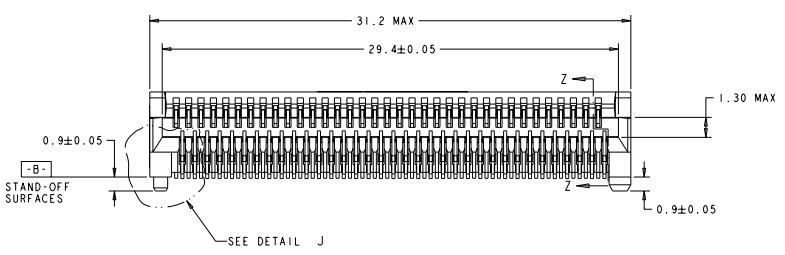
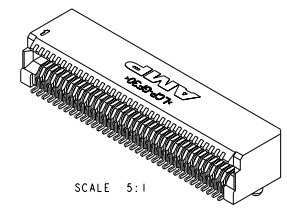

DETAIL J SCALE 25:1

| DATE CODE | FINISH | PART NUMBER |
|-----------|--------|-------------|
| YES | △ | 1367337-4 |
| YES | △ | 1367337-3 |
| NO | △ | 1367337-2 |
| NO | △ | 1367337-1 |

THIS DRAWING IS A CONTROLLED DOCUMENT. **STE** TE Connectivity

CONNECTOR ASSEMBLY, 70 POSITION, RTANG, 0.8MM

DATE CODE FINISH PART NUMBER

00779-1367337

