

REV	DATE	DESCRIPTION	BY	CHKD
AA	00			
R9	ECR-11-05509			

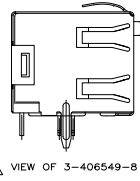

VIEW OF 3-406549-8

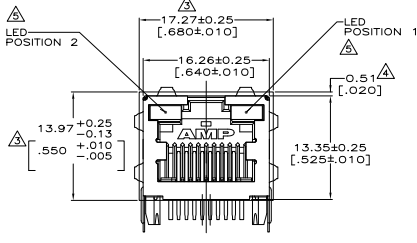
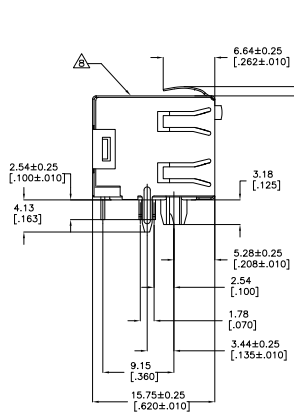
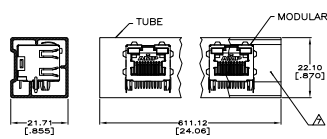

DETAIL A  
TUBE PACKAGE  
SCALE 2:1

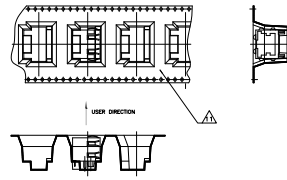

DETAIL B  
TAPE REEL PACKAGE  
SCALE 2:1

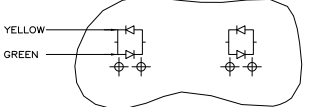

LED CURRENT DIAGRAM  
406549-8, 2-406549-8

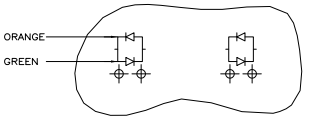

LED CURRENT DIAGRAM  
2-406549-7 ONLY

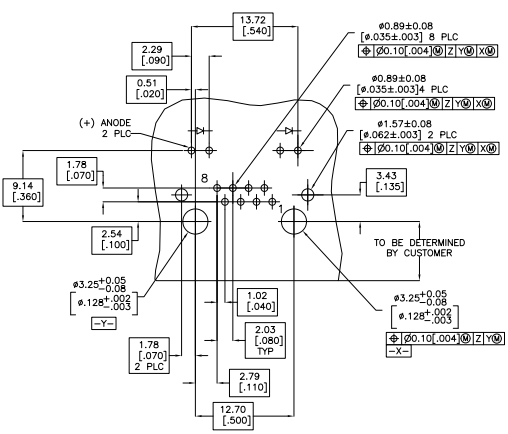

RECOMMENDED PRINTED CIRCUIT BOARD LAYOUT  
(COMPONENT SIDE)

- MATERIAL: HOUSING - HIGH TEMPERATURE THERMOPLASTIC, BLACK, UL94V-0. TERMINALS - 0.36[014] THICK PHOS BRONZE PLATED WITH 3.81µm[000150] MINIMUM THICK (SEE P/N TABLE) IN SOLDER AREA. 1.27µm [0.00050] MINIMUM GOLD IN LOCALIZED PLATE AREA. ENTIRE TERMINAL PLATED WITH 1.27µm [0.00050] MINIMUM THICK NICKEL. SHIELD - 0.19µm[0077] THICK COPPER ZINC ALLOY PREPLATED WITH 1.27µm[00050] MINIMUM SATIN NICKEL WITH 2.03µm[00080] MINIMUM TIN POST DIPPED ON PCB GROUND TABS. LIGHT EMITTING DIODE (LED) - DIFFUSED EPOXY LENS, 0.51 x 0.51[020 x 0.20] CARBON STEEL WIREFRAME LEADS PLATED WITH 8.89µm[00350] TIN/COPPER OVER 2.03[00080] SILVER OVER 1.02µm[00040] NICKEL UNDERPLATE OVER 1.02µm[00040] COPPER UNDERPLATE.
- JACK CAVITY CONFORMS TO FCC RULES AND REGULATIONS PART 68, SUBPART F.
- SUGGESTED PANEL OPENING DIMENSIONS.
- SUGGESTED CLEARANCE BETWEEN TOP OF CONNECTOR AND TOP PANEL OPENING.
- SEE TABLE FOR COLOR OF LEDS AND NUMBER REQUIRED.
- THIS MODULAR JACK WITH INTEGRATED LED IS NOT IR REFLOW SOLDERING PROCESS COMPATIBLE.
- PACKAGED 30 PIECES PER TUBE, SEE DETAIL "A".
- MANUFACTURING DATE CODE: LOCATED APPROX. AS SHOWN. FIRST 2 DIGITS = LAST 2 DIGITS OF YEAR. NEXT 2 DIGITS = MANUFACTURING WORK WEEK. LAST DIGIT = DAY OF WEEK WITH SUNDAY = 1.
- THE PART IS PRELIMINARY.
- OBsolete PARTS: OBSOLETE CIS STREAMLINING PER D.RENAUD/D.SINISI
- TAPE REEL PACKAGE, SEE DETAIL B.
- WITHOUT PLASTIC POST, SEE VIEW OF 3-406549-8.

PACKAGE	INDICATOR COLOR	POSITION 2	POSITION 1	PART NUMBER
MATTE TIN TAPE REEL	YELLOW/GREEN	YELLOW/GREEN	GREEN/RED	3-406549-8
MATTE TIN TAPE REEL	YELLOW/GREEN	YELLOW/GREEN	GREEN/RED	3-406549-3
MATTE TIN TAPE REEL	RED	GREEN	GREEN	3-406549-2
MATTE TIN TUBE	YELLOW	GREEN	GREEN	3-406549-1
MATTE TIN TAPE REEL	ORANGE/GREEN	GREEN	GREEN	3-406549-0
MATTE TIN TAPE REEL	ORANGE/GREEN	YELLOW	YELLOW	2-406549-9
MATTE TIN TAPE REEL	YELLOW/GREEN	YELLOW/GREEN	YELLOW/GREEN	2-406549-8
MATTE TIN TAPE REEL	ORANGE/GREEN	ORANGE/GREEN	ORANGE/GREEN	2-406549-7
MATTE TIN TAPE REEL	YELLOW	YELLOW	YELLOW	2-406549-6
MATTE TIN TAPE REEL	GREEN	GREEN	GREEN	2-406549-5
MATTE TIN TAPE REEL	YELLOW	YELLOW	YELLOW	2-406549-4
MATTE TIN TAPE REEL	YELLOW	YELLOW	YELLOW	2-406549-3
MATTE TIN TAPE REEL	YELLOW	GREEN	GREEN	2-406549-2
MATTE TIN TAPE REEL	YELLOW	GREEN	GREEN	2-406549-1
TIN-LEAD TAPE REEL	YELLOW/GREEN	YELLOW/GREEN	YELLOW/GREEN	406549-8
TIN-LEAD TAPE REEL	YELLOW	YELLOW	YELLOW	406549-6
TIN-LEAD TAPE REEL	GREEN	GREEN	GREEN	406549-5
TIN-LEAD TAPE REEL	GREEN	YELLOW	YELLOW	406549-4
TIN-LEAD TAPE REEL	YELLOW	YELLOW	YELLOW	406549-3
TIN-LEAD TAPE REEL	YELLOW	GREEN	GREEN	406549-2
TIN-LEAD TAPE REEL	YELLOW	GREEN	GREEN	406549-1

REV	DATE	DESCRIPTION	BY	CHKD
AA	00			
R9	ECR-11-05509			

REV	DATE	DESCRIPTION	BY	CHKD
AA	00			
R9	ECR-11-05509			

REV	DATE	DESCRIPTION	BY	CHKD
AA	00			
R9	ECR-11-05509			

REV	DATE	DESCRIPTION	BY	CHKD
AA	00			
R9	ECR-11-05509			

REV	DATE	DESCRIPTION	BY	CHKD
AA	00			
R9	ECR-11-05509			

REV	DATE	DESCRIPTION	BY	CHKD
AA	00			
R9	ECR-11-05509			